



Flat 4, 64 London Road North, Lowestoft, Suffolk, NR32 1ET

**** MODERN TWO BEDROOM APARTMENT **** Situated within the main town centre is this well presented apartment with neutral colours throughout, boasting an OPEN PLAN living area, master bedroom with ensuite and separate shower room!

- Ideal two bedroom apartment
- Well presented
- Neutral colours
- Close to local amenities
- Master with ensuite
- Separate family shower room
- Open plan living space
- Ideal town centre location
- Close to public transport links
- Separate entrance hall

£750

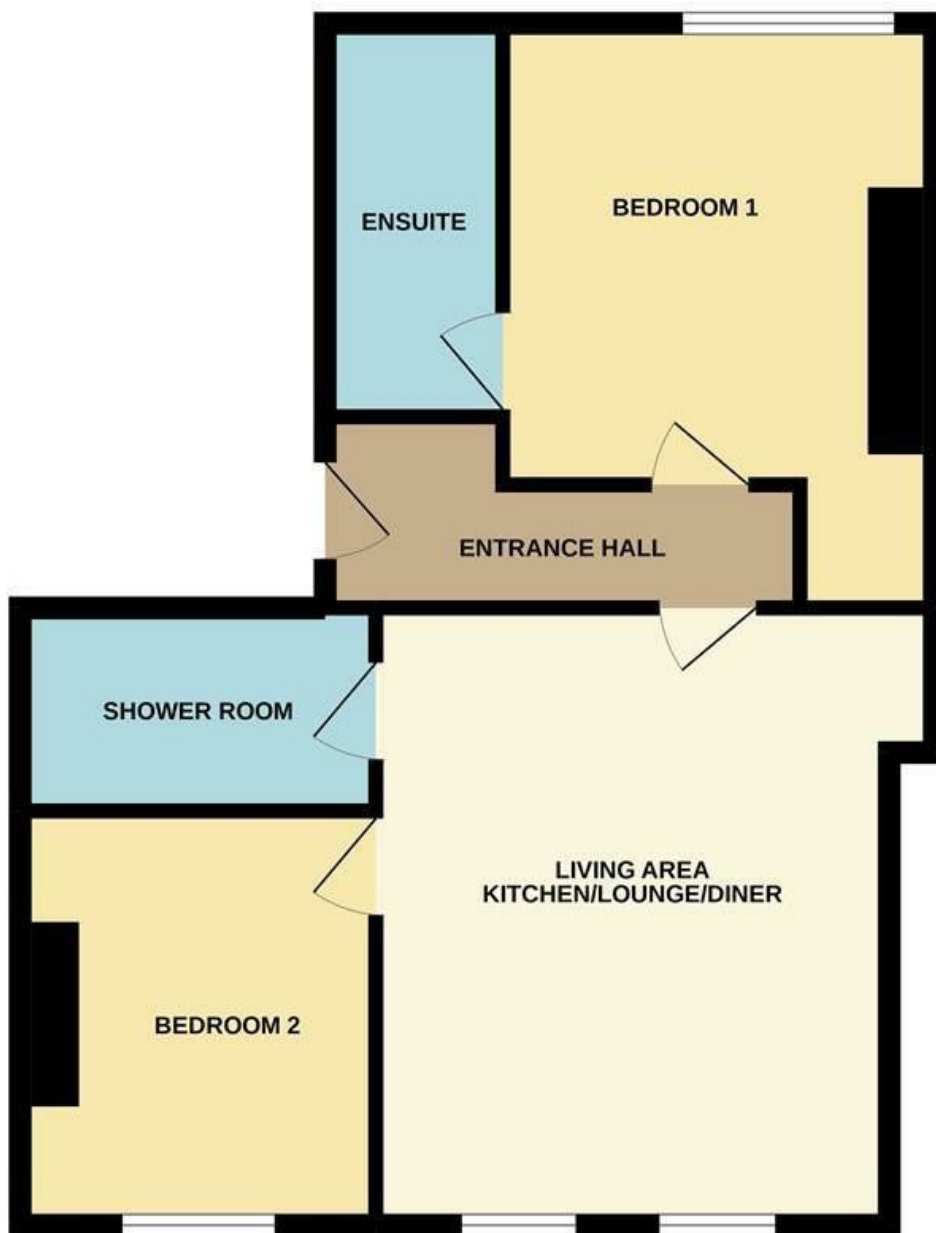

TOTAL FLOOR AREA : 585 sq.ft. (54.3 sq.m.) approx.

Whilst every attempt has been made to ensure the accuracy of the floorplan contained here, measurements of doors, windows, rooms and any other items are approximate and no responsibility is taken for any error, omission or mis-statement. This plan is for illustrative purposes only and should be used as such by any prospective purchaser. The services, systems and appliances shown have not been tested and no guarantee as to their operability or efficiency can be given.
Made with Metropix ©2022

Energy Efficiency Rating		
	Current	Potential
Very energy efficient - lower running costs		
(92 plus) A		
(81-91) B		
(69-80) C		
(55-68) D		
(39-54) E		
(21-38) F		
(1-20) G		
Not energy efficient - higher running costs		
England & Wales	EU Directive 2002/91/EC	