



Jordan fishwick

11 Milner Street, Old Trafford, M16 9WF
Guide Price £250,000



11 Milner Street, Old Trafford, Manchester, M16 9WF

Auction Guide £250,000



The Property

*****NO CHAIN***** This property is for sale by MODERN METHOD OF AUCTION powered by IAmSold LTD - Starting Bid £250,000 + Reservation Fee. Buyers Fees apply. Subject to reserve price. A delightful THREE DOUBLE BEDROOM MID TERRACED PERIOD PROPERTY located within a popular residential area just a stone's throw from Seymour Park and the primary school, all local amenities and transport links providing fast access to the City Centre. This splendid property will prove ideal for a young couple or family, offering spacious and light accommodation over two floors + cellars. The accommodation briefly comprises: covered porch, entrance hallway, lounge with large bay window, sitting room with feature Manchester window, kitchen/dining room. To the first floor are three bedrooms, all of excellent proportions and shower room, fitted with a modern three piece suite. Externally, to the front of the property is a walled garden with gated path to the front door. To the rear there is an excellent facing walled courtyard garden. An internal viewing is most highly recommended. Sold with no onward chain. Council Tax: B. EPC: D.

- MODERN METHOD OF AUCTION
- Well presented mid terrace period property
- Three good sized bedrooms and two reception rooms
- Short walk from all local amenities and transport links
- Close to Seymour Park and local schools
- Ideal for young couple or family
- Double glazing and gas central heating throughout
- Council Tax: B. EPC: D.
- NO CHAIN



Energy Efficiency Rating		
	Current	Potential
Very energy efficient - lower running costs		
(92 plus) A		
(81-91) B		83
(69-80) C		
(55-68) D	59	
(39-54) E		
(21-38) F		
(1-20) G		
Not energy efficient - higher running costs		
England & Wales	EU Directive 2002/91/EC 	



BASEMENT
222 sq.ft. (20.6 sq.m.) approx.

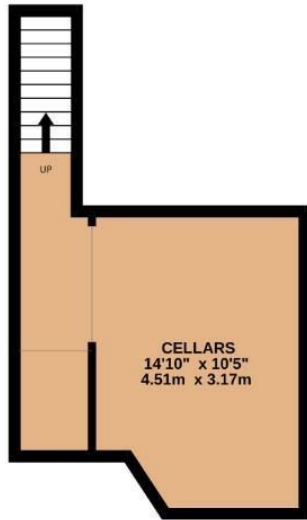

GROUND FLOOR
496 sq.ft. (46.1 sq.m.) approx.

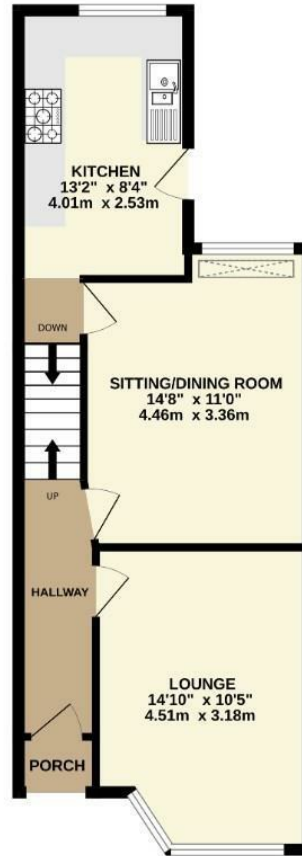

1ST FLOOR
462 sq.ft. (42.9 sq.m.) approx.



TOTAL FLOOR AREA : 1180 sq.ft. (109.6 sq.m.) approx.

Whilst every attempt has been made to ensure the accuracy of the floorplan contained here, measurements of doors, windows, rooms and any other items are approximate and no responsibility is taken for any error, omission or mis-statement. This plan is for illustrative purposes only and should be used as such by any prospective purchaser. The services, systems and appliances shown have not been tested and no guarantee as to their operability or efficiency can be given.
Made with Metropix ©2025



These particulars are believed to be accurate but they are not guaranteed and do not form a contract. Neither Jordan Fishwick nor the vendor or lessor accept any responsibility in respect of these particulars, which are not intended to be statements or representations of fact and any intending purchaser or lessee must satisfy himself by inspection or otherwise as to the correctness of each of the statements contained in these particulars. Any floorplans on this brochure are for illustrative purposes only and are not necessarily to scale.

Offices at: Chorlton, Didsbury, Disley, Hale, Glossop, Macclesfield, Manchester Deansgate, Manchester Whitworth Street, New Mills, Sale, Wilmslow and Withington