



HW

ESTATE AGENTS

Flat 14, Hereford Court, 61 The Drive
£400,000



Flat 14

Hereford Court, Hove

Spacious three-bedroom apartment on The Drive with a private west facing balcony, far-reaching views, modern kitchen, communal grounds, and easy access to local amenities, transport, and the seafront.

Council Tax band: C

Tenure: Leasehold

EPC Energy Efficiency Rating: C

EPC Environmental Impact Rating: C

- Private West Facing Balcony
- Modern kitchen with integrated appliances
- Spacious living area
- Modern bathroom
- Ample natural light throughout
- Built-in storage in bedrooms
- Central location
- Contemporary decor
- Additional Storage In Hallway
- Separate WC

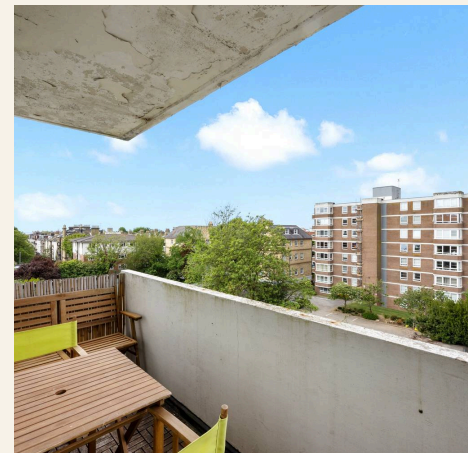



The Drive

Approx. Gross Internal Area :- 74.0 sq.m. 796.0 sq.ft.

HW

HAWKINS WATTS WINNARD

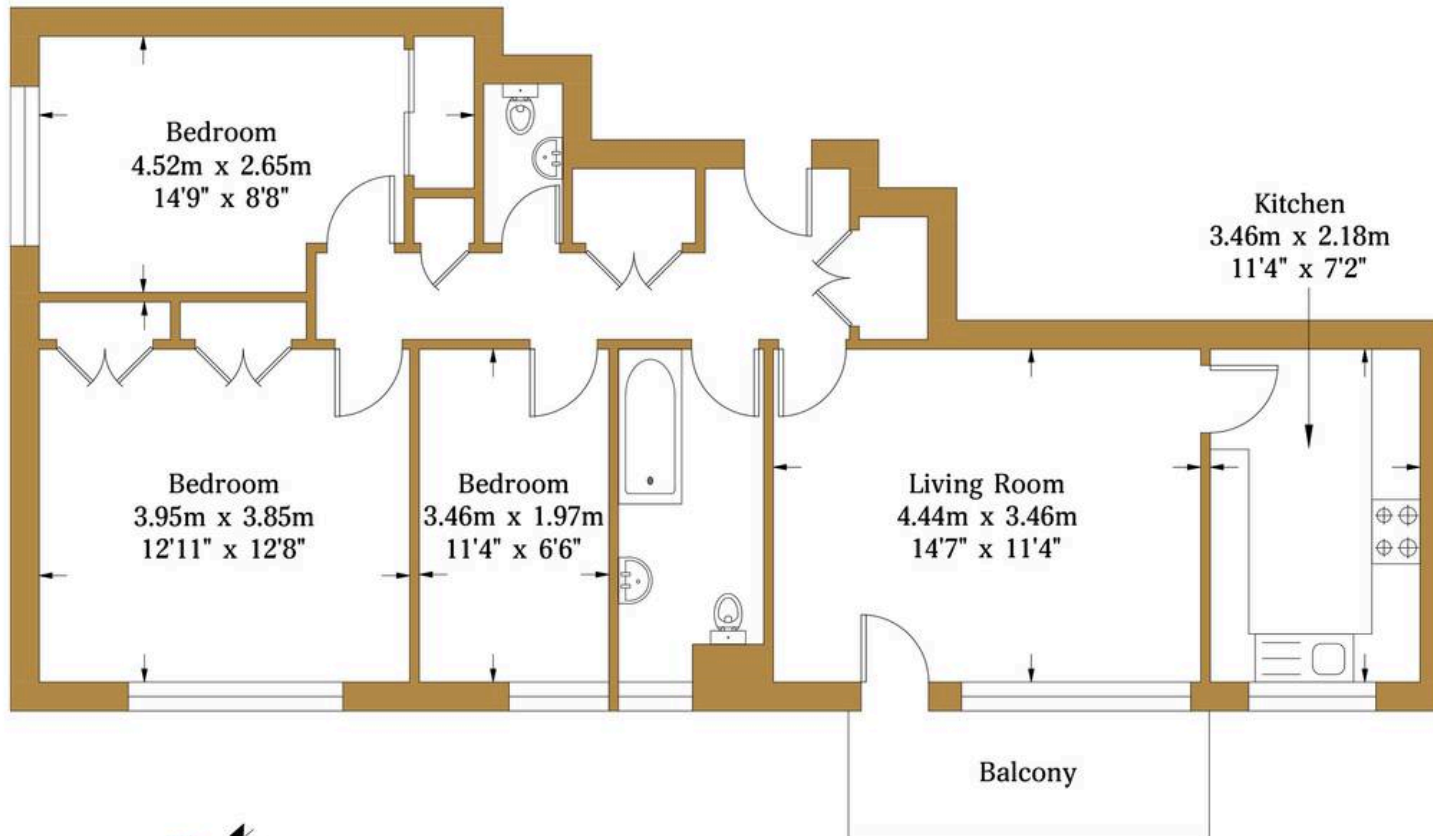

Third Floor
Approximate Floor Area
796.0 sq ft
(74.0 sq m)

Illustration for identification purposes only, measurements are approximate, not to scale.

© hwstateagents



HW Estate Agents

HW Estate Agents, 80 Goldstone Villas, Hove - BN3 3RU

01273 359000 · hove@hwestateagents.co.uk · www.hwestateagents.co.uk

HW

ESTATE AGENTS