



STANHOPE TERRACE, W2

£808 per week (£3,500 per month)

A beautiful one-bedroom flat with access to immaculate communal gardens on a prime street moments to Hyde Park.

One bedroom
High ceilings
Modern

Wooden flooring
Porter
Communal gardens

STEP INSIDE STANHOPE TERRACE

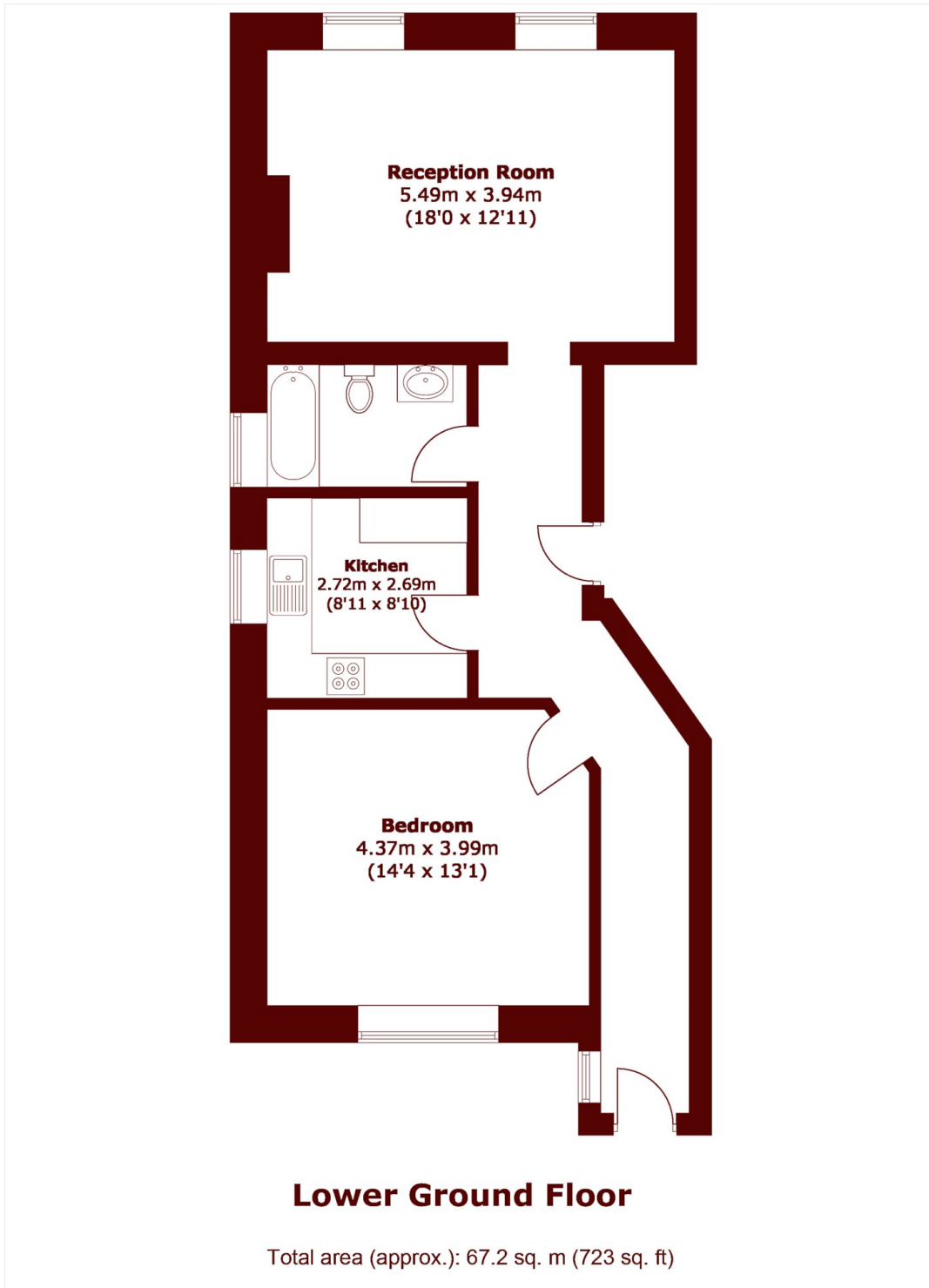

Notting Hill
020 7313 6910

Energy Rating: D We aim to make our particulars both accurate and reliable. However, they are not guaranteed; nor do they form part of an offer or contract. If you require clarification on any points then please contact us, especially if you're traveling some distance to view. Please note that appliances and heating systems have not been tested and therefore no warranties can be given as to their good working order

MARSH &
PARSONS