



## Millbrook, Southwell Road, Kirklington, NG22 8NF

**GUIDE PRICE**  
**£640,000**

**NO ONWARD CHAIN** - Situated on a large plot (0.5 acres STS) and set back from the road in an elevated position with open field views to the rear, this spacious and well appointed detached bungalow offers flexible living with accommodation including entrance hall, large lounge, dining room, garden room, dining kitchen, utility room, conservatory, master bedroom with dressing room off, two further double bedrooms, bathroom and shower room. Outside there is a large tarmac driveway which offers ample parking and gives access to a large garage, there is also a lawned garden to front, a rear delightful lawned garden with private Westerly facing patio, flower/shrub beds and borders and mature trees. We highly recommend an early viewing to appreciate the size and position of this spacious bungalow.



Millbrook, Southwell Road, Kirklington, Newark, NG22 8NF



#### **SERVICES**

Mains electricity, water and drainage.

Oil fired central heating.

**EPC RATING – D.**

**COUNCIL TAX BAND – G.**

**LOCAL AUTHORITY** - Newark and Sherwood District Council.

**TENURE** - Freehold.

#### **VIEWINGS**

By prior appointment through Alasdair Morrison and Mundys.





## ACCOMMODATION

A composite front entrance door with glazed panel inset leads to the entrance porch.

## ENTRANCE PORCH

5' 7" x 3' 11" (1.7m x 1.19m) With uPVC double glazed obscured windows to front elevation and single glazed obscured door with side window to entrance hall.

## ENTRANCE HALL

5' 9" x 12' 11" (1.75m x 3.94m) With engineered oak floor, two radiators, doors off to the shower room, lounge, dining kitchen, three bedrooms and bathroom and further door leading to the staircase access to the garage.

## LOUNGE

17' 9" x 23' 7" (5.41m x 7.19m) With large uPVC window to front elevation offering open views, uPVC double glazed window to side elevation, coving to ceiling, three radiators, feature fireplace with stone effect surround, log burner, wall lights and glazed double doors leading to the dining room.

## DINING ROOM

12' 10" x 14' 3" (3.91m x 4.34m) With coving to ceiling, radiator, uPVC double glazed window to side elevation, aluminium framed sliding double glazed doors to the garden room and serving hatch to the kitchen.

## GARDEN ROOM

20' 7" x 9' 8" (6.27m x 2.95m) With terracotta tiled floor, radiator, double glazed sliding patio doors to the rear garden and glazed door to the side elevation.

## DINING KITCHEN

16' 2" x 13' 9" (4.93m x 4.19m) Fitted with a range of wall, base units and drawers with work surfaces over and tiled splash-backs, inset 1.5 bowl stainless steel single drainer sink unit with mixer tap, space for a recessed Range cooker with extractor hood over, integral Hotpoint dishwasher, integral fridge, uPVC double glazed window overlooking the rear of the property, tiled floor, radiator, down-lights to ceiling, recessed cylinder cupboard and door leading to the utility room.

## UTILITY ROOM

7' 8" x 14' 2" (2.34m x 4.32m) Fitted with a range of base units with work surface over, inset stainless steel single drainer sink unit with hot and cold taps, plumbing and space for a washing machine, further appliance space, radiator, uPVC double glazed door to the conservatory and space for a fridge freezer.





### CONSERVATORY

42' 2" x 9' 7" (12.85m x 2.92m) With two radiators, half glazed door to the rear garden, fitted storage cupboard and sliding double glazed aluminium frames windows over looking the rear garden.

### MASTER BEDROOM

13' 5" x 12' 9" (4.09m x 3.89m) With large uPVC double glazed window to front elevation, radiator and door leading to the dressing room.

### DRESSING ROOM

12' 11" x 9' 8" (3.94m x 2.95m) Previously used as a bedroom four, now offering an extensive range of fitted wardrobes, radiator and uPVC double glazed window to front elevation (please note that this room could be accessed from the entrance hall, subject to the necessary changes).



### BEDROOM TWO

10' 6" x 13' 9" (3.2m x 4.19m) With radiator, uPVC double glazed window to the rear elevation and a range of fitted wardrobes with hanging rails and shelving.

### BEDROOM THREE

11' 1" x 10' 7" (3.38m x 3.23m) With uPVC double glazed window to rear elevation and radiator.



### BATHROOM

7' 5" x 9' 5" (2.26m x 2.87m) With suite to comprise of dual end bath with mixer tap, shower tap and tiled surround, eco-flush WC, pedestal wash hand basin with mixer tap and shower enclosure with glazed door, drench head shower and additional hand held shower attachment, heated towel rail, tiled flooring, half tiled surround, extractor fan and two uPVC double glazed obscured windows to side elevation.

### SHOWER ROOM

5' 6" x 12' 10" (1.68m x 3.91m) With suite to comprise of pedestal wash hand basin, eco-flush WC and shower cubicle with glazed door, fixed head shower, additional hand held shower attachment and side lower jets, down-lights to ceiling, tiled flooring, half tiled surround, radiator, uPVC double glazed obscured window to front elevation and recessed cupboard with coat hooks.



### OUTSIDE

The front of the property is accessed via a tarmacadam driveway which divides offering additional parking for numerous vehicles and also leads to the garage. The front garden is principally laid to lawn and has attractive flower/shrub borders and beds, with a pathway and steps leading up to the front of the property.



There is the added benefit of external lighting to the front, including wall lights and coach light. There is side gated access to the rear garden.

The wonderful rear garden offers open field views with an extensive lawned garden, flower/shrub beds and borders, timber summer house, garden shed, greenhouse and water feature.

The westerly rear aspect is ideal for a large paved patio area which is completely private and offers wonderful views over the rear garden and rear fields.

## GARAGE

17' 9" x 38' 0" (5.41m x 11.58m) With an electric up and over door, light, power, glazed panelled window to the side elevation, tap, oil fired central heating boiler, oil storage tank and stairs leading up to the door giving access to the entrance hall.

### WEBSITE

Our detailed website shows all our available properties and also gives extensive information on all aspects of moving home, local area information and helpful information for buyers and sellers. This can be found at [mundys.net](http://mundys.net)

### SELLING YOUR HOME – HOW TO GO ABOUT IT

We are happy to offer FREE advice on all aspects of moving home, including a Valuation by one of our QUALIFIED/SPECIALIST VALUERS. Ring or call into one of our offices or visit our website for more details.

### REFERRAL FEE INFORMATION – WHO WE MAY REFER YOU TO

Sills & Betteridge, Ringrose Law LLP, Burton and Co, Bridge McFarland, Dale & Co, Bird & Co and Gilson Gray who will be able to provide information to you on the conveyancing services they can offer. Should you decide to use these Conveyancing Services then we will receive a referral fee of up to £150 per sale and £150 per purchase from them.

CWH, J Walter and Callum Lyman will be able to provide information and services they offer relating to Surveys. Should you decide to instruct then we will receive a referral fee of up to £125.

Claverings will be able to provide information and services they offer relating to removals. Should you decide to instruct then we will receive a referral fee of up to £125.

Mundys Financial Services who will be able to offer a range of financial service products. Should you decide to instruct Mundys Financial Services we will receive a commission from them of £250 and in addition, the individual member of staff who generated the lead will receive £50.

### BUYING YOUR HOME

An Independent Survey gives peace of mind and could save you a great deal of money. For details, including RICS Home Buyer Reports, call 01522 556088 and ask for Steven Spivey MRICS.

### GETTING A MORTGAGE

We would be happy to put you in touch with our Financial Adviser who can help you to work out the cost of financing your purchase.

### NOTE

1. None of the services or equipment have been checked or tested.
2. All measurements are believed to be accurate but are given as a general guide and should be thoroughly checked.

### GENERAL

If you have any queries with regard to a purchase, please ask and we will be happy to assist. Mundys makes every effort to ensure these details are accurate, however they are for themselves and the vendors (Lessors) for whom they act as Agents give notice that:

1. The details are a general outline for guidance only and do not constitute any part of an offer or contract. No person in the employment of Mundys has any authority to make or give representation or warranty whatever in relation to this property.
2. All descriptions, dimensions, references to condition and necessary permissions for use and occupation and other details should be verified by your self on inspection, your own advisor or conveyancer, particularly on items stated herein as not verified.

Regulated by RICS. Mundys is the trading name of Mundys Property Services LLP registered in England NO. OC353705. The Partners are not Partners for the purposes of the Partnership Act 1890. Registered Office 29 Siver Street, Lincoln, LN2 1AS.



Approx Gross Internal Area  
310 sq m / 3332 sq ft

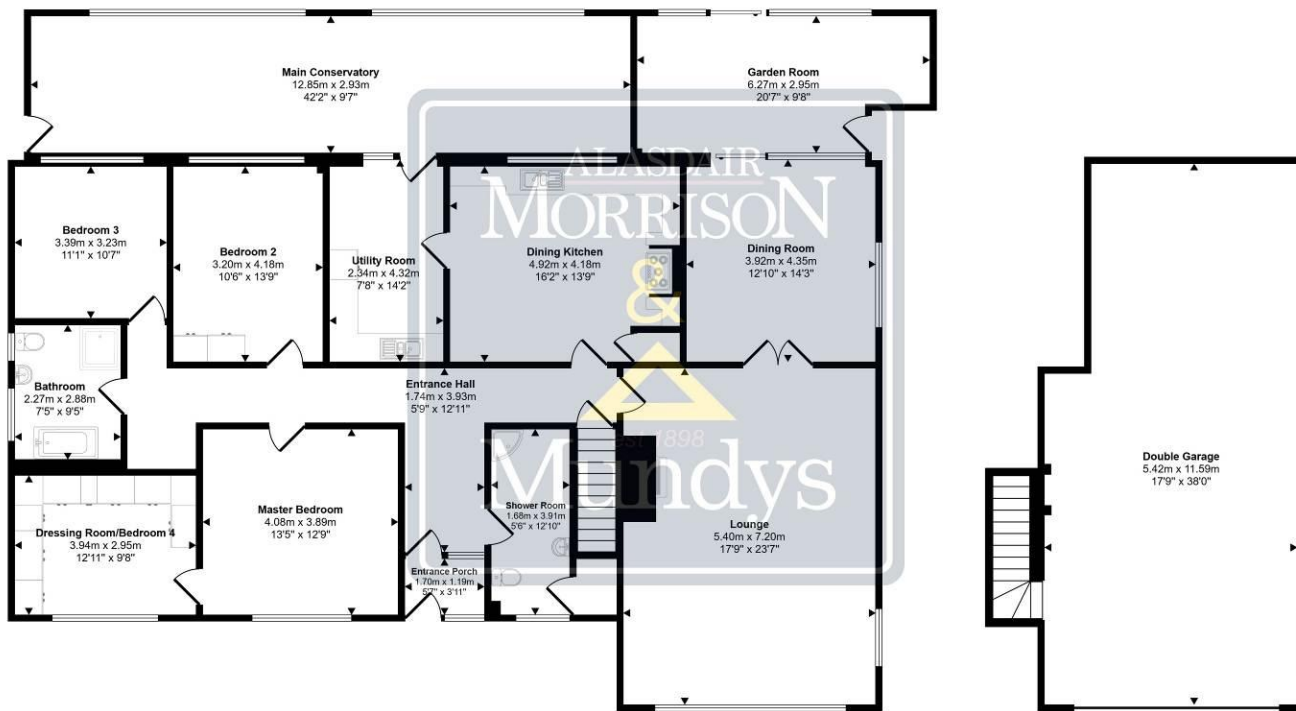

Ground Floor  
Approx 248 sq m / 2667 sq ft

Lower Ground Floor  
Approx 62 sq m / 665 sq ft

This floorplan is only for illustrative purposes and is not to scale. Measurements of rooms, doors, windows, and any items are approximate and no responsibility is taken for any error, omission or mis-statement. Icons of items such as bathroom suites are representations only and may not look like the real items. Made with Made Snappy 360.



46 Middle Gate  
Newark  
NG24 1AL

newark@amorrison-mundys.net  
01636 700888

22 King Street  
Southwell  
NG25 0EN

southwell@amorrison-mundys.net  
01636 813971

29 Silver Street  
Lincoln  
LN2 1AS

info@mundys.net  
01522 510044

22 Queen Street  
Market Rasen  
LN8 3EH

info@mundys.net  
01673 847487

Agents Note: Whilst every care has been taken to prepare these sales particulars, they are for guidance purposes only. All measurements are approximate and are for general guidance purposes only and whilst every care has been taken to ensure their accuracy, they should not be relied upon and potential buyers are advised to recheck the measurements.