



Abercairn Road, SW16
£650,000

Dexters



Abercairn Road, SW16

OFFERS OVER A beautifully presented three bedroom family home, maintained in excellent condition throughout and offered with no onward chain. The property features a spacious separate reception room, along with a stylish dining room complemented by a modern kitchen. The garden is low-maintenance and includes a practical shed for additional storage.

Abercairn Road is ideally situated within easy reach of Streatham Common mainline station, as well as the vibrant Streatham High Road, which offers a wide range of leisure facilities, restaurants, and shopping options. Streatham Common station provides convenient rail links to both London Victoria and London Bridge, making it an excellent location for commuters.

Features

- Three Bedrooms
- Separate Kitchen
- Large Garden
- Modern Kitchen
- Two Reception Rooms
- No Onward Chain



Abercairn Road,
London, SW16

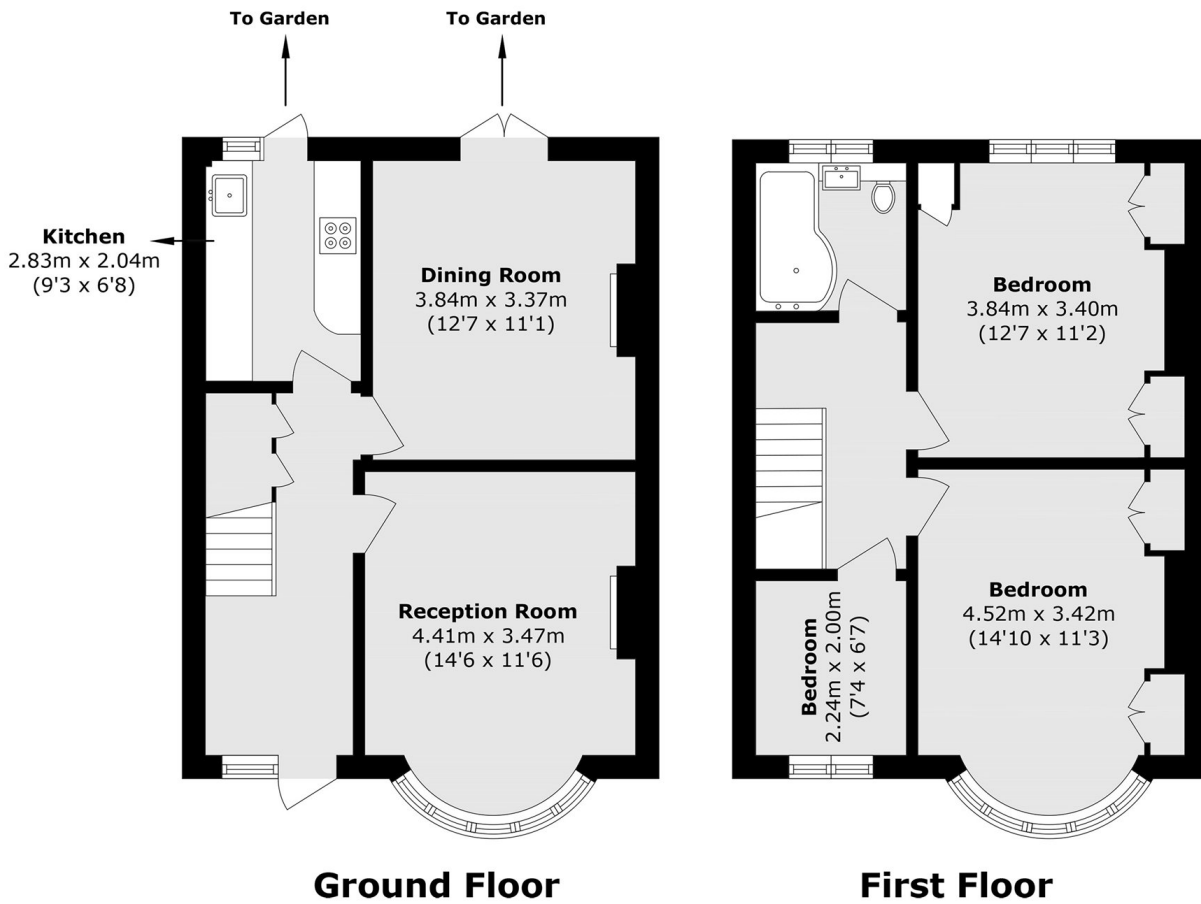

Total area (approx.): 86.7 sq. m (933.2 sq. ft)