



KMJProperty
Your local independent Estate Agent

The Old Bakery, Ashley Gardens, Tunbridge Wells

Offers In Region Of £210,000

1 1 1



Perfect for Buy to Let Investors, this property is situated in the very heart of Rusthall, a unique and character-filled one-bedroom house effortlessly blends rustic charm with stylish modern interiors – offering the perfect balance of comfort, convenience, and contemporary living.

A few steps lead you to a private, west-facing courtyard garden – a sunny and peaceful retreat ideal for relaxing with a morning coffee or entertaining in the warmer months.

Step through the distinctive front door and into a bright, dual-aspect open-plan living, dining, and kitchen space. The kitchen itself is a real highlight, featuring sleek cabinetry, an integrated electric hob, and plenty of above-counter storage. The open-plan layout creates an inviting and versatile space – perfect for cosy evenings in or hosting friends.

To the left of the main living area, a well-appointed downstairs shower room includes a cubicle shower, WC, and contemporary tiling that adds a stylish, modern touch.

Upstairs, the generous double bedroom boasts beautiful high arched ceilings, enhancing the sense of space and character. Ample room for storage ensures both practicality and comfort, while natural light fills the room, creating a calm and serene atmosphere.

Fully refurbished and thoughtfully extended in 2015, this delightful home is ideal for first-time buyers, downsizers, or buy-to-let investors looking to secure a freehold property in a sought-after village setting.

Could achieve approximately £1100 pcm

Offered with no onward chain.

This property sits within the curtilage of listed buildings - Please ask our team for further information



Approx Gross Internal Area
43 sq m / 458 sq ft

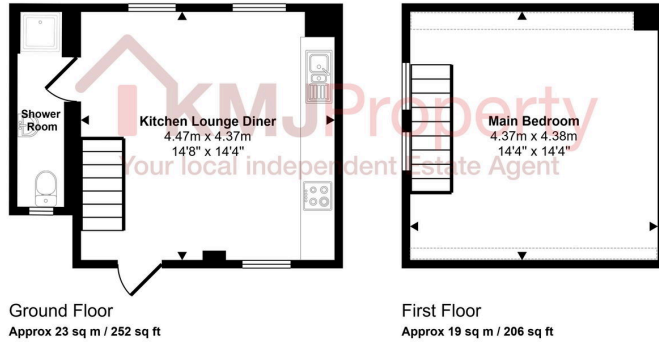

- NO CHAIN
- Private Courtyard
- Modern Kitchen
- Open Plan Living
- EPC: E
- 1 Bedroom
- Downstairs Bathroom
- Desirable Location
- Bright and Airy Feel
- Council Tax Band: C

