



174 Littleworth Lane, Whitley

£650,000

3 1 0

- Stunning village home in the heart of sought after Whitley
- Sunny living room with Stone fireplace and inset gas log burner fire
- Additional generous study/ snug
- Downstairs cloakroom and large upstairs shower room
- DOUBLE stone built garage with covered area linking the cottage.
- c. 0.25 acre of gardens including a superb outdoor summerhouse
- Beamed, characterful dining room
- Kitchen/dining room with large utility
- 3 double bedrooms with views across farmland
- Excellent local amenities and bus routes on your doorstep



A quintessential village cottage which has been maintained in excellent condition, whilst retaining all the period charm you would expect. This home has a really warm and loved feel, and enjoys superb gardens of c.0.25 acres. Allotment areas, children's dens and beautiful flower borders... you can have it all here! An excellent location right in the heart of the village, yet offering excellent privacy and easy access to the local shop, superb Pear Tree Inn and other amenities.



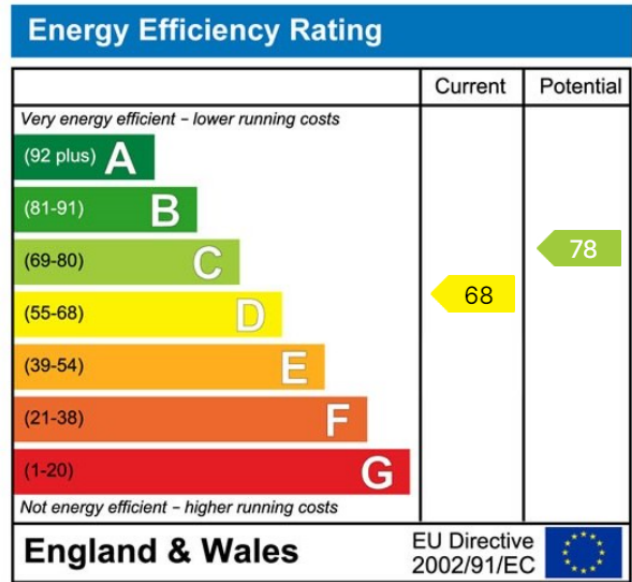
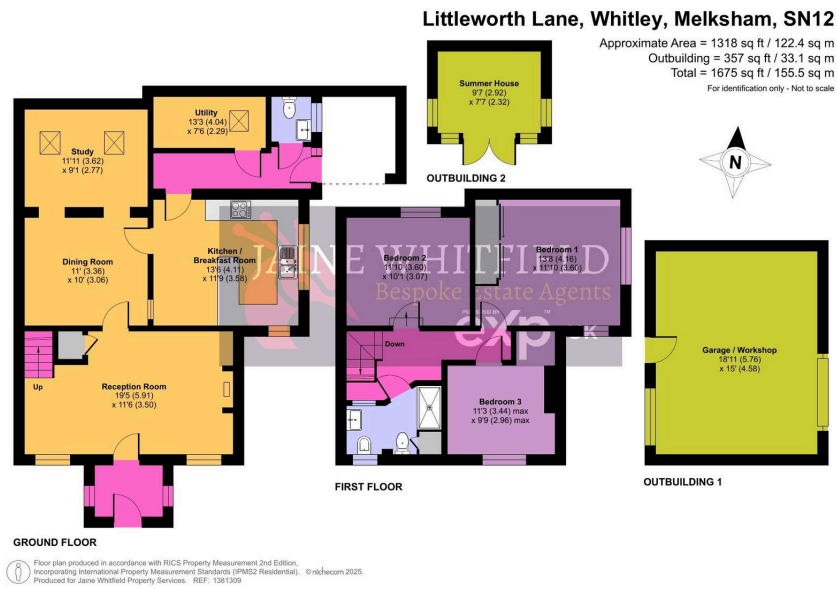

01225 705650

hello@jainewhitfield.co.uk

www.jainewhitfield.co.uk

