



Moorhouse Road  
Notting Hill, W2

CHESTERTONS





This superb one bedroom flat offers bright, well proportioned rooms with impressive ceiling heights of over three meters, ideally situated moments from the fashionable boutiques, cafés, and restaurants of Ledbury Road and Westbourne Grove.

Beautifully presented, the property features wooden flooring in the spacious reception room, which benefits from a large west facing window allowing for excellent natural light. To the rear, there is a separate modern kitchen with pleasant outlooks over the back of the building, alongside a contemporary bathroom and a generously sized double bedroom.

The flat also benefits from excellent built in storage, as well as access to additional non-demised storage within the common parts.

Moorhouse Road is a quiet, tree lined street in the heart of Notting Hill, conveniently located for the outstanding amenities of Westbourne Grove and Ledbury Road. Transport links are excellent, with both Notting Hill Gate (Central, Circle & District lines) and Westbourne Park (Hammersmith & City and Circle lines) stations within easy reach.

- Spacious one bedroom flat in prime Notting Hill location
- Bright west facing reception room with 3 meter high ceilings
- Modern kitchen and contemporary bathroom
- Wooden flooring and excellent built-in storage
- Moments from Westbourne Grove, Ledbury Road and transport links

Asking Price £705,000

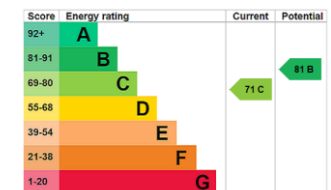

**Tenure:** Leasehold 148 years 8 months  
**Service Charge:** £3737  
**Ground Rent:** £0  
**Local Authority:** Westminster  
**Council Tax Band:** D

*Chestertons Notting Hill Sales*

30 Ledbury Road  
 Notting Hill  
 London  
 W11 2AB

nottinghill@chestertons.co.uk  
 0203 040 8585

○ - Ceiling Height

## Moorhouse Road, W2

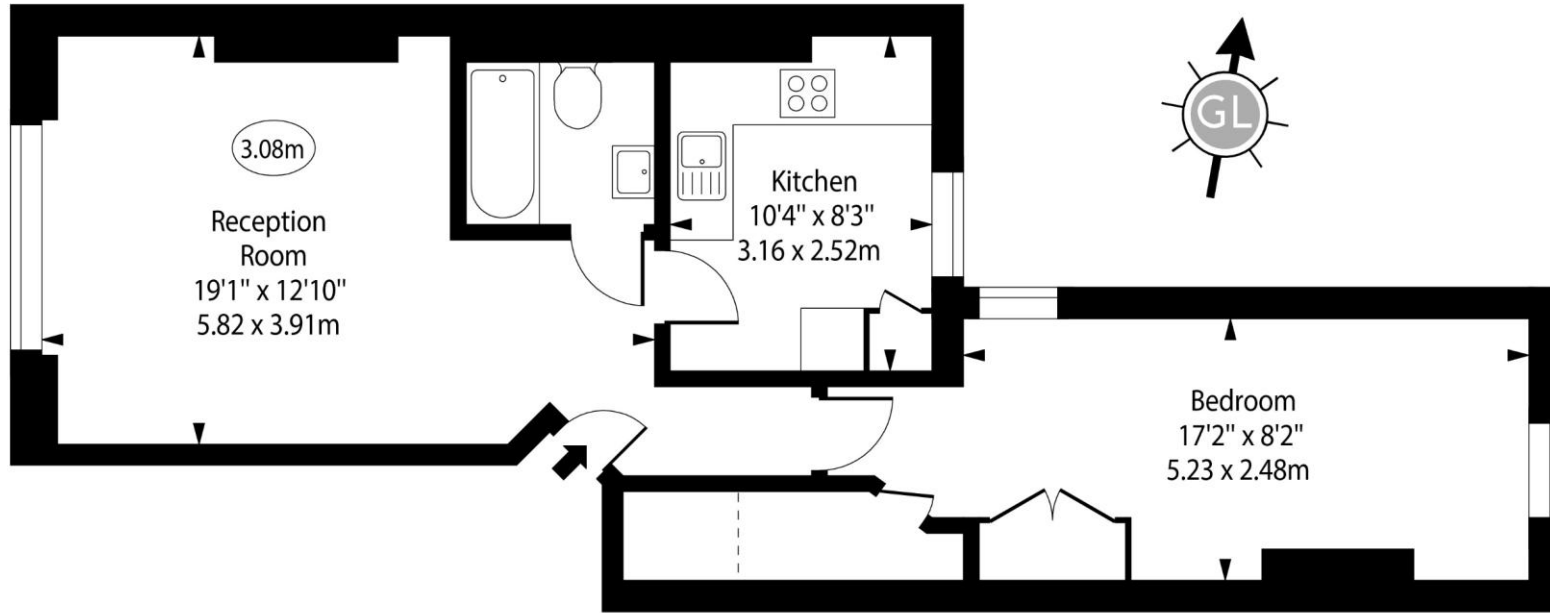

Raised Ground Floor

Approx Gross Internal Area      542 Sq Ft - 50.35 Sq M

Every attempt has been made to ensure the accuracy of the floor plan shown.  
However, all measurements, fixtures, fittings, and data shown are approximate interpretations and  
for illustrative purposes only. Measured according to the RICS. Not To Scale.

[www.goldlens.co.uk](http://www.goldlens.co.uk)

Ref. No. 031631D

