



## LOTUS MEWS, N19

£800,000

Three bedroom  
Kitchen  
Separate living room  
Courtyard garden  
No onward chain  
Two bathrooms

@marshandparsons  
marshandparsons.co.uk

MARSH &  
PARSONS



# ABOUT THE PROPERTY

A modern terraced mews house situated within a small gated development. The property offers three bedrooms, two bathrooms, and a kitchen with breakfast area, as well as a private courtyard garden. It further benefits from being sold with no onward chain.

Lotus Mews is situated just off Sussex Way, within walking distance of the amenities found along Holloway Road, including a range of shops, cafés, and excellent public transport links.



# STEP INSIDE LOTUS MEWS

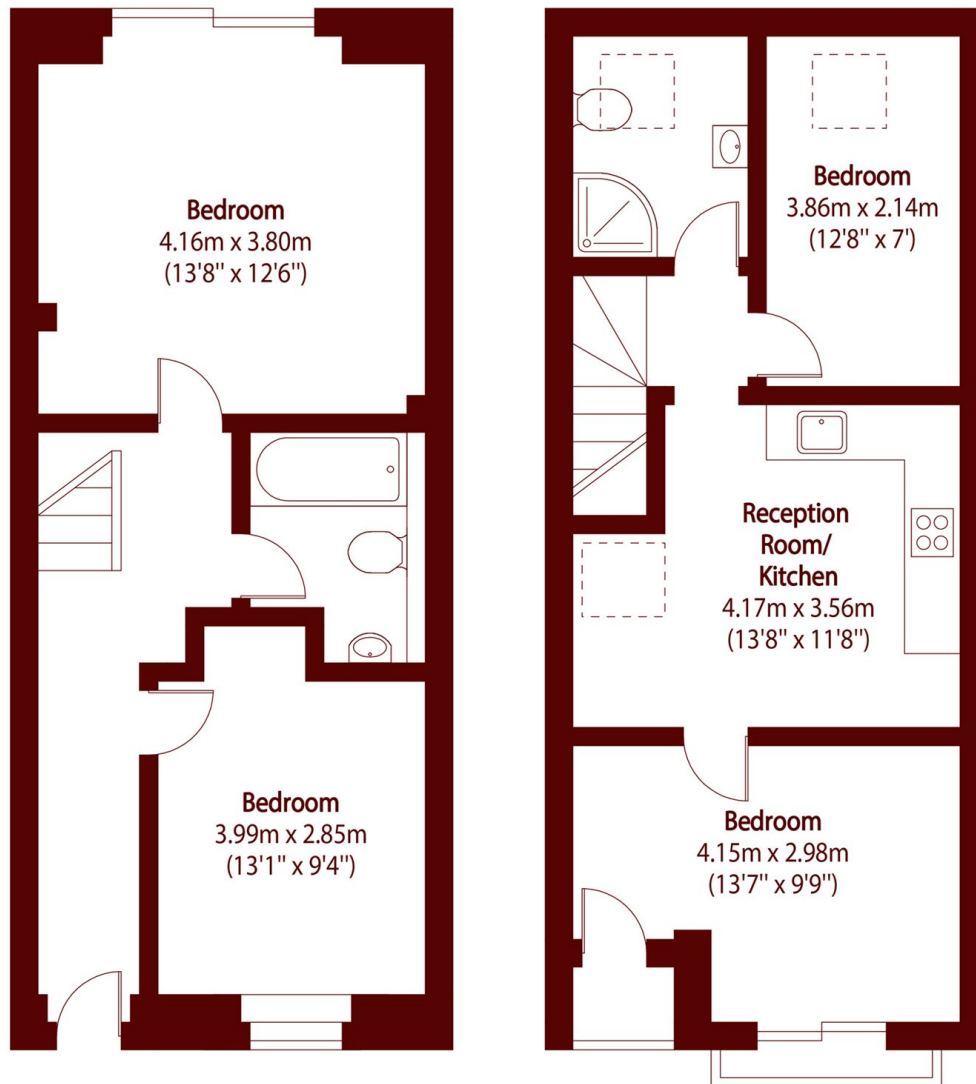

## Ground Floor

## First Floor

Total area (approx): 87.06 sq m (937 sq. ft)

Camden  
020 7244 2200

Energy Rating: B We aim to make our particulars both accurate and reliable. However, they are not guaranteed; nor do they form part of an offer or contract. If you require clarification on any points then please contact us, especially if you're traveling some distance to view. Please note that appliances and heating systems have not been tested and therefore no warranties can be given as to their good working order

MARSH &  
PARSONS