



57 Wolvey Road, Bulkington

Bedworth

£295,000



**SHELDON  
BOSLEY  
KNIGHT**

LAND AND  
PROPERTY  
PROFESSIONALS

# 57 Wolvey Road

Bulkington, Bedworth

This impressive three bedroom end of terrace house offers spacious and versatile accommodation, thoughtfully extended and beautifully presented throughout. Upon entering, you are welcomed into a bright hallway that leads to two inviting lounges, providing flexible living spaces ideal for both relaxation and entertaining. The property boasts a generous dining room extension. The extended kitchen is well appointed with ample storage and workspace with incorporated hob and oven. Complemented by a breakfast room and practical utility area which has a convenient ground floor W.C. Upstairs, there are three bedrooms, each offering comfortable accommodation with plenty of natural light. The extended bathroom has a champagne coloured suite and shower cubicle. The home benefits from gas fired central heating and double glazing. The paved frontage enhances the property's kerb appeal and offers low maintenance. The rear garden is planted with a variety of shrubs and has a paved patio area. This is a opportunity to acquire a well maintained and thoughtfully extended home that combines traditional charm with modern convenience. Located in a popular residential area with access to local amenities, reputable schools, and excellent transport links, this property is ideally suited to families and professionals alike. Early viewing is highly recommended to fully appreciate the quality and space this delightful home has to offer. Council Tax band: B

Tenure: Freehold

- Well Presented & Extended Semi Detached
- Two Lounges & Dining Room Extension





## Ground Floor

Approx. 56.9 sq. metres (612.2 sq. feet)

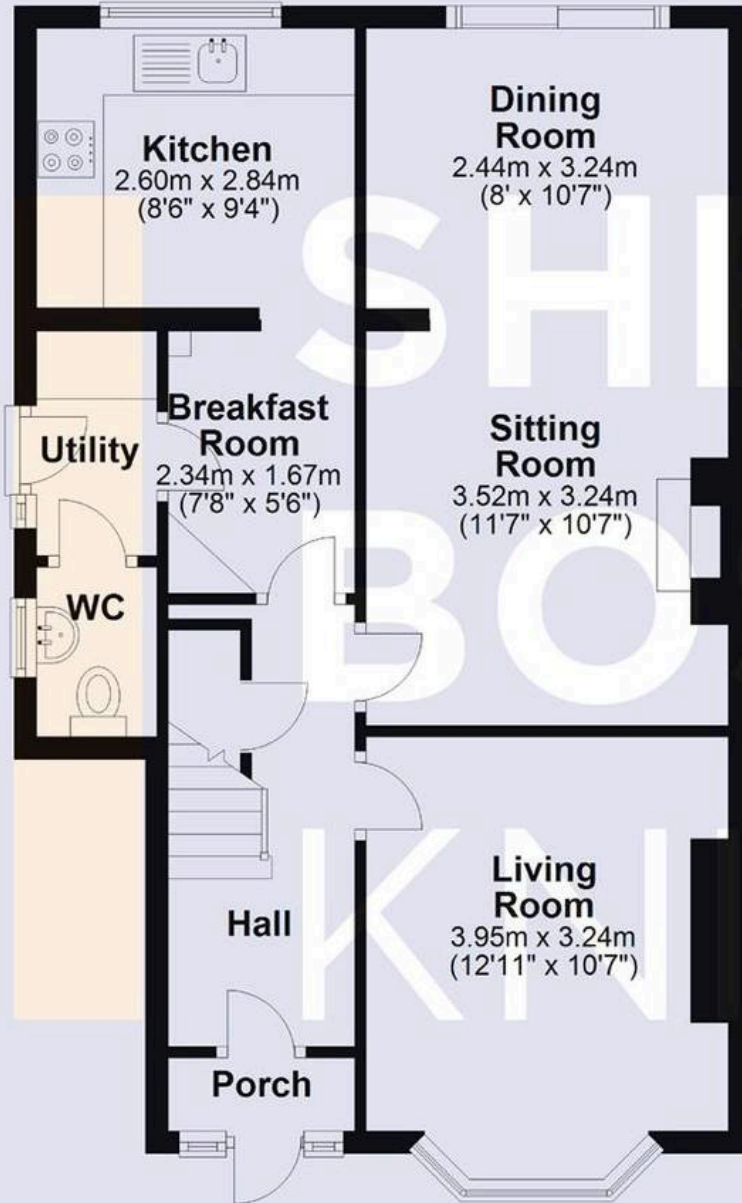

## First Floor

Approx. 39.7 sq. metres (427.0 sq. feet)



Total area: approx. 96.5 sq. metres (1039.1 sq. feet)

DISCLAIMER - Floor plans shown are for general guidance only. Whilst every attempt has been made to ensure that the floorplan measurements are as accurate as possible, they are for illustrative purposes only.



## Sheldon Bosley Knight Nuneaton

Sheldon Bosley Knight, 39 Newdegate Street, Nuneaton - CV11 4ER

02476374949 • [nuneaton@sheldonbosleyknight.co.uk](mailto:nuneaton@sheldonbosleyknight.co.uk) • [www.sheldonbosleyknight.co.uk/](http://www.sheldonbosleyknight.co.uk/)