



The Downs, SW20

£459,950

This two double bedroom, second floor property has been completely refurbished offering a large living/dining room with balcony and a brand new kitchen and bathroom, with shower over bath.

Located on The Downs, a highly regarded location in Wimbledon, you are close to Wimbledon Town Centre with the district line and overground station, wide range of shopping facilities, restaurants and bars.

Features

- Two Double Bedrooms
- Balcony
- Parking
- Communal Gardens
- New Bathroom
- New Kitchen

The Downs, London, SW20

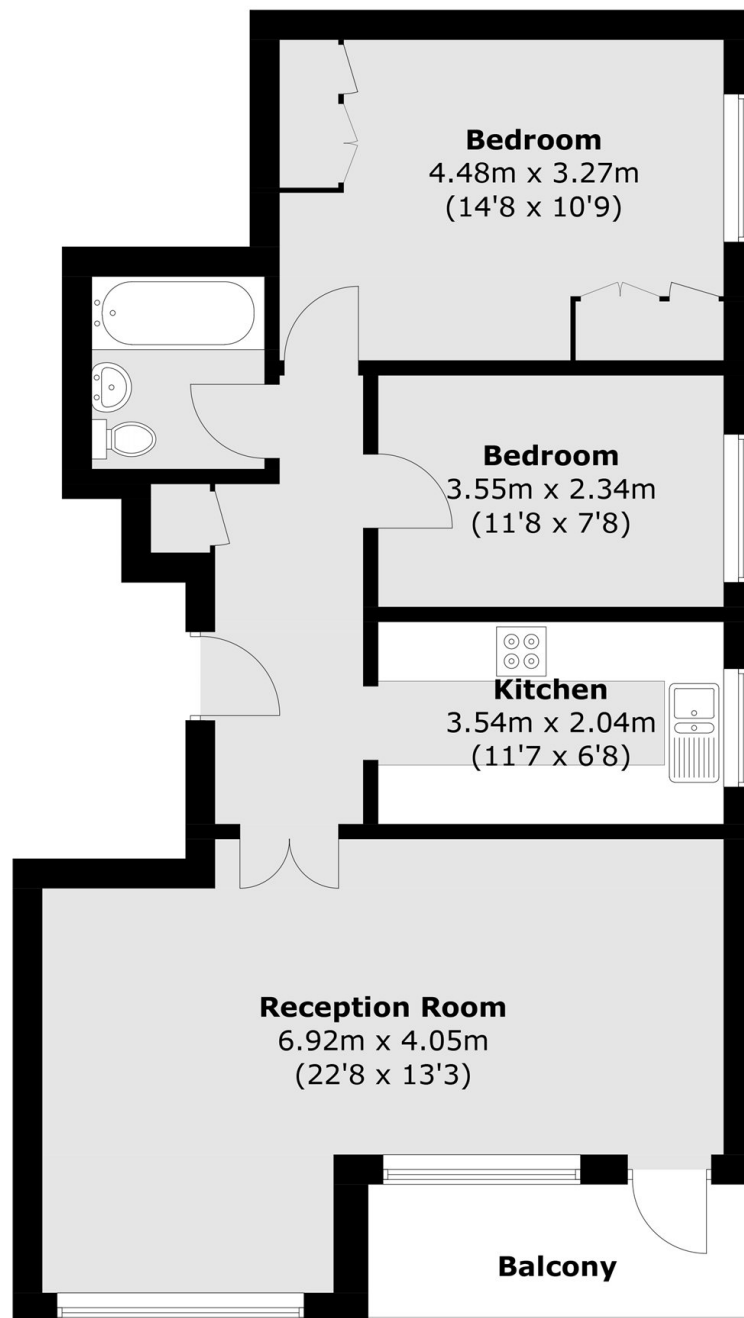

Total area (approx.): 68.7 sq. m (739.5 sq. ft)
Balcony: 5.2 sq. m (56.0 sq. ft)