



8 Windmill Copse, Dibden Purlieu, SO45 4BZ
£315,000



ANTHONY JAMES
PROPERTIES



8 Windmill Copse

Dibden Purlieu, Southampton

This well-presented three bedroom semi-detached house is situated in the sought-after area of Dibden Purlieu. The property features a spacious open plan living area, seamlessly connecting to the kitchen and dining spaces, with sliding door providing direct access to the conservatory. The conservatory offers an additional versatile reception area. Each of the three bedrooms is generously proportioned, providing ample space for family living or working from home, and benefits from built-in storage for added convenience. The family bathroom is complemented by tasteful fixtures and fittings.

The property also boasts a compact, low maintenance rear garden. Additional benefits include driveway parking for multiple vehicles and a garage, offering further storage or secure parking options. Located in a popular residential area, this home is close to well-regarded local schools, shops, and amenities, with excellent transport links nearby. This attractive property would make an ideal family home or a sound investment opportunity, combining comfort, practicality, and a desirable location.



Council Tax band: C

Tenure: Freehold



1 Southward House
Dibden Purlieu SO45 4PT



T: 02380 844405
info@anthonyjamesproperties.co.uk



GROUND FLOOR
510 sq.ft. (47.4 sq.m.) approx.

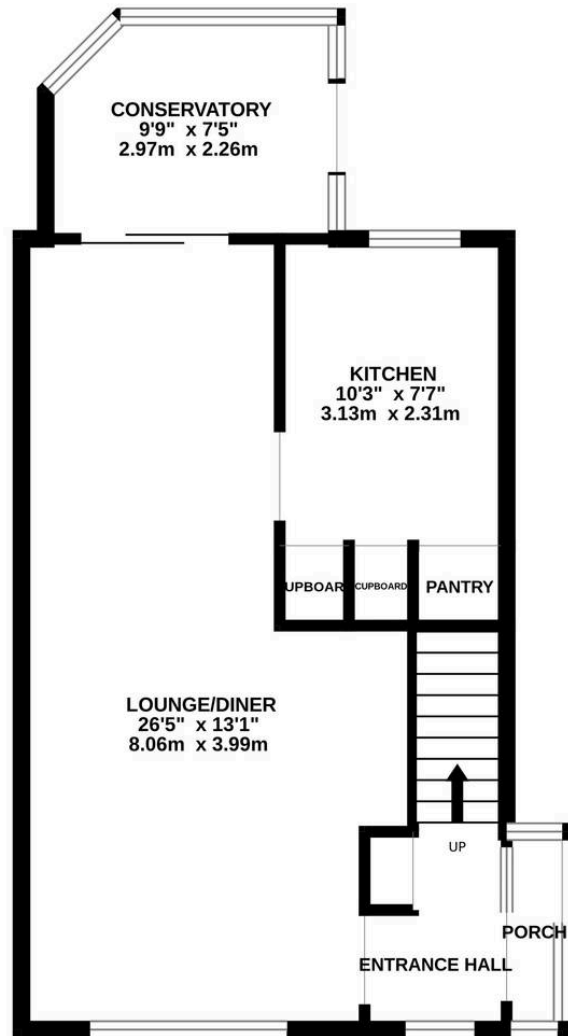

1ST FLOOR
429 sq.ft. (39.9 sq.m.) approx.



TOTAL FLOOR AREA : 939 sq.ft. (87.3 sq.m.) approx.

Whilst every attempt has been made to ensure the accuracy of the floorplan contained here, measurements of doors, windows, rooms and any other items are approximate and no responsibility is taken for any error, omission or mis-statement. This plan is for illustrative purposes only and should be used as such by any prospective purchaser. The services, systems and appliances shown have not been tested and no guarantee as to their operability or efficiency can be given.

Made with Metropix ©2026