

oakheart



£290,000

Offers In Excess Of
Mill Road, West Mersea

Located in the sought-after coastal town of West Mersea, this well-presented three-bedroom mid-terraced home on Mill Road presents a fantastic opportunity for families, first-time buyers, or anyone looking to enjoy the best of seaside living.

As you enter the property, you're welcomed by a bright and airy entrance hallway. To the left, a generously sized living/dining area provides a flexible and inviting space for relaxing or entertaining. Natural light floods in from the adjoining sun room,

which opens directly onto the rear garden—perfect for indoor-outdoor living during the warmer months.

The kitchen is conveniently located off the main living space and offers ample storage and workspace, making it both practical and stylish for everyday cooking.

Upstairs, the home boasts three well-proportioned bedrooms—two spacious doubles and a third single bedroom, ideal as a

nursery, office, or guest room. A large family bathroom completes the first floor, offering plenty of space for a busy household.

Externally, the property boasts a long rear garden offering plenty of space and potential for landscaping or creating a fantastic outdoor living area. To the front, a private driveway provides convenient off-road parking.









oakheart

Local Authority:
Colchester

Tenure:
Freehold

Council Tax Band:
B

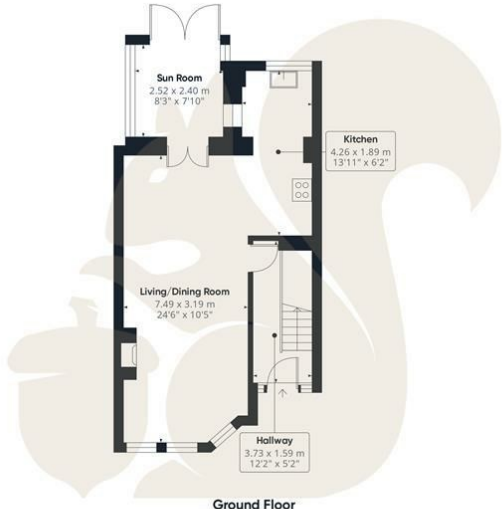

Ground Floor



Floor 1

Approximate total area⁽¹⁾
73.3 m²
788 ft²

(1) Excluding balconies and terraces

Calculations reference the RICS IPMS 3C standard. Measurements are approximate and not to scale. This floor plan is intended for illustration only.

GIRAFFE360

Energy Efficiency Rating

	Current	Potential
<i>Very energy efficient - lower running costs</i>		
(92 plus) A		
(81-91) B		83
(69-80) C		
(55-68) D	60	
(39-54) E		
(21-38) F		
(1-20) G		
<i>Not energy efficient - higher running costs</i>		

England & Wales EU Directive 2002/91/EC

Agents Note: Whilst every care has been taken to prepare these particulars, they are for guidance purposes only. All measurements are approximate and are for general guidance purposes only and whilst every care has been taken to ensure their accuracy, they should not be relied upon.

Oakheart Mersea
01206 382191
mersea@oakheart.co.uk
34a Barfield Rd, West Mersea, Colchester, Essex, CO5 8QT

oakheart