



6 Tucker Street, Watford – WD18 0AU
£479,000





An immaculate 2 bedroom Victorian terraced house, completely refurbished by the present owners, 2 reception rooms, 19ft kitchen/ breakfast room, 2 double bedrooms, bathroom (off bedroom 1), gas central heating, double glazing, low maintenance rear garden, residents permit parking, sought after convenient location, close to all local amenities, with easy access to Watford town centre & Watford High Street station





6 Tucker Street

Watford

- Immaculate 2 Bed Terrace House
- Completely Refurbished
- 2 Reception Rooms
- Bathroom (off Bed1)
- Low Maintenance Garden
- Residents Permit Parking
- Close to Watford Town Centre

Council Tax band: C

Tenure: Freehold

EPC Energy Efficiency Rating: C

EPC Environmental Impact Rating: C









Ground Floor

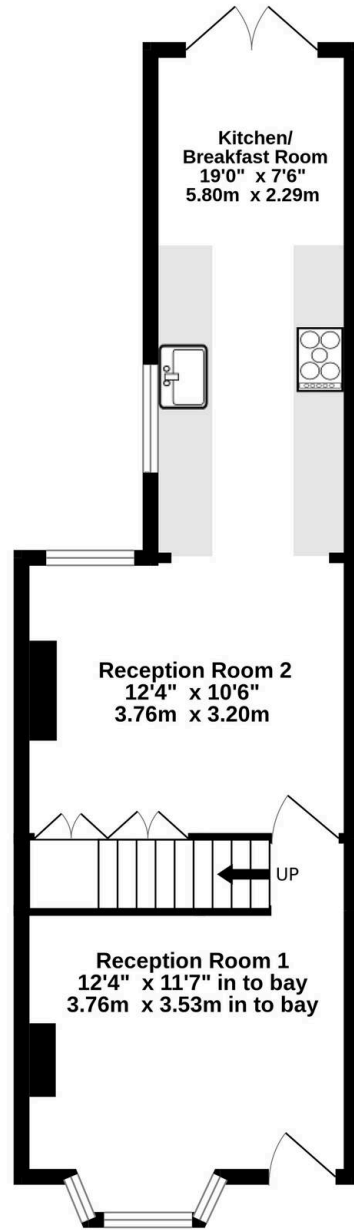

1st Floor

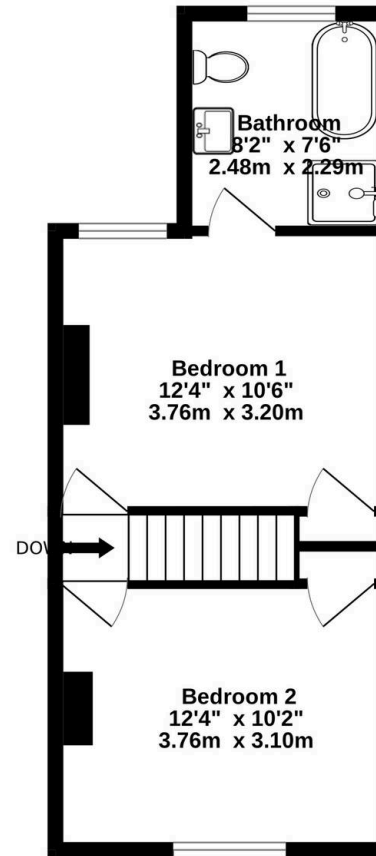

Whilst every attempt has been made to ensure the accuracy of the floorplan contained here, measurements of doors, windows, rooms and any other items are approximate and no responsibility is taken for any error, omission or mis-statement. This plan is for illustrative purposes only and should be used as such by any prospective purchaser. The services, systems and appliances shown have not been tested and no guarantee as to their operability or efficiency can be given.
Made with Metropix ©2024

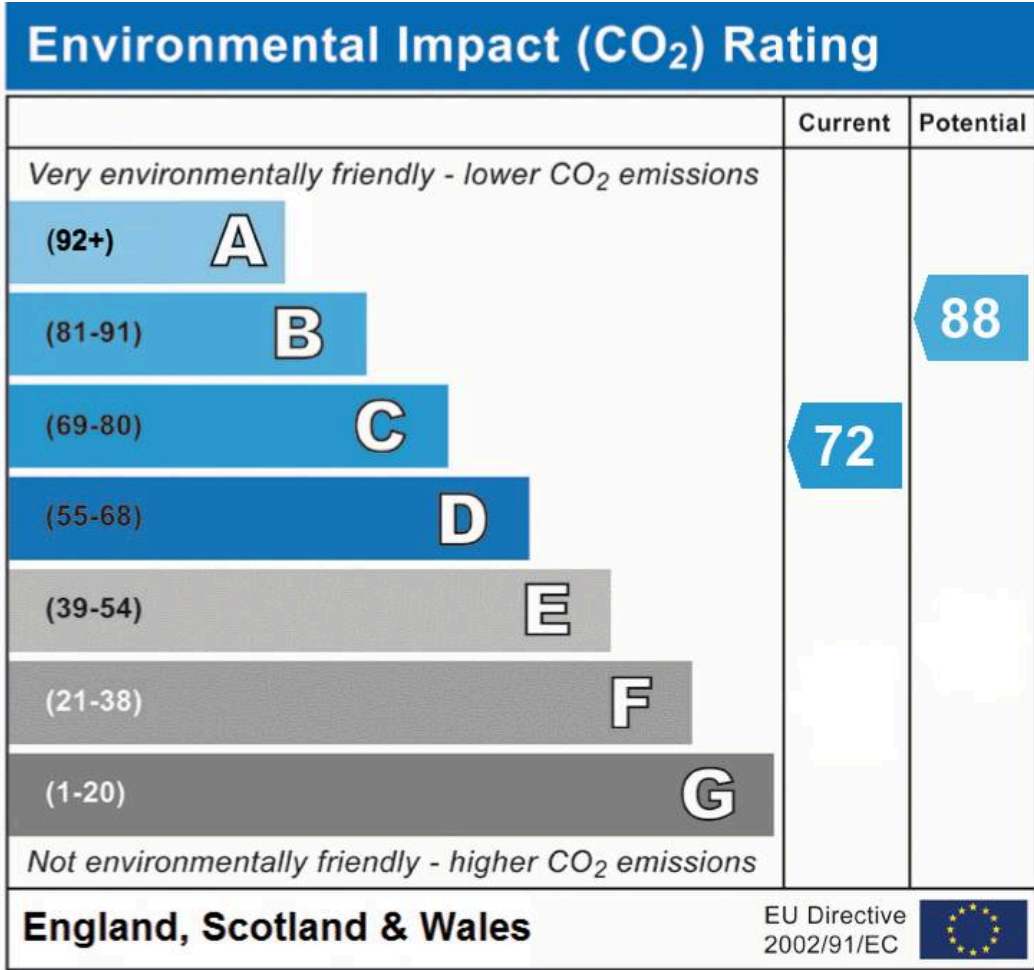
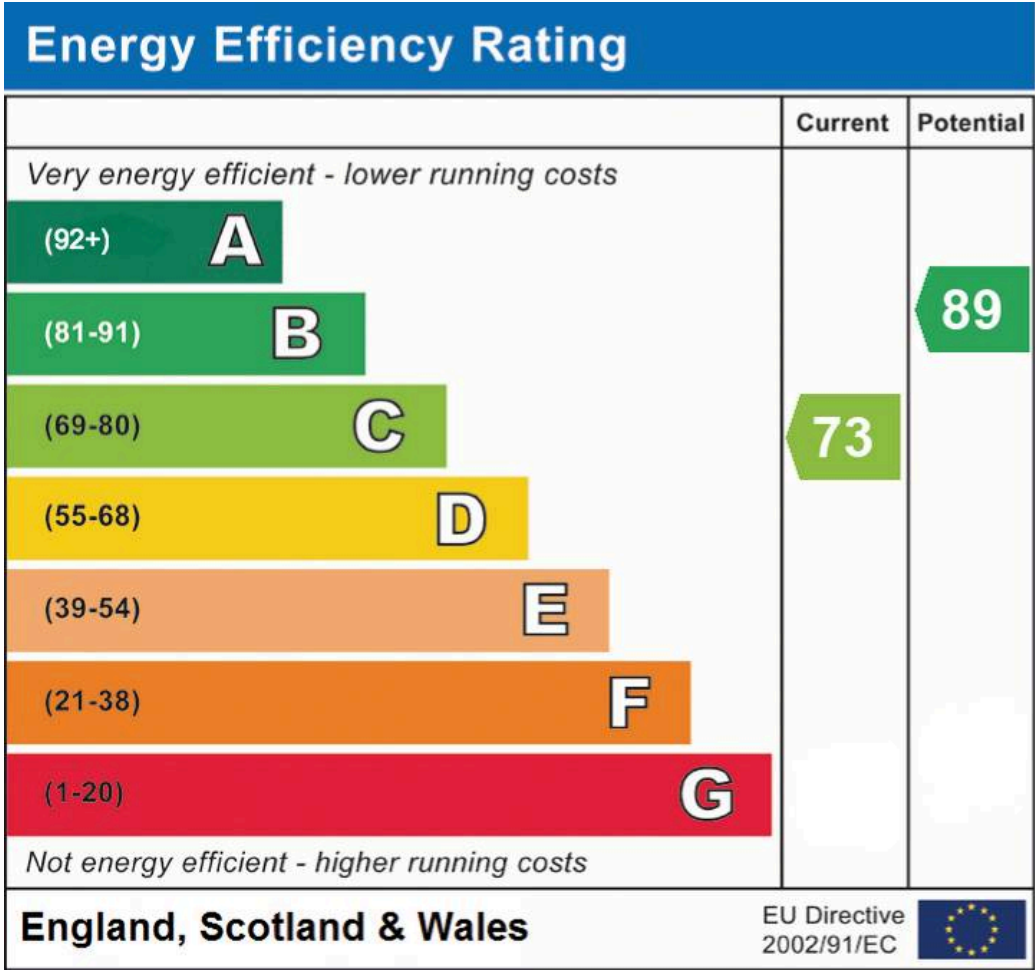

Churchills – Bushey

Churchills Estate Agents, 72 High Street – WD23 3HE

020 8950 0033

churchillsbushey.co.uk

We have prepared these particulars as a general guide of the property and they are not intended to constitute part of an offer or contract. We have not carried out a detailed survey of the property and we have not tested any apparatus, fixtures, fittings, or services. All measurements and floorplans are approximate, and photographs are for guidance only. These should not be relied upon for the purchase of carpets or any other fixtures or fittings. Lease details, service charges and ground rent (where applicable) have been provided by the client and should be checked and confirmed by your solicitor prior to exchange of contracts.