



COUNTRY
HOLMES

The Green, Marple

£275,000

🛏️ 2 🚿 1 🛋️ 1



- Two bedrooms
- No onward chain
- Redecorated throughout
- Attractive open outlook across Hawk Green with long-distance views
- Enclosed rear courtyard & outhouse
- Spacious dining kitchen

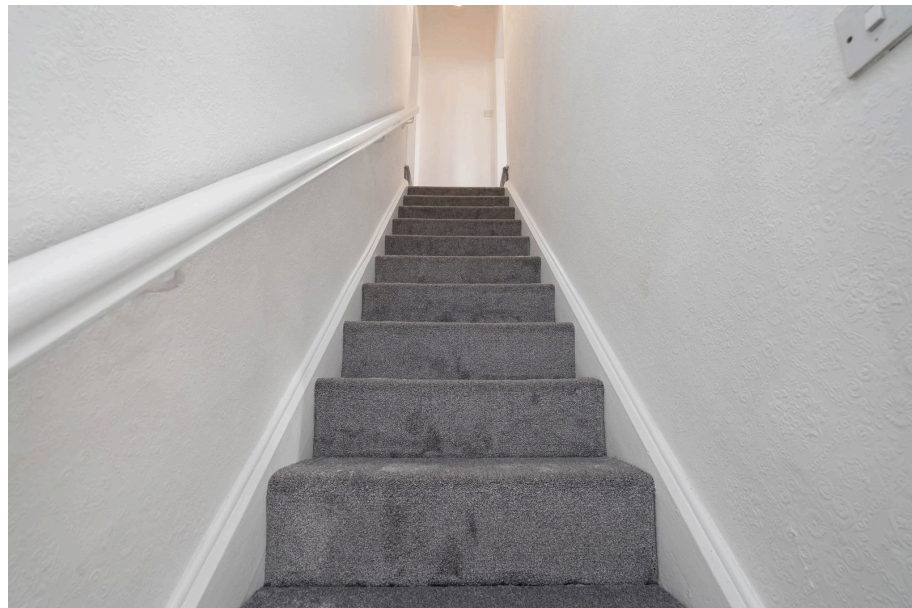

A well-presented two-bedroom mid-terrace home offering generously sized accommodation throughout, coming to the market with NO ONWARD CHAIN. Quietly positioned on a peaceful cul-de-sac, the property enjoys an enviable outlook directly across the open green space of Hawk Green, with easy access to children’s play areas and attractive long-distance views.

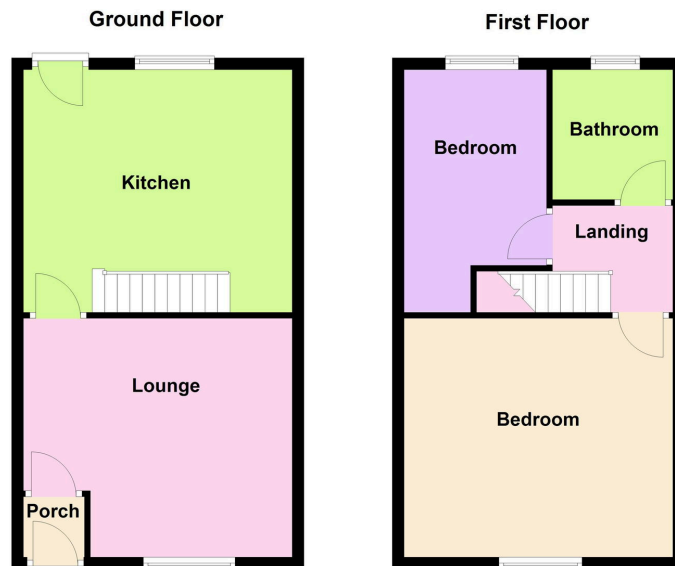

| Energy Efficiency Rating | | |
|--|---|-----------|
| | Current | Potential |
| <i>Very energy efficient - lower running costs</i> | | |
| (92 plus) A | | |
| (81-91) B | | 84 |
| (69-80) C | 69 | |
| (55-68) D | | |
| (39-54) E | | |
| (21-38) F | | |
| (1-20) G | | |
| <i>Not energy efficient - higher running costs</i> | | |
| England & Wales | EU Directive 2002/91/EC  | |