



## Civic Street, TW3

£1,750 Per calendar month

A brand new one double bedroom apartment in this new build development overlooking lampton park. This property comes with a large living room with open plan kitchen, modern bathroom and private terrace.

This property is around the corner from Hounslow Central Station, local amenities such as 24hr Asda, Hounslow High Street and Lampton Park.

### Features

- Brand New Development
- One Double Bedroom
- Open Plan Kitchen
- Modern Bathroom
- Private Terrace
- Beautiful Views

# Civic Street, Hounslow, TW3

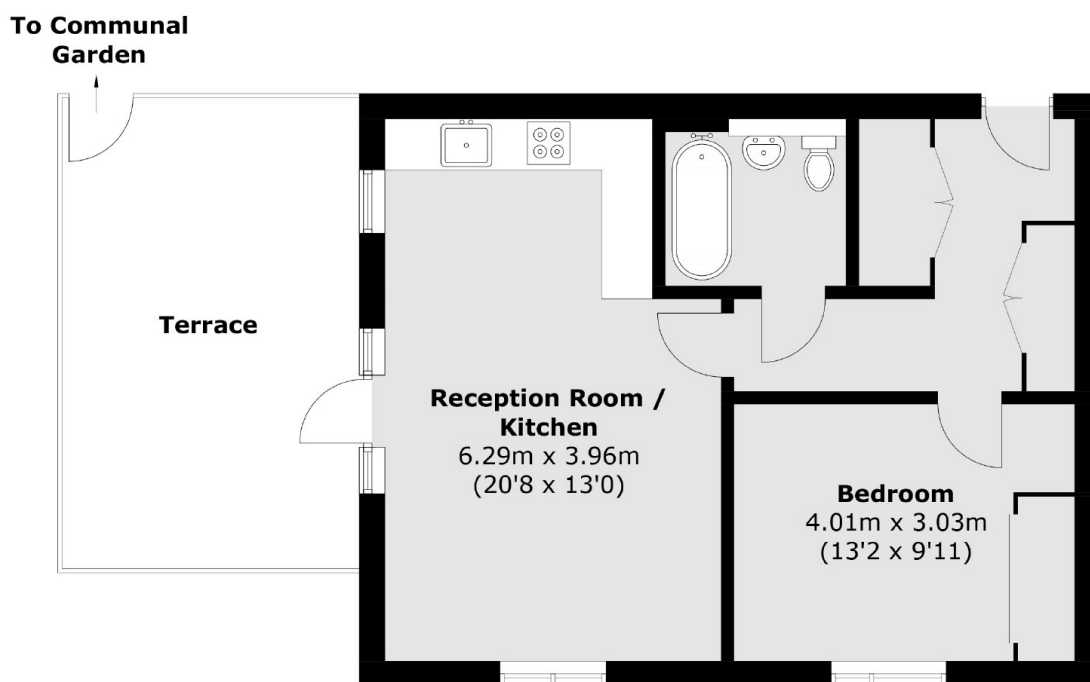

Total area (approx.): 52.1 sq. m (560.8 sq. ft)  
Terrace area (approx.): 19.4 sq. m (208.8 sq. ft)