

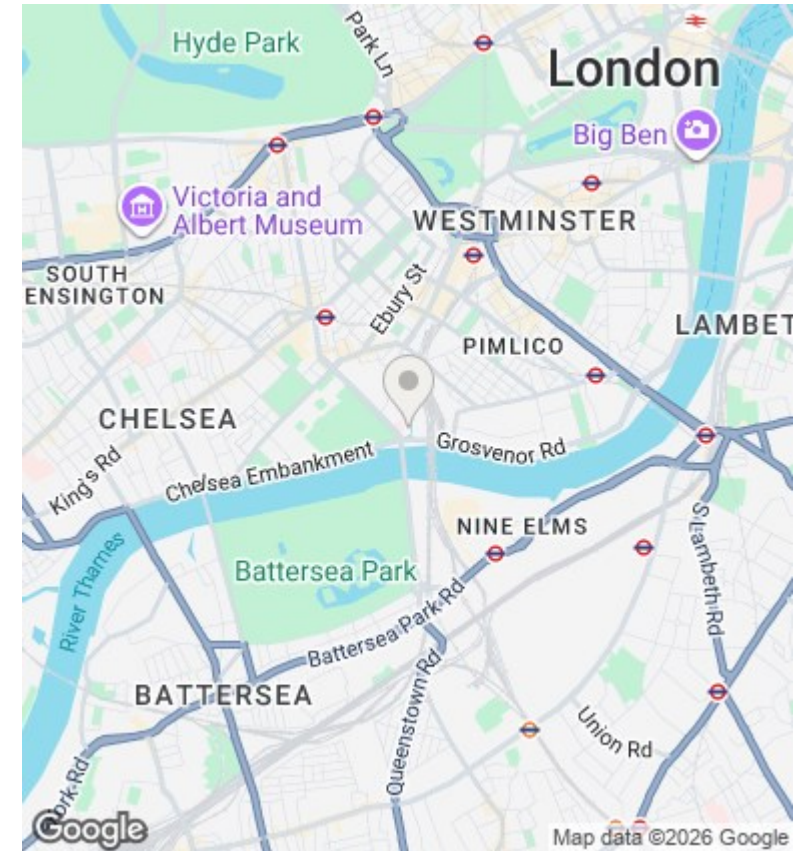

Hirst Court, Grosvenor Waterside, SW1W SW1W 8QD

£3,300 PCM

- 24 hour concierge
- Modern development
- Great Transport Links
- Available now
- Gym
- Westminster City Council
- 2 Bedroom 2 en-suite bathrooms
- Spa
- Close to Sloane Square and Victoria
- Wood flooring

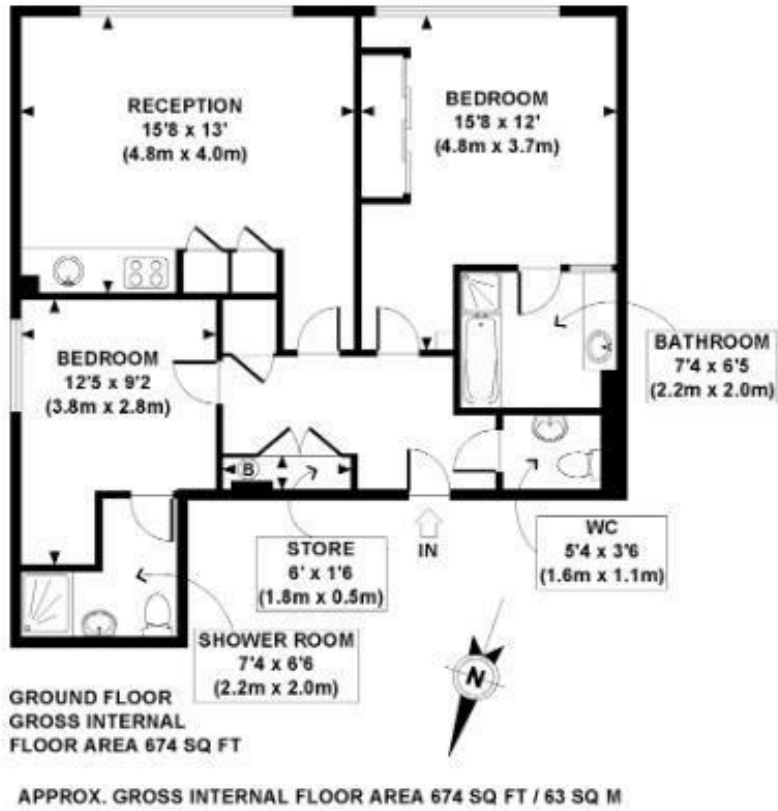

Viewings

Viewings by arrangement only.
Call 02077225022 to make an appointment.

Council Tax Band

F

EPC Rating:

C

Energy Efficiency Rating		
	Current	Potential
<i>Very energy efficient - lower running costs</i>		
(92 plus) A		
(81-91) B		
(69-80) C	77	79
(55-68) D		
(39-54) E		
(21-38) F		
(1-20) G		
<i>Not energy efficient - higher running costs</i>		
England & Wales	EU Directive 2002/91/EC	