



3



1



2



C

DavidJames
the estate agent

Short Street, Sutton in Ashfield, Sutton-In-Ashfield, NG17 4GD

£800 Per Calendar Month

About This Property

Presenting a refurbished mid-terrace house, this inviting home offers a superb blend of contemporary style and practical convenience, situated just a short distance from the vibrant Sutton Town Centre. Step inside to discover a home that has been thoughtfully updated from top to bottom. The welcoming lounge (3.83m x 3.56m) provides a comfortable space to relax, flowing seamlessly through to the impressive dining kitchen (3.85m x 3.56m). This social hub is fitted with sleek white handle less units, integrated oven and hob, offering a stylish space for cooking, dining and entertaining. Rear porch and downstairs modern bathroom/WC, complete with a white suite and a mains-fed shower. (1.92m x 1.72m). Upstairs, the property boasts three bedrooms, each freshly decorated and carpeted. The accommodation is complemented by a convenient first-floor WC with a washbasin, ideal for busy family life or morning routines. Double Bedroom One (3.85m x 3.63m), double bedroom two (3.59m x 2.58m), single bedroom three (2.63m x 1.96m). This home also boasts a combination gas central heating and UPVC double glazing throughout for year-round comfort and efficiency. Externally, a low-maintenance rear yard provides a private outdoor space for potted plants, a morning coffee, or storing bicycles. With its complete refurbishment, excellent location close to Sutton's array of shops, cafes, transport links, this is a ready-to-move-into home not to be missed. Council Tax Band A, All mains services are connected, Freehold, EPC Rating C. Available for immediate occupation, early viewing advised BOND £923
VIEWING ACCOMPANIED WITH AGENTS

- Refurbished 3 bed mid terraced house
- Brand newly fitted dining kitchen with integrated oven and hob
- Front living room
- Ground floor bathroom/WC with shower over bath
- First floor WC with washbasin
- Combination gas central heating, UPVC double glazing
- Newly decorated and newly carpeted throughout
- Rear enclosed yard only
- EPC Rating C, Council Tax Band A
- Freehold, BOND £923







Floor 0

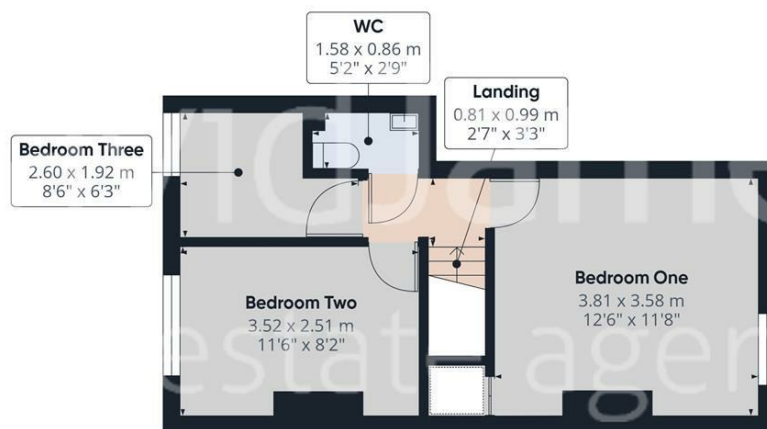

Floor 1



Approximate total area⁽¹⁾
62.6 m²
674 ft²

(1) Excluding balconies and terraces

Calculations reference the RICS IPMS 3C standard. Measurements are approximate and not to scale. This floor plan is intended for illustration only.

GIRAFFE360

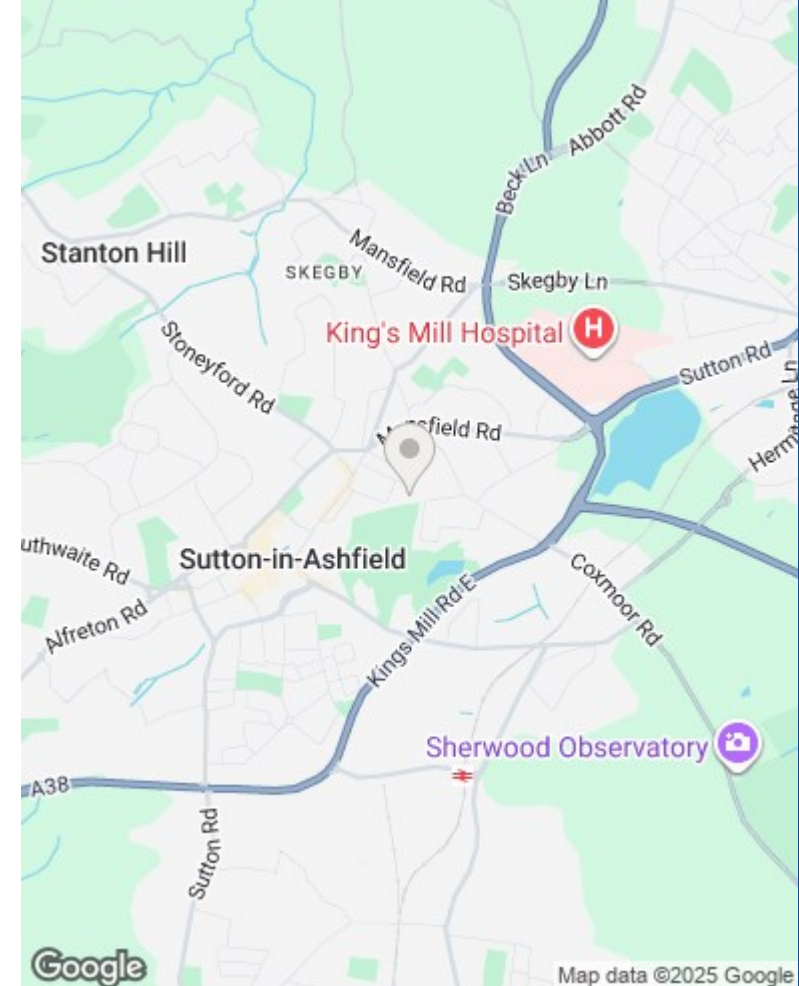

Council Tax Band: A
Ashfield District Council

These particulars are produced in good faith, are set out as a general guide only and do not constitute any part of a contract. No person in the employment of David James Estate Agents Ltd has any authority to make any representation whatsoever in relation to the property. All services, together with electrical fittings or fitted appliances have NOT been tested. All the measurements given in the details are approximate. Floor plans are for illustrative purposes only and are not drawn to scale. The position and size of doors, windows, appliances and other features are approximate only. The photographs of this property have been taken with a 10mm wide-angle lens. No responsibility can be accepted for any loss or expense incurred in viewing. If you have a property to sell you may wish to take advantage of our free valuation service. David James Estate Agents have established professional relationships with third-party suppliers for the provision of services to Clients. As remuneration for this professional relationship, the agent receives referral commission from the third-party company. David James Estate Agents receives the following commission from each third party supplier on a per referral basis: W A Barnes Ltd: £60 including VAT. All Moves UK Ltd: 18% including VAT of the invoice total (£107 including VAT average). MoveWithUs Limited: £188 including VAT (average).

DavidJames
the estate agent

David James Estate Agents
43 Forest Street, Sutton in Ashfield, Nottinghamshire,
NG17 1DA
t: 01623 554084 e: sales@waharnes.co.uk

naea | propertymark
PROTECTED

