



HOMES BY VICTORIA
ESTATE AGENCY

Ross Crescent, Inkberrow, WR7 4FG

Offers Over £450,000

🛏 4 🚿 2 🚺 1



A Home That Captivates at Every Turn – Ross Crescent, Inkberrow - Step inside this show-stopping four-bedroom detached residence and prepare to be instantly enchanted. Perfectly positioned on the ever-popular Ross Crescent in the idyllic Worcestershire village of Inkberrow. This home offers a rare blend of modern sophistication, timeless comfort, and effortless style, from the moment you arrive, the attention to detail is undeniable - **a home that feels straight from the pages of a luxury interiors magazine.**

homesbyvictoria.co.uk

victoria@homesbyvictoria | 07833 136521

FOR M HOMES MIDLANDS LIMITED trading as Homes By Victoria Company Number: 13688840 VAT no: 470190115



HOMES BY VICTORIA
ESTATE AGENCY



HOMES BY VICTORIA

ESTATE AGENCY

Key Features

- Four beautifully presented bedrooms
- Air conditioning in lounge & master bedroom
- Stunning bespoke media wall
- Detached garage with electric points
- Hive smart heating system
- Show-home standard interiors throughout
- Immaculate kitchen diner with integrated appliances
- Landscaped garden with multiple seating areas
- EV charging point & ample driveway parking
- Estate management charge approx. £200 p.a.

Approx Gross Internal Area
134 sq m / 1444 sq ft

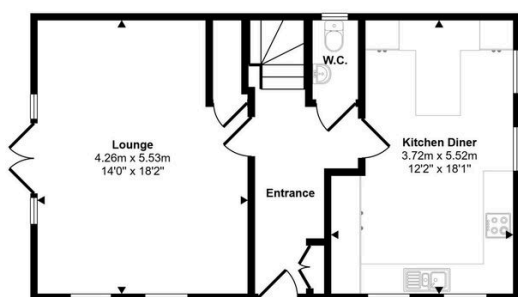

Ground Floor
Approx 54 sq m / 577 sq ft

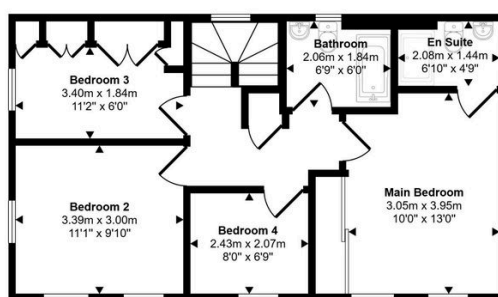

First Floor
Approx 54 sq m / 585 sq ft

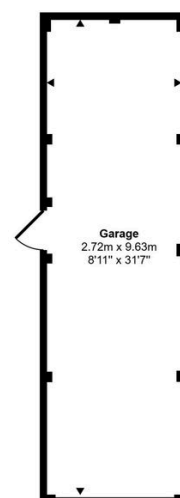

Garage
Approx 26 sq m / 282 sq ft

This floorplan is only for illustrative purposes and is not to scale. Measurements of rooms, doors, windows, and any items are approximate and no responsibility is taken for any error, omission or mis-statement. Icons of items such as bathroom suites are representations only and may not look like the real items. Made with Made Snappy 360.

