



**HENDERSON
CONNELLAN**

ESTATE AGENTS

Tennyson Road, Kettering NN16

"Character Property in an Ultra-Convenient Location"

"Character Property in an Ultra-Convenient Location"

This charming character property offered with NO CHAIN combines period elegance with an ultra-convenient location. Boasting lovely sized rooms and a low-maintenance garden, this home is perfect for those seeking comfort and practicality. The entrance hallway welcomes you with stunning original mosaic tiled flooring leading to a guest cloakroom, bay fronted living room and a formal dining room. The kitchen is well-appointed and complimented by the utility room. Upstairs, you will find three bedrooms, comprising two double rooms and a generous single along with the family bathroom complete with four piece suite. In addition there is a useful area accessed from the landing provides a perfect space for a home office. To the front, the property is enclosed by a low-level wall with a wrought iron gate and railings, featuring attractive slate covering for a welcoming approach. The step to the front door showcases the lovely original mosaic tiling. The beautifully presented rear garden is predominantly block paved with a gravelled seating area, flower beds, and select plantings. There is also a brick storage area and convenient rear access.

Living Room - 3.63m x 3.63m (11'11" x 11'11")

Dining Room - 4.24m x 3.02m (13'11" x 9'11")

Guest WC - 1.91m x 1.07m (6'3" x 3'6")

Kitchen - 3.1m x 2.87m (10'2" x 9'5")

Utility Room - 2.77m x 2.87m (9'1" x 9'5")

Bedroom One - 4.85m x 3.63m (15'11" x 11'11")

Bedroom Two - 3.63m x 3.02m (11'11" x 9'11")

Bedroom Three - 2.9m x 2.84m (9'6" x 9'4")

Office - 1.96m x 1.35m (6'5" x 4'5")

Bathroom - 3.1m x 1.96m (10'2" x 6'5")

- NO CHAIN
- Ultra-Convenient Location
- Character Property
- Bay Window
- Lovely Sized Rooms
- Low-Maintenance Garden
- Utility Room
- EPC RATING: D
- COUNCIL TAX: B

Tenure: Freehold





Ground Floor

Approx. 55.0 sq. metres (591.9 sq. feet)

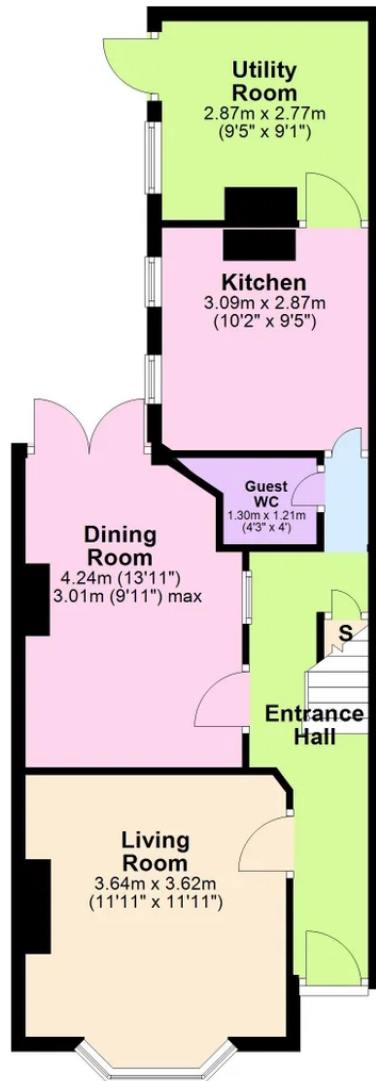

First Floor

Approx. 57.3 sq. metres (616.8 sq. feet)

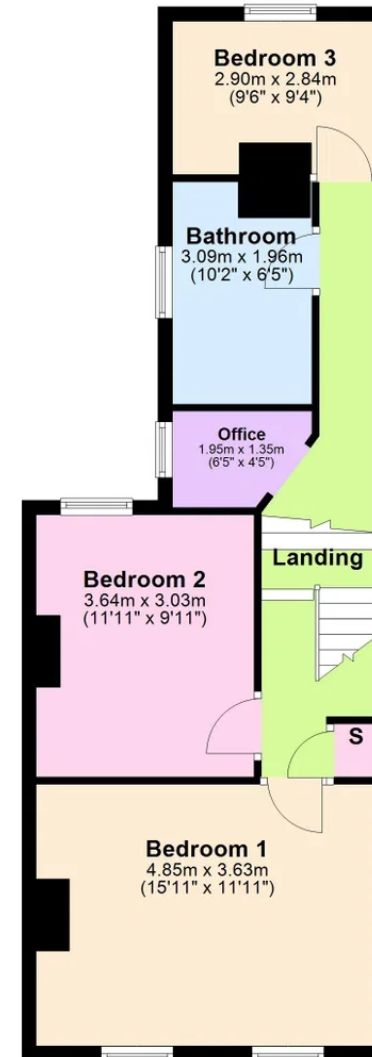

Total area: approx. 112.3 sq. metres (1208.7 sq. feet)

Henderson Connellan Kettering office 01536 417888 ketteringsales@hendersonconnellan.co.uk



Disclaimer: These particulars do not form part of any offer or contract and should not be relied upon as statements or representations of fact. Any areas, measurements of distances are approximate. The text, photographs and plans are for guidance only and are not necessarily comprehensive.

