



Castles

ASKING PRICE

£185,000

Rigby Place

Enfield, EN3 6GX

PROPERTY SUMMARY

A two bedroom first floor purpose built flat located on the popular Enfield Island Village within approx 1m of Enfield Lock BR station (serving London Liverpool Street). The property is offered for sale chain free. Viewing recommended. Features include: communal parking area, two bedrooms, double glazing, security entryphone system, first floor, ideal for first time buyer or buy to let investment, viewing recommended.

18 Morris Court

We are acting in the sale of the above property and have received an offer of £175,000 on the above property.

Any interested parties must submit any higher offers in writing to the selling agent before exchange of contracts takes place





For a guide to the area
please scan this code for
more information

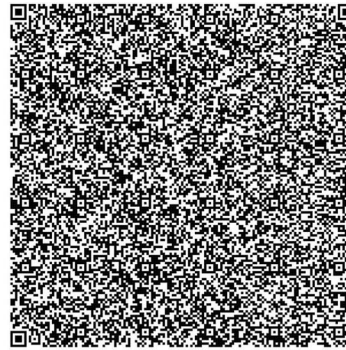

SCAN ME

APPROXIMATE GROSS INTERNAL AREA
50.48 sqm / 543.36 sqft

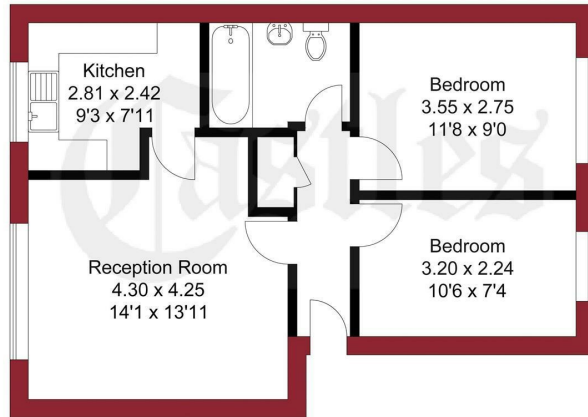

FIRST FLOOR

THIS PLAN IS FOR ILLUSTRATION ONLY AND MAY NOT BE
REPRESENTATIVE OF THE PROPERTY



Flat - First Floor

Leasehold

Council:

Council Tax Band: D

Lease Remaining: n/a

Service Charge: n/a

Ground Rent: n/a

Agents Note: Whilst every care has been taken to prepare these particulars, they are for guidance purposes only. All measurements are approximate and are for general guidance purposes only and whilst every care has been taken to ensure their accuracy, they should not be relied upon and potential buyers/tenants are advised to recheck the measurements



OFFICE ADDRESS

243 - 245 Hertford Road
Enfield
London
EN3 5JJ

OFFICE DETAILS

0208 804 8000
enfield@castles.london
<https://www.castles.london>

Energy Efficiency Rating		Current	Potential
Very energy efficient - lower running costs			
A	(67-91)		
B	(61-66)		
C	(55-60)		
D	(49-54)		
E	(43-48)		
F	(37-42)		
G	(31-36)		
Not energy efficient - higher running costs			
EU Directive 2002/91/EC			
England & Wales			