



**2 Gladstone Street, Redfield**

Offers in Region of **£350,000**





## 2 Gladstone Street

Redfield, Bristol

Council Tax band: B

Tenure: Freehold

EPC Energy Efficiency Rating:

EPC Environmental Impact Rating:

- 1960's Style Mid Terraced Property
- Open Plan Lounge/Dining Room
- Fitted Kitchen
- Conservatory
- Three Bedrooms
- Family Bathroom
- South Facing Garden With Rear Access
- Off Street Parking
- Double Glazing & Gas Central Heating
- No Onward Chain





GROUND FLOOR  
487 sq.ft. (45.2 sq.m.) approx.

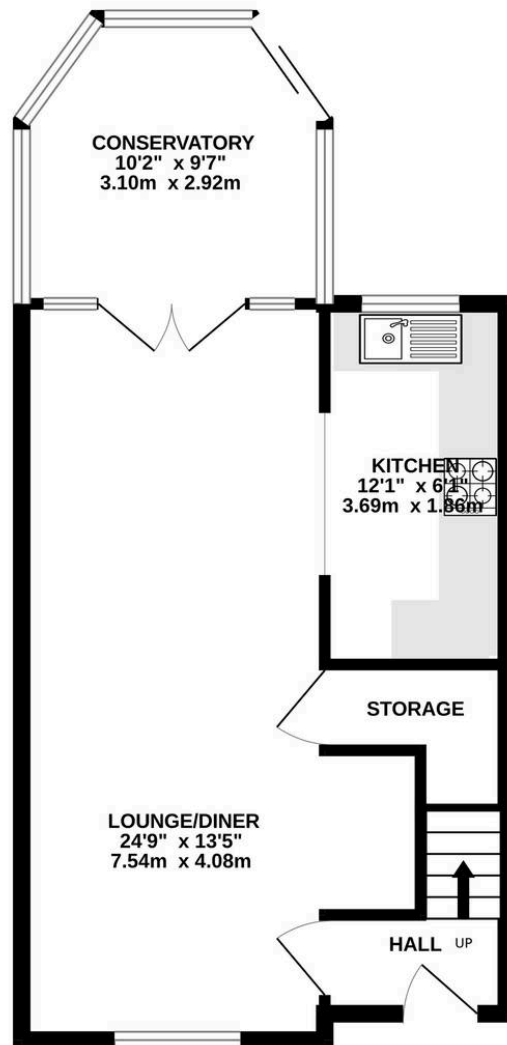

1ST FLOOR  
403 sq.ft. (37.4 sq.m.) approx.

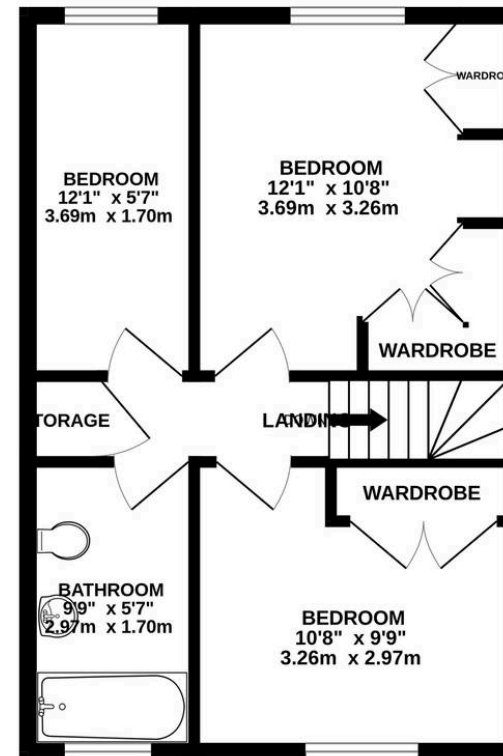

TOTAL FLOOR AREA : 889 sq.ft. (82.6 sq.m.) approx.

Whilst every attempt has been made to ensure the accuracy of the floorplan contained here, measurements of doors, windows, rooms and any other items are approximate and no responsibility is taken for any error, omission or mis-statement. This plan is for illustrative purposes only and should be used as such by any prospective purchaser. The services, systems and appliances shown have not been tested and no guarantee as to their operability or efficiency can be given.  
Made with Metropix ©2025

