



## Broadmead, ##Invalid £200,000

- Driveway
- Nearby Schools
- Local Amenities
- Great Transport Links
- Backs onto Playing Fields
- EPC Rating: D



 3  1  2



## About the property

Presenting a charming, semi-detached property now available for purchase, perfect for families seeking a peaceful residence imbued with a strong sense of community. This property is conveniently situated near local amenities, green spaces, and parks, offering a balance of convenience and tranquility to its residents.

The property boasts three neutrally decorated bedrooms, offering ample space for personalisation to truly make it your own. It also benefits from a well-appointed bathroom, ensuring comfort and practicality for all members of the family.

The heart of the home, the kitchen, is well-sized and ready to take on any culinary challenge. In addition, the property features a welcoming reception room, ideal for hosting family gatherings or simply relaxing after a long day.

One of the standout features of this property is its exterior offerings. The South-West facing garden is a perfect oasis for outdoor enjoyment, offering ample space for children to play, or for those green-fingered enthusiasts to cultivate.



 peter  
alan

Accommodation

01495 231199

blackwood@peteralan.co.uk

## Floorplan

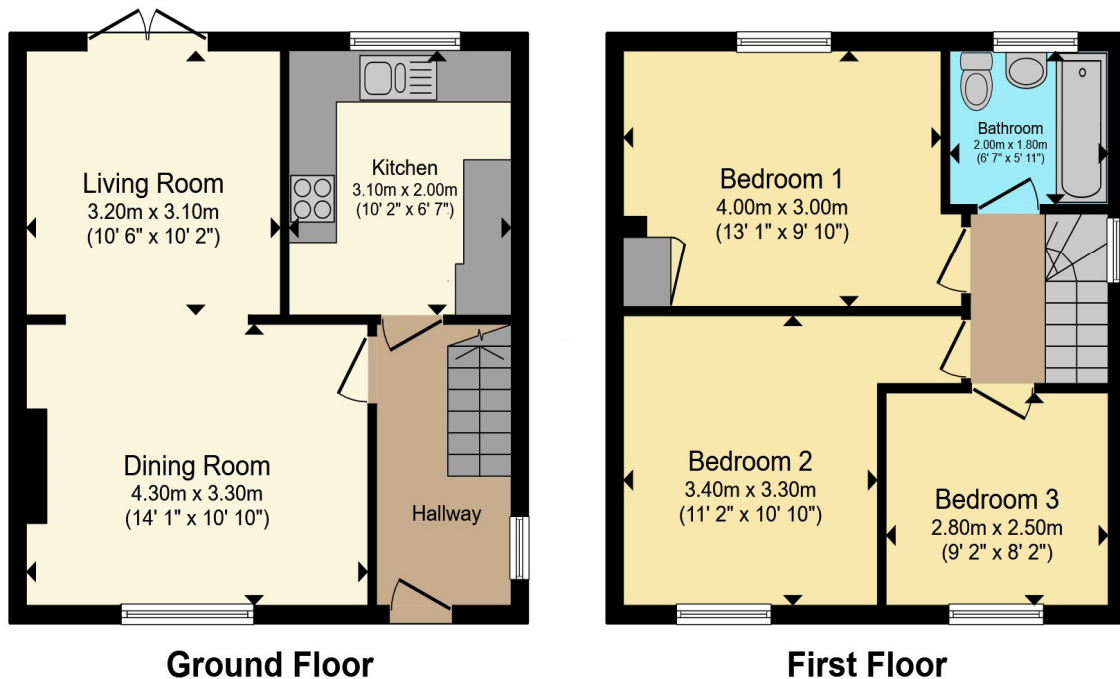

Total floor area 79.3 m<sup>2</sup> (854 sq.ft.) approx

This floor plan is for illustrative purposes only. It is not drawn to scale. Any measurements, floor areas (including any total floor area), openings and orientation are approximate. No details are guaranteed, they cannot be relied upon for any purpose and they do not form part of any agreement. No liability is taken for any error, omission or misstatement. A party must rely upon its own inspection(s). Powered by [www.propertybox.io](http://www.propertybox.io)



Under the terms of the Estate Agency Act 1979 (Section 21), please note that the vendor is an Employee of the Connells Group of companies.

## Important Information

Note while we endeavour to make our sales details accurate and reliable, if there is any point which is of particular interest to you, please contact the office and we will be pleased to confirm the position for you. We have not personally tested any apparatus, equipment, fixtures, fittings or services and cannot verify they are in working order or fit for their purposes. Nothing in these particulars is intended to indicate that carpets or curtains, furnishings or fittings, electrical goods (whether wired or not), Gas fires or light fittings or any other fixtures not expressly included form part of the property offered for sale. This computer generated Floorplan, if applicable, is intended as a general guide to the layout and design of the property. It is not to scale and should not be relied upon for dimensions. Tenure: We cannot confirm the tenure of the property as we have not had access to the legal documents. The buyer is advised to obtain verification from their solicitor or surveyor.

Peter Alan Limited is registered in England and Wales under company number 2073153, Registered Office is Cumbria House, 16-20 Hockliffe Street, Leighton Buzzard, Bedfordshire, LU7 1GN. VAT Registration Number is 500 2481 05. For activities relating to regulated mortgages and non-investment insurance contracts, Peter Alan Limited is an appointed representative of Connells Limited which is authorised and regulated by the Financial Conduct Authority. Connells Limited's Financial Services Register number is 302221. Most buy-to-let

