

for sale

£280,000 Freehold



Cochrane Close Tipton DY4 7DJ

BEAUTIFUL Modern Semi Detached FAMILY HOME on a SOUGHT AFTER DEVELOPMENT, WALKING DISTANCE TO TRAIN STATION in a CUL DE SAC Having a Lounge, Fitted Kitchen, 3 Bedrooms, Family Bathroom, En-Suite to Master Bedroom, Downstairs W.C. Driveway, Garage & Gardens. IDEAL FAMILY HOME. Viewing Recommended

Cochrane Close Tipton DY4 7DJ

Reception Hall

With stairs to First Floor

Downstairs W.C

Fitted Kitchen

12' x 8' 8" (3.66m x 2.64m)

Lounge

15' x 12' (4.57m x 3.66m)

Having doors to rear garden

On The First Floor

Landing

Bedroom One

11' x 10' 4" (3.35m x 3.15m)

En Suite Shower Room

Bedroom Two

8' 7" x 7' 1" (2.62m x 2.16m)

Bedroom Three

9' 3" x 6' (2.82m x 1.83m)

Family Bathroom

Outside

To Front

Driveway And Gravel Area

Garage

16' 4" x 8' 2" (4.98m x 2.49m)

To Rear

Rear Garden

Having lawn, patio area and gate to front





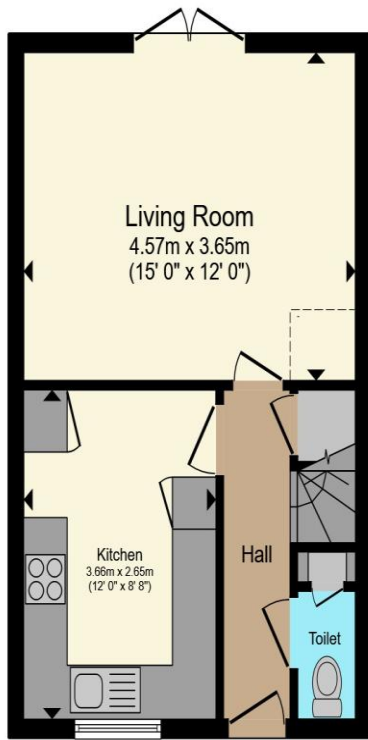

Ground Floor

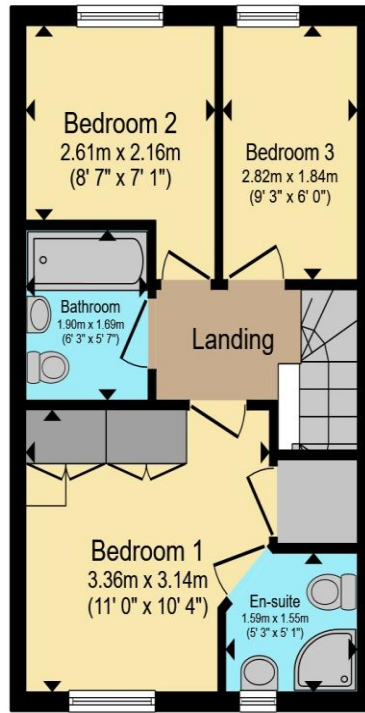

First Floor

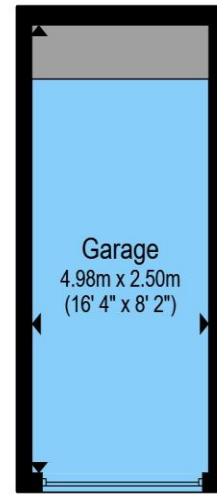

Garage

Total floor area 79.9 m² (860 sq.ft.) approx

This floor plan is for illustrative purposes only. It is not drawn to scale. Any measurements, floor areas (including any total floor area), openings and orientation are approximate. No details are guaranteed, they cannot be relied upon for any purpose and they do not form part of any agreement. No liability is taken for any error, omission or misstatement. A party must rely upon its own inspection(s). Powered by www.propertybox.io



To view this property please contact Paul Dubberley on

T 0121 522 3733
E greatbridge@pauldubberley.co.uk

73 Great Bridge
 TIPTON DY4 7HF

Property Ref: PTI105226 - 0002

Tenure:Freehold EPC Rating: Awaited

Council Tax Band: C

check out more properties at PaulDubberley.co.uk



1. MONEY LAUNDERING REGULATIONS Intending purchasers will be asked to produce identification documentation at a later stage and we would ask for your co-operation in order that there will be no delay in agreeing the sale. 2. These particulars do not constitute part or all of an offer or contract. 3. The measurements indicated are supplied for guidance only and as such must be considered incorrect. Potential buyers are advised to recheck measurements before committing to any expense. 4. We have not tested any apparatus, equipment, fixtures, fittings or services and it is in the buyers interest to check the working condition of any appliances.

Paul Dubberley is a trading name of Connells Residential which is registered in England and Wales under company number 1489613, Registered Office is Cumbria House, 16-20 Hockliffe Street, Leighton Buzzard, Bedfordshire, LU7 1GN. VAT Registration Number is 500 2481 05.

see all our properties at www.pauldubberley.co.uk | www.rightmove.co.uk | www.zoopla.co.uk