



*jordan fishwick*

Meadow Lane Disley Stockport



## Meadow Lane Disley Stockport SK12 2ES

£249,950



### The Property

Situated on a highly sought-after no-through road in the heart of Disley Village, this truly stunning and most impressive two-bedroom end-terraced cottage offers charm, style, and a wonderful setting. Boasting delightful southerly-facing gardens along with convenient street parking, this beautiful home must be viewed to be fully appreciated. The accommodation comprises a welcoming living room featuring a charming multi-fuel burning stove, creating a cosy focal point, and a well-presented, thoughtfully appointed dining kitchen. To the first floor, there is a generously sized master bedroom offering ample space for furnishings, a bright second bedroom complete with fitted wardrobes, and a tastefully refitted modern bathroom finished to a high standard. Externally, the property enjoys a private and enclosed lawned garden complemented by a paved seating area.



- Two Bedroom End Terrace
- Beautifully Presented Throughout
- Dining Kitchen
- South Facing Enclosed Garden
- Multi-Fuel Burner in Living Room
- Modern Bathroom
- Gas Central Heating
- Double Glazing

**Postcode** SK12 2ES

**EPC Rating** E

**Local Authority** Cheshire East

**Council Tax** B

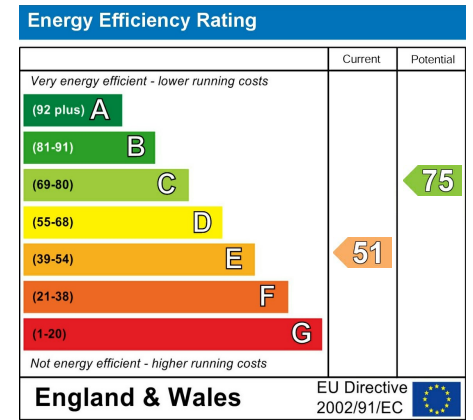

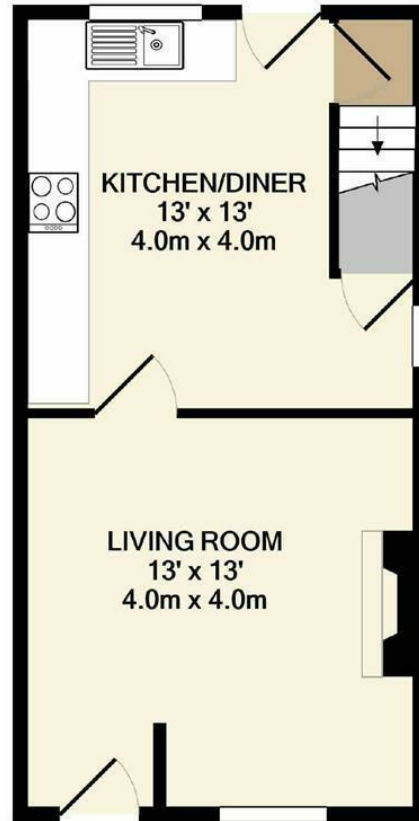

GROUND FLOOR



1ST FLOOR

Whilst every attempt has been made to ensure the accuracy of the floor plan contained here, measurements of doors, windows, rooms and any other items are approximate and no responsibility is taken for any error, omission, or mis-statement. This plan is for illustrative purposes only and should be used as such by any prospective purchaser. The services, systems and appliances shown have not been tested and no guarantee as to their operability or efficiency can be given  
 Made with Metropix ©2020



These particulars are believed to be accurate but they are not guaranteed and do not form a contract. Neither Jordan Fishwick nor the vendor or lessor accept any responsibility in respect of these particulars, which are not intended to be statements or representations of fact and any intending purchaser or lessee must satisfy himself by inspection or otherwise as to the correctness of each of the statements contained in these particulars. Any floorplans on this brochure are for illustrative purposes only and are not necessarily to scale.

Offices at: Chorlton, Didsbury, Disley, Hale, Glossop, Macclesfield, Manchester Deansgate, Manchester Whitworth Street, New Mills, Sale, Wilmslow and Withington

14 Market St, Disley, Cheshire, Stockport SK12 2AA

01663 767878

disley@jordanfishwick.co.uk  
 www.jordanfishwick.co.uk