



Westcombe Park Road, SE3

£250,000

A one bedroom ground floor retirement apartment with direct access to the communal grounds within this popular retirement block, communal reception room and laundry room for residents and comes with parking. The block is warden assisted and is well maintained throughout the year. The property is well appointed throughout and is neutrally decorated and has a modern kitchen and bathroom.

Located in the heart of Blackheath Standard, set back from the road and close to all the shops and amenities, within half a mile of Westcombe Park station and minutes to buses for North Greenwich, Greenwich and Blackheath.

Features

- Large One Bedroom
- Beautiful Grounds
- House Manager
- Excellent For Shops
- Close To Transport
- Chain Free

Westcombe Park Road, London, SE3

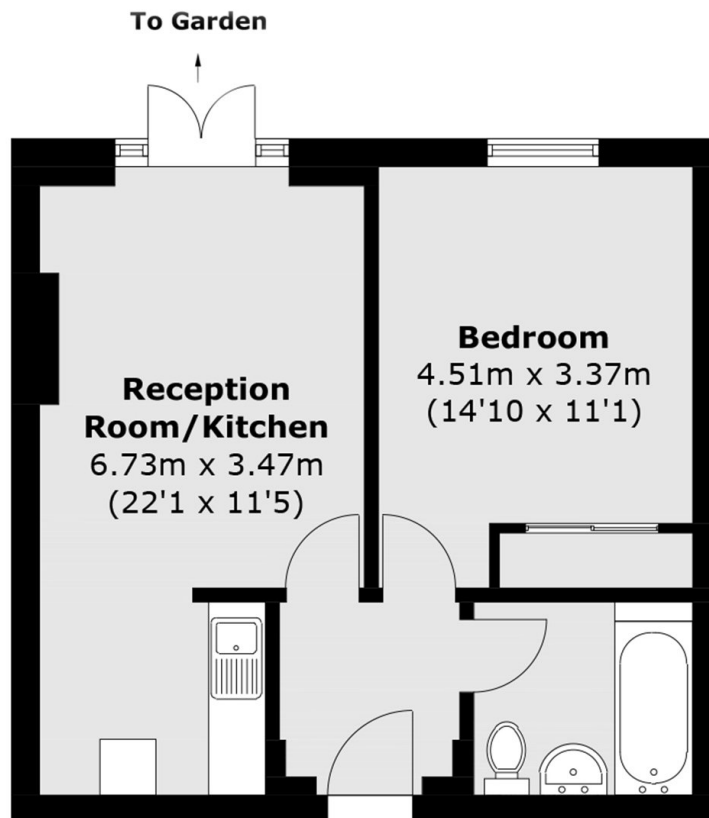

Total area (approx.): 47.0 sq. m (505.9 sq. ft)