



Connells

Old Torquay Road
Paignton



Property Description

this one-bedroom ground floor flat presents an opportunity for personalization, allowing you to make your unique mark and transform the space to reflect your individual style and preferences. With its inviting features, including the private garden and convenient layout, you have the canvas to create a living environment that resonates with your vision and lifestyle. The absence of an onward chain further simplifies the process, granting you the freedom to embark on your creative journey without delay. Whether you envision a cozy retreat, an artistic haven, or a functional oasis, this flat offers the perfect foundation to craft a home that truly embodies your identity.

Accommodation

Entrance door leading into

Entrance Hallway

Lounge

15' 1" x 12' 4" (4.60m x 3.76m)

uPVC double glazed french doors, feature open brick fireplace, storage cupboard, wall mounted storage heater, tv point and power points.

Bedroom

11' 8" x 11' 4" (3.56m x 3.45m)

uPVC double glazed bay window to the front aspect, mirrored sliding wardrobes, electric heater, tv point and power points.

Kitchen

12' 6" x 8' 5" (3.81m x 2.57m)

uPVC double glazed window to the side aspect, uPVC obscure double glazed door leading out to enclosed rear garden, matching wall, base and drawer units, further storage cupboards, rolled edge worksurface, single drainer sink unit, space for fridge freezer and plumbing for washing machine.

Bathroom

uPVC obscure dual aspect double glazed windows to the side and rear, corner shower cubicle with wall mounted electric shower, vanity unit with built in cupboards below and mixer tap over, low level wc, part tiled walls and tiled flooring.

Bathroom

uPVC obscure dual aspect double glazed windows to the side and rear, corner shower cubicle with wall mounted electric shower, vanity unit with built in cupboards below and mixer tap over, low level wc, part tiled walls and tiled flooring.

Outside

The south facing rear garden has a patio area with plant and shrub borders.



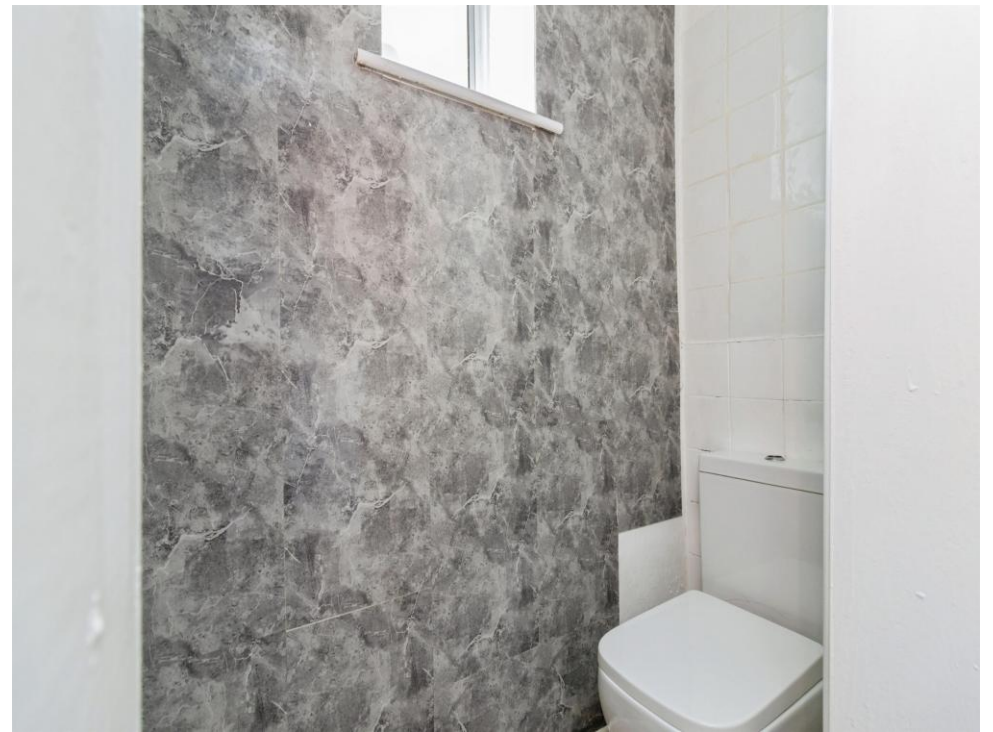



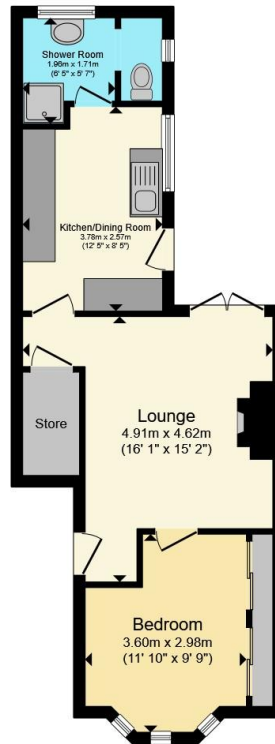

Total floor area 43.4 m² (467 sq.ft.) approx

This floor plan is for illustrative purposes only. It is not drawn to scale. Any measurements, floor areas (including any total floor area), openings and orientation are approximate. No details are guaranteed, they cannot be relied upon for any purpose and they do not form part of any agreement. No liability is taken for any error, omission or misstatement. A party must rely upon its own inspection(s). Powered by www.propertybox.io



To view this property please contact Connells on

T 01803 400 888
E paignton@connells.co.uk

51 Hyde Road
PAIGNTON TQ4 5BP

EPC Rating: E Council Tax
Band: A

Service Charge: Ask
Agent

Ground Rent:
Ask Agent

Tenure: Leasehold

view this property online connells.co.uk/Property/PGN313476

This is a Leasehold property. We are awaiting further details about the Term of the lease. For further information please contact the branch. Please note additional fees could be incurred for items such as Leasehold packs.



1. MONEY LAUNDERING REGULATIONS Intending purchasers will be asked to produce identification documentation at a later stage and we would ask for your co-operation in order that there will be no delay in agreeing the sale. 2. These particulars do not constitute part or all of an offer or contract. 3. The measurements indicated are supplied for guidance only and as such must be considered incorrect. Potential buyers are advised to recheck measurements before committing to any expense. 4. We have not tested any apparatus, equipment, fixtures, fittings or services and it is in the buyers interest to check the working condition of any appliances.

Connells Residential is registered in England and Wales under company number 1489613, Registered Office is Cumbria House, 16-20 Hockliffe Street, Leighton Buzzard, Bedfordshire, LU7 1GN. VAT Registration Number is 500 2481 05.

See all our properties at www.connells.co.uk | www.rightmove.co.uk | www.zoopla.co.uk

Property Ref: PGN313476 - 0003