



15, Dogpole, Shrewsbury, SY1 1EN
£1,300 Per Month



15, Dogpole, Shrewsbury, SY1 1EN

£1,300 Per Month

VIRTUAL TOUR AVAILABLE: Spacious three bedroom duplex character property located in the heart of Shrewsbury town centre with gated parking accessed via the historic St Alkmunds Square. Available long term

Available: 10/04/26

Description

Comprising: Entrance lobby with stairs from either Dogpole or St Alkmunds Square, stairs to first floor landing, large kitchen including appliances, dining room, study, large living room, shower room. Stairs to second floor landing, three double bedrooms, two further bathrooms, good amount of eaves storage. Gas central heating. Gated parking for one car in private courtyard to rear of the property. EPC TBC



Unfurnished

Council Tax Band: E

Available: 10th April 2026

EPC: C

Floor Plans

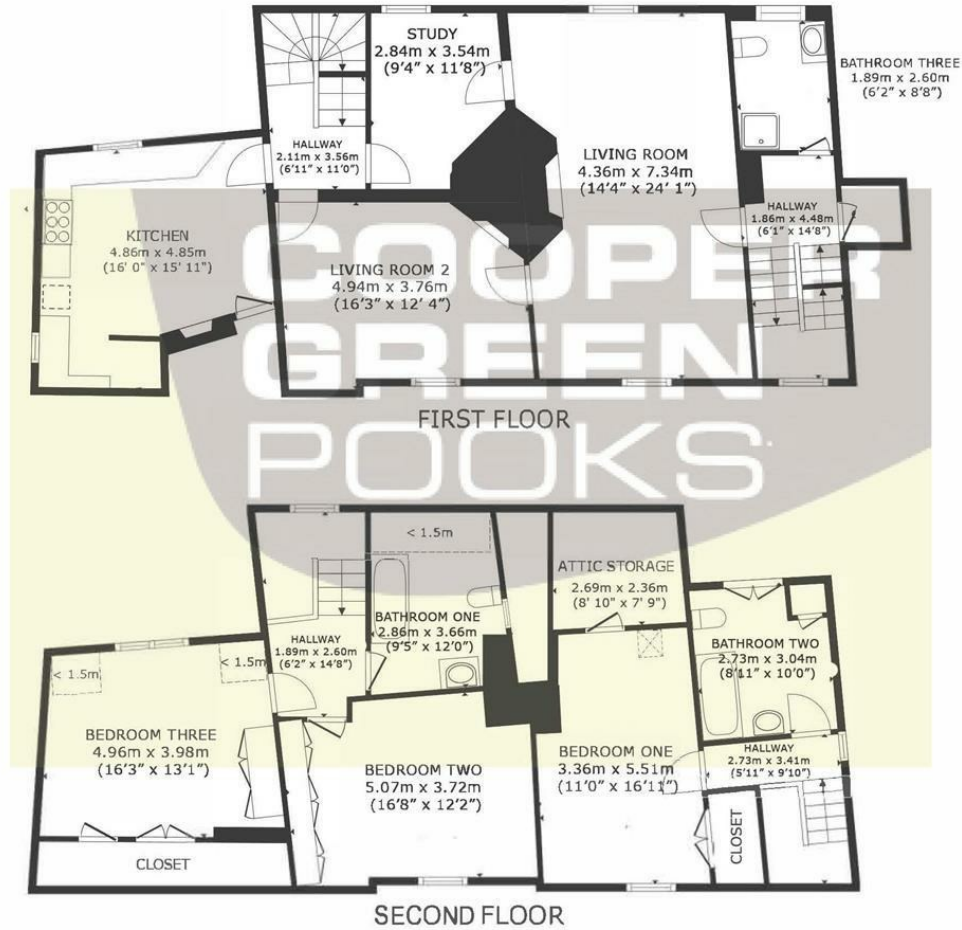

GROSS INTERNAL AREA
 FIRST FLOOR 104.1 m² (1,120 sq.ft.) SECOND FLOOR 98.8
 m² (1,064 sq.ft.) EXCLUDED AREAS: REDUCED HEADROOM
 3.4 m² (37 sq.ft.) TOTAL: 202.9 m² (2,184 sq.ft.)
 SIZES AND DIMENSIONS ARE APPROXIMATE, ACTUAL MAY
 VARY.

These particulars, whilst believed to be accurate are set out as a general outline only for guidance and do not constitute any part of an offer or contract. Intending purchasers should not rely on them as statements of representation of fact, but must satisfy themselves by inspection or otherwise as to their accuracy. No person in this firm's employment has the authority to make or give any representation or warranty in respect of the property.