

TAYLOR
MICHAEL

SALES & LETTINGS



2 Bed
Flat
located in Selden

£2,750 Per month



TAYLOR
MICHAEL
SALES & LETTINGS



TAYLOR
MICHAEL
SALES & LETTINGS



TAYLOR
MICHAEL
SALES & LETTINGS

TAYLOR
MICHAEL

9 Esplanade Court, The Esplanade, Worthing, BN11 2BL

Approximate Gross Internal Area = 96.3 sq m / 1036 sq ft
 External Cupboard = 0.6 sq m / 6 sq ft
 Total = 96.9 sq m / 1042 sq ft

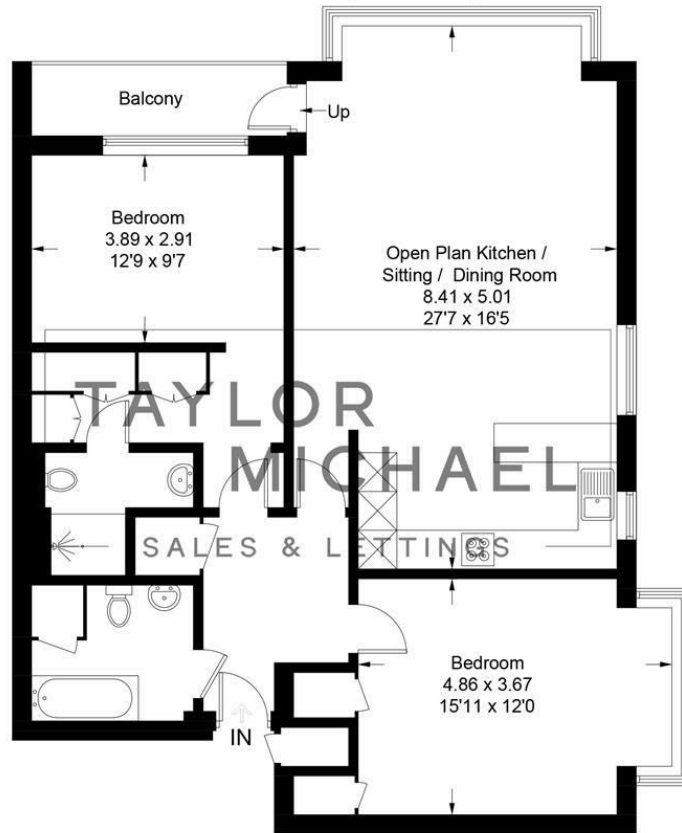

Fifth Floor

Illustration for identification purposes only, measurements are approximate, not to scale.
 Imageplansurveys @ 2026

DIRECTIONS

CONTACT

62 Church Road
 Hove
 East Sussex
 BN3 2FP

E: lettings@taylormichael.agency
 T: 01273 600100
<https://taylormichael.agency/>

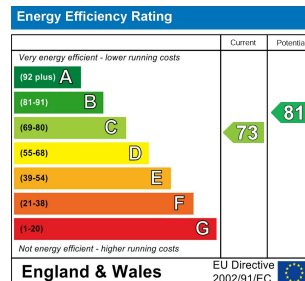

TAYLOR
 MICHAEL