



Robert Street

London, NW1

Asking Price £530,000

A bright and well located two double bedroom garden apartment with its own entrance. The property boasts its own front door and generously proportioned rooms throughout. Southerly facing garden. The West End of London is in walking distance. Being sold chain-free. Being sold chain-free.

CHESTERTONS



Robert Street

London, NW1

- Own entrance
- Chain-free
- Two double bedrooms
- Spacious reception leading directing to garden
- Excellent location



Robert Street is a very central location with excellent transport links. Warren Street, Euston and Kings Cross are all in close proximity. The green open space of Regent's Park is a walk up the road.

Tenure: Leasehold with 91 years remaining
Service Charge: £1,618 per annum
Ground Rent: £10 per annum
Local Authority: Camden
Council Tax Band: C

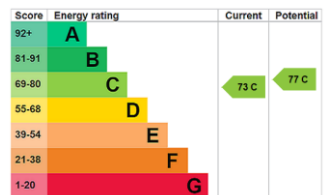

Chestertons Camden & Kentish Town Sales

99-101 Parkway
Camden
London
NW1 7PP
camden@chestertons.co.uk
020 7267 2053
chestertons.co.uk

Robert Street



○ - Ceiling Height

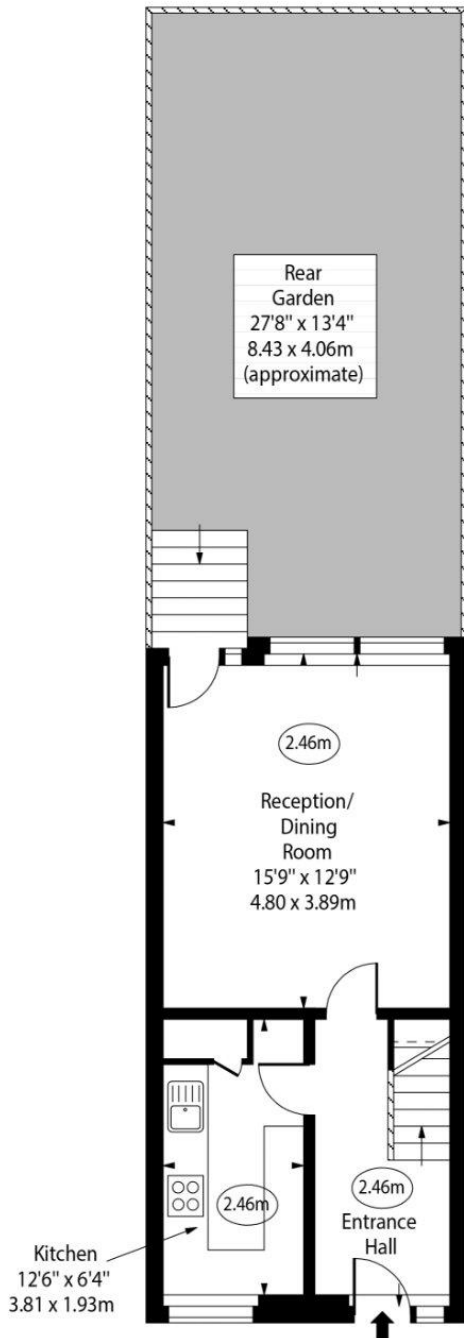

Ground Floor
Gross Internal Area - 363 Sq Ft - 33.72 Sq M

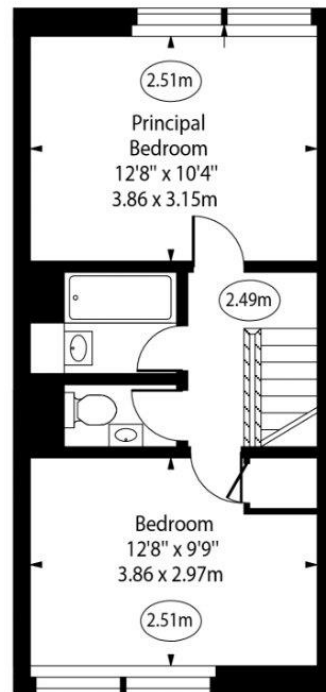

First Floor
Gross Internal Area - 361 Sq Ft - 33.54 Sq M

Approx Gross Internal Area 724 Sq Ft - 67.26 Sq M

Every attempt has been made to ensure the accuracy of the floor plan shown. However, all measurements, fixtures, fittings, and data shown are approximate interpretations and for illustrative purposes only. Measured according to the RICS. Not To Scale.

www.goldlens.co.uk
Ref. No. 031488M