



Chepstow Road, guide price £350,000- £360,000

- NO CHAIN
- Guide Price £350,000 to £360,000
- Three/Four Double Bedrooms, Two Reception Rooms and Separate Dining Room
- Enclosed Southerly-Facing Rear Garden
- Family Bathroom, En-Suite to Master and Additional Downstairs Wc
- Multicar Driveway with Ev Charger
- Excellent location
- EPC Rating: C



 3  2  1

Pinkmove

01633 746088
team@pinkmove.co.uk



About the property

This well-presented 3/4-bedroom property on Chepstow Road offers flexible living spaces, modern convenience, and an excellent location. Owned by the same family from new, the home has been thoughtfully maintained and adapted to suit a range of lifestyle needs.

The ground floor features a bright kitchen positioned to the front, followed by a convenient downstairs WC at the centre of the home. To the rear, the left-hand lounge provides a comfortable family space with French doors opening onto the enclosed garden, while a separate dining room sits to the right, ideal for hosting or day-to-day meals. The internal garage has been converted, creating a generous third reception room or a spacious fourth bedroom, offering impressive flexibility for families or home-workers. Tiled flooring runs throughout the entire ground floor, enhancing durability and ease of maintenance.

Upstairs, three versatile bedrooms are accompanied by a well-appointed family bathroom and en-suite to the master bedroom. Outside, the rear southerly facing garden offers an enclosed setting with raised decking area. To the front, a multi-car driveway and an EV charger provide excellent practicality for modern living.

Accommodation

Kitchen

10' 2" x 8' 7" (3.10m x 2.62m)

Lounge

14' x 12' 6" (4.27m x 3.81m)

Max Measurements

Dining Room

9' 8" x 10' 2" (2.95m x 3.10m)

Reception Room/Bedroom 4

16' 3" x 9' 4" (4.95m x 2.84m)



Pinkmove



Pinkmove



Pinkmove



Pinkmove



Pinkmove

Bedroom 1

12' 3" x 8' 11" (3.73m x 2.72m)

En Suite

7' 1" x 4' 10" (2.16m x 1.47m)

Max Measurements

Bedroom 2

8' 11" x 10' 5" (2.72m x 3.17m)

Bedroom 3

9' 9" x 10' 3" (2.97m x 3.12m)

Max Measurements

Bathroom

6' 9" x 11' (2.06m x 3.35m)

Wc

3' 5" x 8' 8" (1.04m x 2.64m)

Floorplan

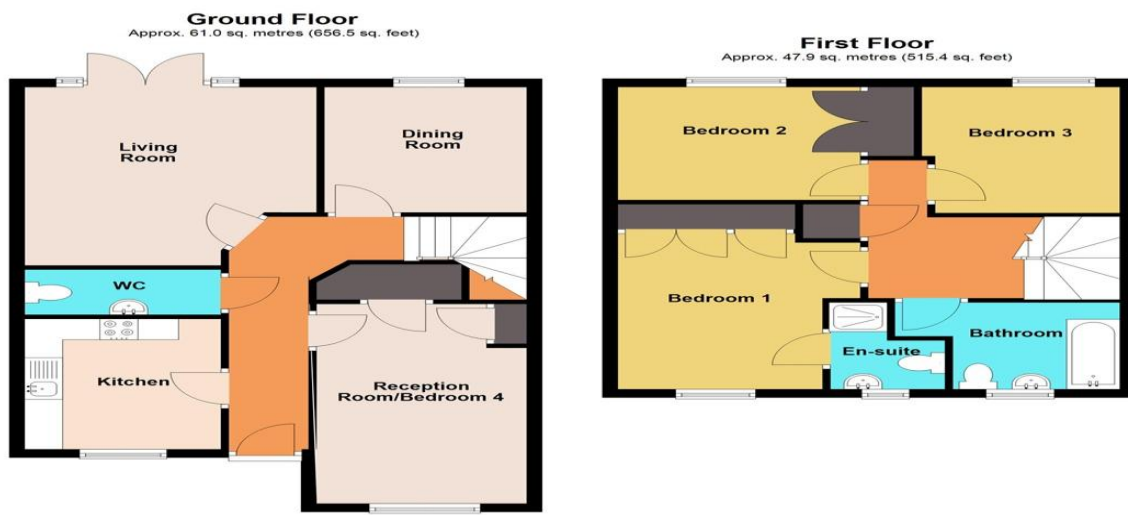

Total area: approx. 108.9 sq. metres (1171.9 sq. feet)
Crofton House

Important Information

Note while we endeavour to make our sales details accurate and reliable, if there is any point which is of particular interest to you, please contact the office and we will be pleased to confirm the position for you. We have not personally tested any apparatus, equipment, fixtures, fittings or services and cannot verify they are in working order or fit for their purposes. Nothing in these particulars is intended to indicate that carpets or curtains, furnishings or fittings, electrical goods (whether wired or not). Gas fires or light fittings or any other fixtures not expressly included form part of the property offered for sale. This computer generated Floorplan, if applicable, is intended as a general guide to the layout and design of the property. It is not to scale and should not be relied upon for dimensions. Tenure: We cannot confirm the tenure of the property as we have not had access to the legal documents. The buyer is advised to obtain verification from their solicitor or surveyor.

Peter Alan Limited is registered in England and Wales under company number 2073153, Registered Office is Cumbria House, 16-20 Hockliffe Street, Leighton Buzzard, Bedfordshire, LU7 1GN. VAT Registration Number is 500 2481 05. For activities relating to regulated mortgages and non-investment insurance contracts, Peter Alan Limited is an appointed representative of Connells Limited which is authorised and regulated by the Financial Conduct Authority. Connells Limited's Financial Services Register number is 302221. Most buy-to-let