



Aqua Vista Square, Bow E3
London

£2,350 pcm



Aqua Vista Square, Bow E3

Superb two bedroom two bathroom waterside apartment located adjacent to Bartlett Park and close to DLR stations, providing swift access into Canary Wharf and Central London.

- Two Bedroom Apartment
- Two Bathrooms
- Gated Modern Development
- Fifth Floor
- Private Balcony with Water and Park Views
- Langdon Park DLR Station Nearby
- Furnished
- Available Now!





Superb two bedroom two bathroom waterside apartment located adjacent to Bartlett Park and close to DLR stations, providing swift access into Canary Wharf and Central London.

Situated on the fifth floor of a secure, gated modern development, the property enjoys views over the waters of the Limehouse Cut, the open green spaces of the park and Canary Wharf's iconic skyline.

Spanning over 800 Sq/Ft, this well-presented apartment features an open-plan living space / fitted kitchen, which opens out onto a large balcony, two double bedrooms (one with an en-suite shower room), a main bathroom and hallway storage.

The immediate area is served by various local conveniences, including amenities on Devons Road and the historic Crisp Street Market. Langdon Park DLR station is within easy reach and the canal and park provide immediate opportunities for outdoor pursuits.

Offered furnished and available immediately, this would be the perfect next home for a couple or two professional sharers.

Council Tax band: D

Tenure: Leasehold

EPC Energy Efficiency Rating: C

EPC Environmental Impact Rating: B







Craig Tower

Approx. Gross Internal Area 76.3 sq. metres (820.9 sq. feet)

Fifth Floor

Approx. 76.3 sq. metres (820.9 sq. feet)
(excluding Balcony)

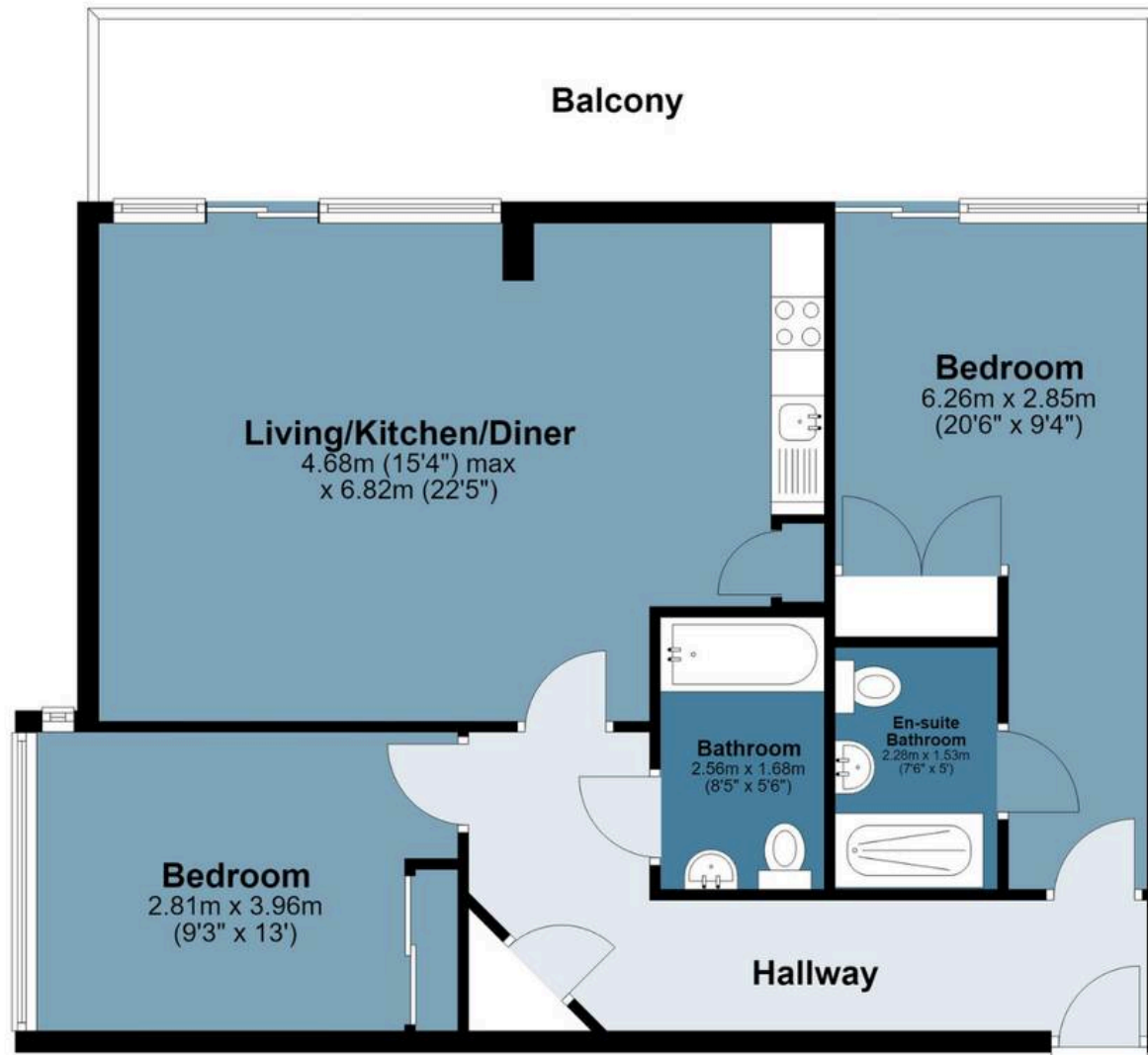
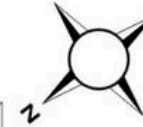

Measurements are approximate and for illustration purposes only. While we do not doubt the accuracy and completeness, we advise you conduct a careful independent assessment of the property to determine monetary value

FROM EAST LONDON ENERGY TO WEST ESSEX EASE

We Make Moving Home Easy.

At Butler and Stag, we do more than just connect London to West Essex – we make the move seamless. With offices spanning from vibrant East London to the tranquillity of West Essex, we understand the nuances of each area and the journey people take between them. Our marketing goes beyond standard listings, showcasing every property with precision, creativity, and reach that others simply can't match. Coupled with an unparalleled attention to detail, from first enquiry to final move-in, we ensure every client and customer feels informed, supported, and confident. Simply put, we do the little things that make a big difference, setting us apart in every step of the property experience.



LONDON STRATFORD SOUTH WOODFORD BUCKHURST HILL LOUGHTON EPPING BEYOND

Like what you see? Let's talk

Book your **FREE** valuation now



020 8102 1236

london@butlerandstag.com

508 Roman Road, Bow, London, E3 5LU

butlerandstag.uk

IMPORTANT NOTICE - These particulars have been prepared in good faith and they are not intended to constitute part of an offer or contract. We have not performed a structural survey on this property and the services, appliances and specific fittings have not been tested. All photographs, measurements, floor plans and distances referred to are given as a guide and should not be relied upon.

BUTLER & STAG

