

Visit Alternative Available



cubitt & west

Price

£1,300 PCM

Fees Apply



Available 17/03/26

**East Walls Chichester
PO19**

cubitt & west
Helping you move forwards



Main Features

- Open House
- Alternative Deposit Option
- Top-floor position
- Newly fitted kitchen
- Spacious open-plan layout.
- Prime location



Deposit required is £1,500.00
Chichester District - Council Tax Band Tax Band B

Renting a property is a big commitment and we recommend that you visit the local authority website and these websites which offer helpful information and advice about letting

www.gov.uk/government/publications/how-to-rent

www.gov.uk/private-renting

www.cubittandwest.co.uk/renting/tenancy-fees-individuals/

www.gov.uk/green-deal-energy-saving-measures

Call Chichester 01243 774772 ■ cubittandwest.co.uk

IMPORTANT INFORMATION: Please contact our Lettings Team who will confirm the total costs involved in renting this property. For clarification, we wish to inform the prospective tenant that we have prepared these details as a general guide. The agent has not carried out a detailed survey nor tested the services, appliances, or specific fittings (unless otherwise stated), and no warranty can be given as to their condition. All room measurements are taken at floor level. We strongly recommend that all the information which we provide about the property is verified by yourself and your advisers. The contents of this publication are © Cubitt & West, 2015. Cubitt & West is a trading name of Arun Estates Limited Registered in England No. 2597969

Accommodation

Open Plan Living / Dining Room 14'5 x 18'1

Kitchen 9'9 x 6'1

Bedroom 1 13'9 x 9'7

Bedroom 2 10'0 x 6'6

Bathroom 11'2 x 6'8



Top Floor

Approx. 60.8 sq. metres (654.5 sq. feet)

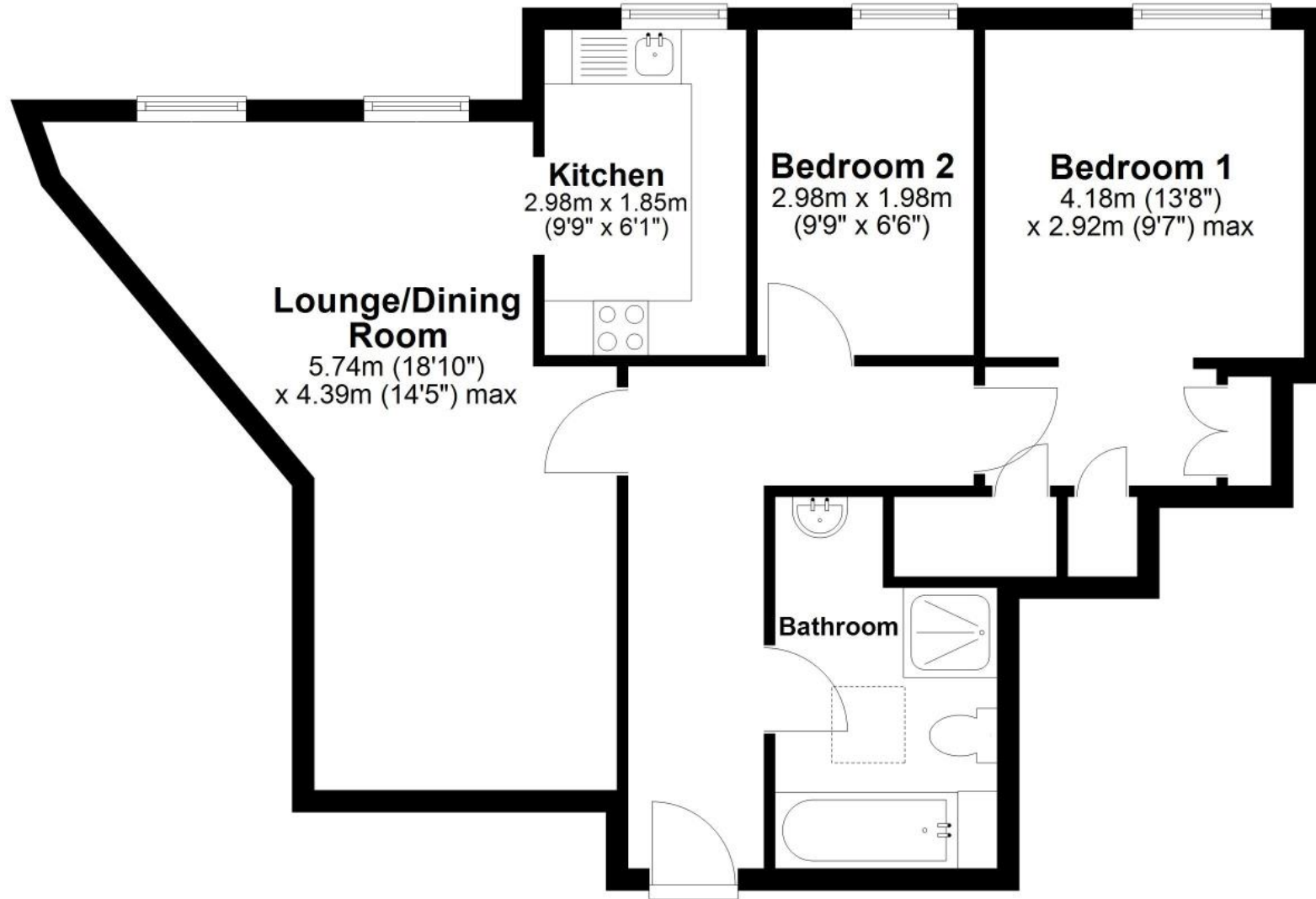

Total area: approx. 60.8 sq. metres (654.5 sq. feet)