



**Peregrine Way, Hatfield AL10 9UP**



**welcome to**

## **Peregrine Way, Hatfield**

This fantastic end of terrace two bedroom family home resides in a peaceful road in the heart of Hatfield offering easy access to Hatfield train station with great links to London and popular commuter links via the A414 & A1(M). Internally on the ground floor the property comprises of entrance hall, cloakroom, open plan lounge/diner with French doors to the garden and kitchen with high quality Schmidt kitchen. Upstairs offers two double bedrooms, en suite and family bathroom. Externally the property offers off street parking, EV car charger and a well maintained rear garden. Further benefits include gas central heating and double glazing throughout. \* Potential to extend into the loft STPP\*



### Entrance Hall

Amtico tiles, storage cupboard (with boiler).

### Cloakroom

Amtico tiles, W/C, wash hand basin, radiator, cupboard.

### Lounge

17' 4" x 12' 10" ( 5.28m x 3.91m )

Laminate wood flooring, 2 x radiators, French doors to garden.

### Kitchen

8' 5" x 6' 1" ( 2.57m x 1.85m )

Amtico tiles, double glazed windows to front, Schmidt kitchen, Bosch Series 6 microwave/oven/grill, oven, dishwasher, induction hob, Bosch Series 8 washing machine, Samsung fridge freezer.

### Bedroom 1

11' 10" x 11' 1" ( 3.61m x 3.38m )

Double glazed windows to rear, carpet, radiator, storage cupboard, built in wardrobe.

### En-Suite

Shower cubicle, wash hand basin, W/C, tiled flooring, radiator.

### Bedroom 2

12' 11" x 8' 6" ( 3.94m x 2.59m )

Double glazed windows to front, carpet, radiator.

### Bathroom

Tiled flooring, double glazed window to side, W/C, bath, wash hand basin, radiator.

### Agents Note:

Management/Service Charge: £250.00 per annum



**Ground Floor**

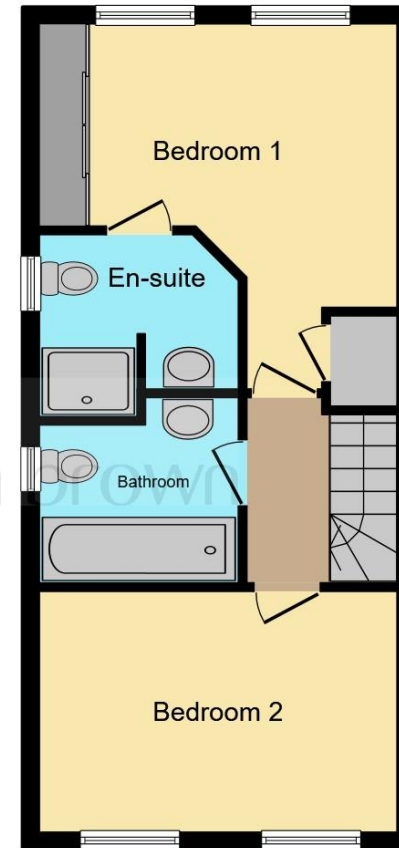

**First Floor**

Total floor area 82.9 sq.m. (893 sq.ft.) approx

This floorplan is for illustrative purposes only and is not drawn to scale. Measurements, floor-areas, openings and orientations are approximate. They should not be relied upon for any purpose and do not form any part of an agreement. No liability is taken for any error or mis-statement. All parties must rely on their own inspections.



**check out more properties at** [williamhbrown.co.uk](http://williamhbrown.co.uk)





**welcome to**

## **Peregrine Way, Hatfield**

- End of Terrace
- Two Bedrooms
- Off Street Parking
- Two Bathrooms & Cloakroom
- High Quality Schmidt Kitchen

Tenure: Freehold EPC Rating: C  
Council Tax Band: D



guide price

**£425,000**



**check out more properties at [williamhbrown.co.uk](http://williamhbrown.co.uk)**



Property Ref:  
WGN109500 - 0004

1. MONEY LAUNDERING REGULATIONS Intending purchasers will be asked to produce identification documentation at a later stage and we would ask for your co-operation in order that there is no delay in agreeing the sale. 2. These particulars do not constitute part or all of an offer or contract. 3. The measurements indicated are supplied for guidance only and as such must be considered incorrect. Potential buyers are advised to recheck measurements before committing to any expense. 4. We have not tested any apparatus, equipment, fixtures or services and it is in the buyers interest to check the working condition of any appliances. 5. Where an EPC, or a Home Report (Scotland only) is held for this property, it is available for inspection at the branch by appointment. If you require a printed version of a Home Report, you will need to pay a reasonable production charge reflecting printing and other costs. 6. We are not able to offer an opinion either written or verbal on the content of these reports and this must be obtained from your legal representative. 7. Whilst we take care in preparing these reports, a buyer should ensure that his/her legal representative confirms as soon as possible all matters relating to title including the extent and boundaries of the property and other important matters before exchange of contracts.

William H Brown is a trading name of Sequence (UK) Limited which is registered in England and Wales under company number 4268443, Registered Office is Cumbria House, 16-20 Hockliffe Street, Leighton Buzzard, Bedfordshire, LU7 1GN. VAT Registration Number is 500 2481 05.

  
**william h brown**



**01707 324361**



[WelwynGardenCity@williamhbrown.co.uk](mailto:WelwynGardenCity@williamhbrown.co.uk)



53 Wigmores North, WELWYN GARDEN CITY,  
Hertfordshire, AL8 6PG



**[williamhbrown.co.uk](http://williamhbrown.co.uk)**

Please note the marker reflects the  
postcode not the actual property