



Victoria Road, Stocksbridge, Sheffield, S36 1FX

Offers In Region Of £190,000

🛏️ 2 🚿 1 🚗 1



A beautifully presented two bedroom end-terrace home with off-road parking, set on a generous plot for a property of this type and offered freehold.

Situated on Victoria Road, this attractive home offers well-balanced accommodation arranged over two floors and is ideal for first-time buyers looking for a property ready to move straight into.

The ground floor features a bright living room alongside a spacious eat-in kitchen, creating practical and sociable living space suited to modern lifestyles.

To the upper floor are two well-proportioned bedrooms, including a generous principal bedroom, complemented by a modern bathroom. An additional room provides excellent flexibility for use as a small bedroom, home office or dressing space.

Externally, the property benefits from off-road parking, a real advantage for a terrace, and occupies a good-sized plot for this style of home, providing pleasant outdoor space without being high maintenance.

Being sold freehold and presented to a high standard throughout, this is a fantastic opportunity for first-time buyers or those looking to step onto the property ladder.

Early viewing is highly recommended.



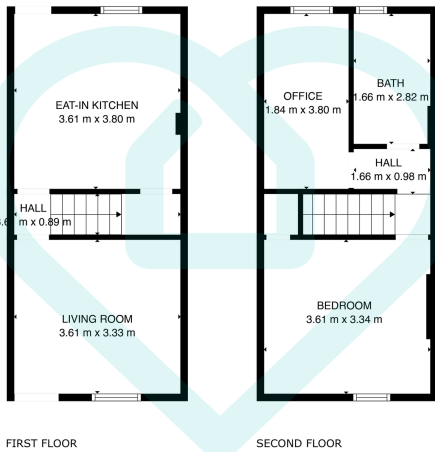

FIRST FLOOR SECOND FLOOR
TOTAL: 60 m²
 FIRST FLOOR: 39 m², SECOND FLOOR: 30 m²
 EXCLUDED AREAS: WALLS: 4 m²

This floor plan is for illustrative purposes only. All measurements and layouts are approximations and do not necessarily capture the precise specifications of the property. No responsibility is taken for any error, omission, or misstatement. We always recommend viewing in person to confirm the exact floor plan of a property. Made with Metropix.



- Two bedroom end-terrace home
- Off-road parking
- Beautifully presented throughout
- Bright living room
- Ideal for first-time buyers
- Freehold property
- Generous plot for a terrace
- Spacious eat-in kitchen
- Modern bathroom
- Convenient Stocksbridge location

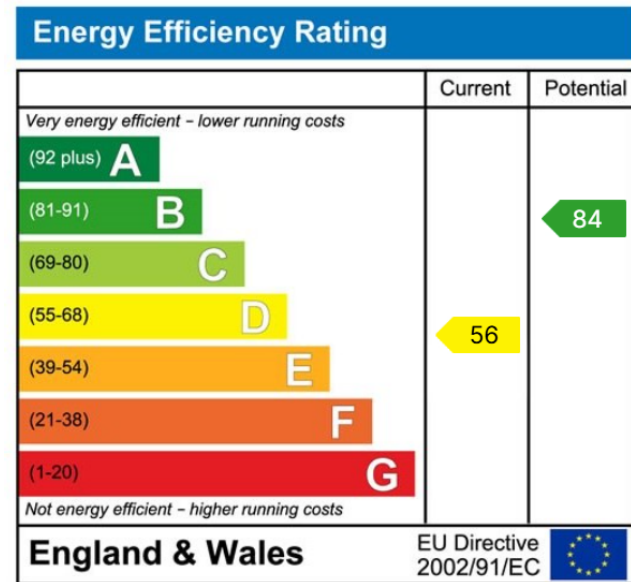

Sales | Lettings | New Homes

VAT Reg Number: 191 3588 84
 Company Reg Number: 08610489
 Company Reg Address: 67 Middlewood Road, Hillsborough, Sheffield, S6 4GX.

The MorfittSmith Building
 67 Middlewood Road
 Hillsborough
 Sheffield
 S6 4GX

Get in touch - arrange an appointment



0114 232 1764
 sales@morfittsmith.co.uk
 lettings@morfittsmith.co.uk
 newhomes@morfittsmith.co.uk
 www.morfittsmith.co.uk



@MorfittSmith
 @MorfittSmith
 MorfittSmith
 Estate & Letting Agent