



Tintern Road, Maidstone, ME16 0RJ

- Chain Free
- Two generous double sized bedroom
- Desirable location
- Spacious living and dining area
- Garage
- Close to transport links

Guide Price £285,000



Tintern Road, Maidstone, ME16 0RJ

DESCRIPTION

Nestled on the charming Tintern Road in Maidstone, this delightful end-terrace house, built in 1968, offers a perfect blend of comfort and convenience. With two spacious bedrooms, this property is ideal for small families, couples, or individuals seeking a peaceful retreat.

As you enter, you are welcomed by a generous living room and dining area, providing ample space for relaxation and entertaining guests. The layout is designed to maximise light and create a warm, inviting atmosphere.

The property also includes a well-appointed bathroom, ensuring all your essential needs are met. For those with vehicles, you have the added benefit of a garage, providing extra storage or a secure space for your vehicle.

The low-maintenance garden is a wonderful feature, allowing you to enjoy outdoor space without the burden of extensive upkeep.

Located in a desirable area, this home is close to local amenities and transport links, making it a convenient choice for daily living. Whether you are looking to make your first step onto the property ladder or seeking a comfortable rental, this end-terrace house on Tintern Road is a fantastic opportunity not to be missed.

Flood Risk: Very low Each year, there is a chance of flooding of less than 1 in 1000 (0.1%)

Services: Mains Gas and Electric

Average Broadband Speed: Ultrafast AND Superfast broadband is available in this area. Max Download and Upload: 10000 Mbps





GROUND FLOOR

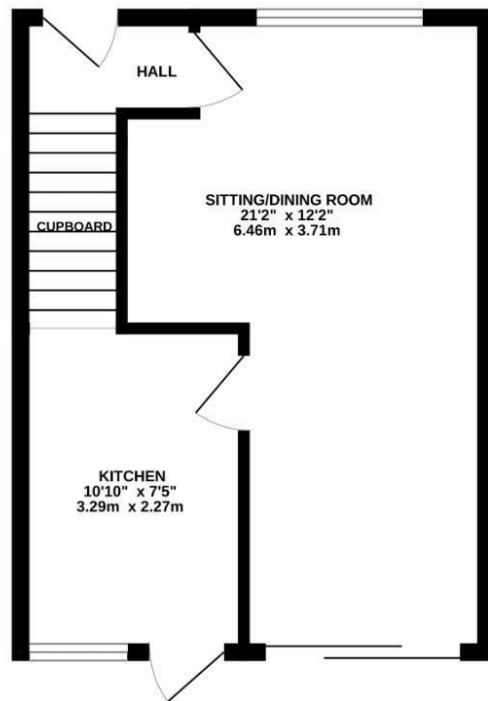

1ST FLOOR

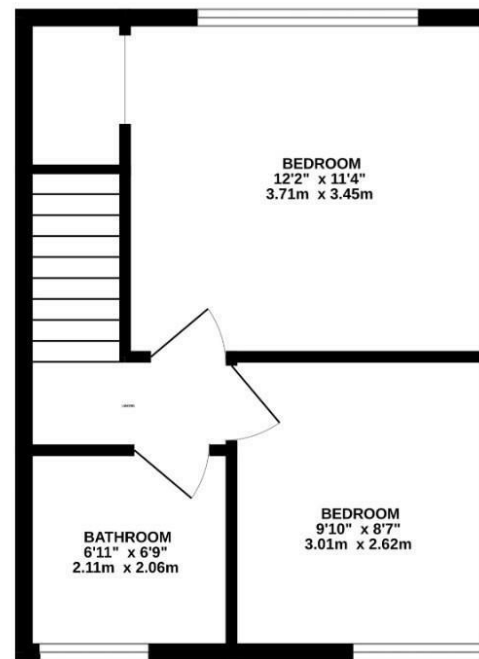

Whilst every attempt has been made to ensure the accuracy of the floorplan contained here, measurements of doors, windows, rooms and any other items are approximate and no responsibility is taken for any error, omission or mis-statement. This plan is for illustrative purposes only and should be used as such by any prospective purchaser. The services, systems and appliances shown have not been tested and no guarantee as to their operability or efficiency can be given.
Made with Metropix ©2026

Viewings

Please contact Maidstone@hunters.com, if you wish to arrange a viewing appointment for this property or require further information.

Valuations

For a valuation of your property, please email the team with your property details, contact information and the times you are available.

ENERGY PERFORMANCE CERTIFICATE

The energy efficiency rating is a measure of the overall efficacy of a home. The higher the rating the more energy efficient the home is and the lower the fuel bills will be.

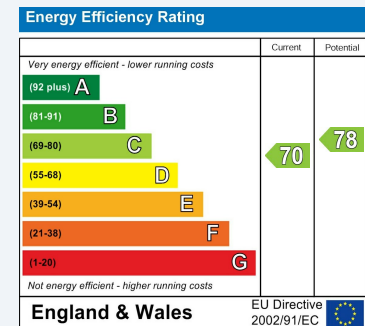

These particulars are intended to give a fair and reliable description of the property but no responsibility for any inaccuracy or error can be accepted and do not constitute an offer or contract. We have not tested any services or appliances (including central heating if fitted) referred to in these particulars and the purchasers are advised to satisfy themselves as to the working order and condition. If a property is unoccupied at any time there may be reconnection charges for any switched off/disconnected or drained services or appliances - All measurements are approximate.

THINKING OF SELLING? If you are thinking of selling your home or just curious to discover the value of your property, Hunters would be pleased to provide free, no obligation sales and marketing advice. Even if your home is outside the area covered by our local offices we can arrange a Market Appraisal through our national network of Hunters estate agents.