

New Street

Measham, Swadlincote, DE12 7JN



Positioned within a small row of similar properties, this attractive two bedroom home is set far back from the road with a neat approach, dedicated parking to the rear for two to three vehicles, a good size south-westerly facing rear garden and a practical layout. Ideal for first time buyers. No chain.

Price range £170,000 - £175,000

John German 

A paved pathway leads to the front entrance, which is sheltered beneath a covered porch. A white UPVC entrance door with glazed panels opens into the welcoming hallway.

The entrance hallway provides a great first impression with access to the living space and stairs leading off, a useful under-stair storage area, dado rail detailing.

The kitchen on your left is fitted with a range of light maple effect fronted units complemented by light grey work surfaces and tiled splashbacks. There is integral gas hob with oven beneath, space for washing machine and slim line dishwasher, a freestanding tall fridge freezer and there is a stainless steel sink unit with mixer tap and window above overlooking the front aspect.

The lounge diner provides a bright and comfortable living space with laminate flooring, feature fireplace and plenty of room for both seating and dining furniture if required. A large glazed door and adjoining window open directly onto the rear garden, allowing plenty of natural light into the room and creating a pleasant connection with the outside space.

Stairs rise to the first floor landing where there is access to the loft space, two bedrooms and the family bathroom.

Bedroom one is a generous double bedroom extending across the width of the property, enjoying a pleasant outlook over the rear garden. Bedroom two is positioned to the front of the home with a useful recess ideal for wardrobe placement.

The bathroom is fitted with a traditional white suite comprising panelled bath with wall mounted shower, pedestal wash basin and low level WC, with tiled areas surrounding the main splash zones and an obscure window providing natural light.

Outside, the rear garden is a particular feature of the property, enjoying a south-westerly aspect and benefiting from afternoon and evening sunshine. A patio seating area leads onto a mature garden which is mainly laid to lawn with established flower and shrub borders. A pathway leads to the garden shed, with a secure rear gate providing access to the shared private parking area which is accessed at the end of the row the three houses.

Agents notes: It is common for property Titles to contain Covenants; a copy of the Land Registry Title is available to view on request.

There is a shared access drive to the parking area.

Please note that some images within this brochure may have been virtually staged for marketing purposes. These images are intended to help illustrate the potential use and layout of the accommodation and may include digitally added furniture or furnishings. It is quite common for some properties to have a Ring doorbell and internal recording devices.

Tenure: Freehold (purchasers are advised to satisfy themselves as to the tenure via their legal representative).

Property construction: Standard

Parking: Shared parking area

Electricity supply: Mains

Water supply: Mains

Sewerage: Mains

Heating: Gas

(Purchasers are advised to satisfy themselves as to their suitability).

Broadband type: See Ofcom link for speed: <https://checker.ofcom.org.uk/>

Mobile signal/coverage: See Ofcom link <https://checker.ofcom.org.uk/>

Local Authority/Tax Band: North West Leicestershire District Council / Tax Band A

Useful Websites: www.gov.uk/government/organisations/environment-agency

Our Ref: JGA/02072026

The property information provided by John German Estate Agents Ltd is based on enquiries made of the vendor and from information available in the public domain. If there is any point on which you require further clarification, please contact the office and we will be pleased to check the information for you, particularly if contemplating travelling some distance to view the property. Please note if your enquiry is of a legal or structural nature, we advise you to seek advice from a qualified professional in their relevant field.

We are required by law to comply fully with The Money Laundering Regulations 2017 and as such need to complete AML ID verification and proof / source of funds checks on all buyers and, where relevant, cash donors once an offer is accepted on a property. We use the Checkboard app to complete the necessary checks, this is not a credit check and therefore will have no effect on your credit history. With effect from 1st March 2025 a non-refundable compliance fee of £30.00 inc. VAT per buyer / donor will be required to be paid in advance when an offer is agreed and prior to a sales memorandum being issued.

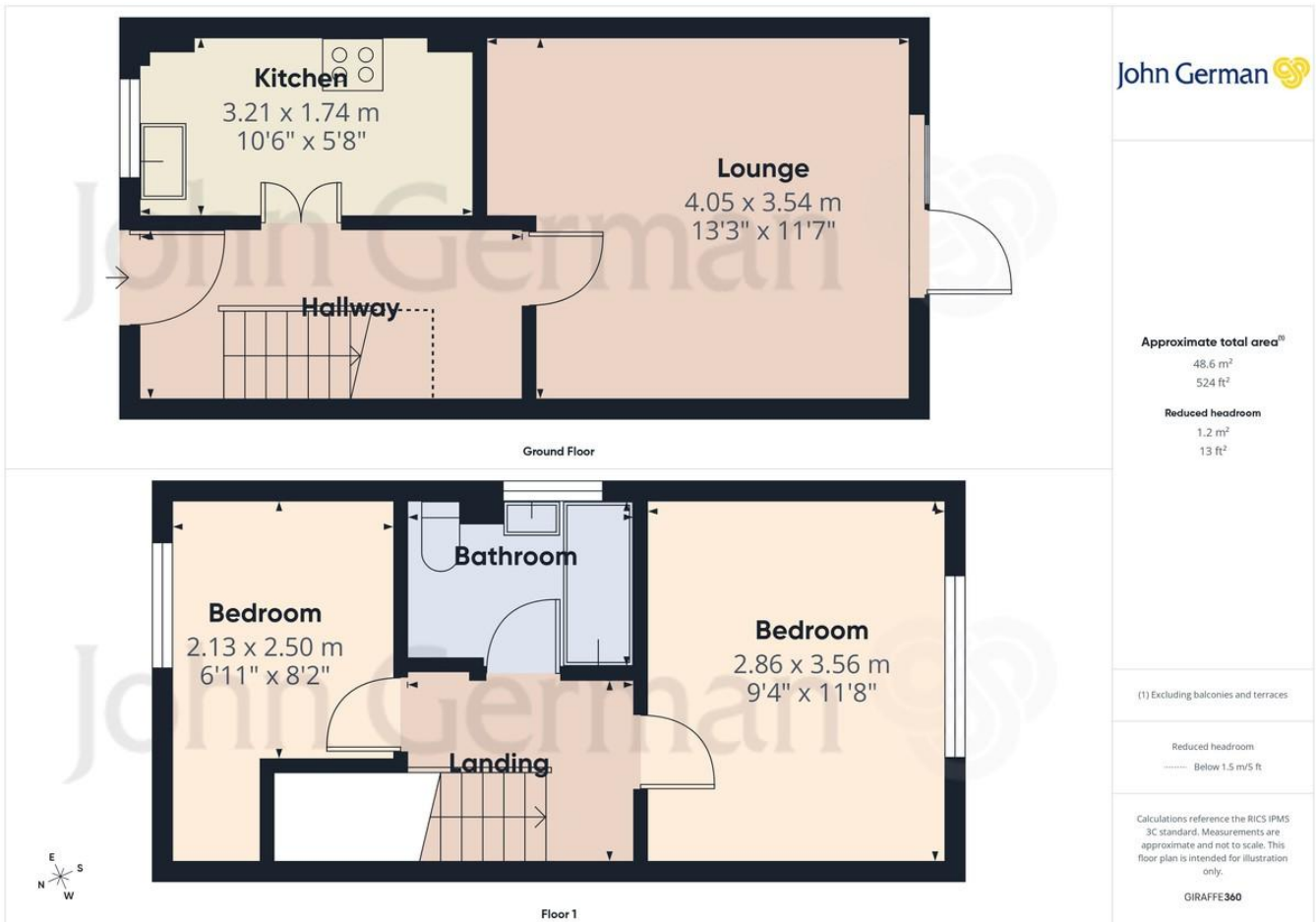





Score	Energy rating	Current	Potential
92+	A		
81-91	B		91 B
69-80	C	76 C	
55-68	D		
39-54	E		
21-38	F		
1-20	G		

 OnTheMarket

 rightmove

 RICS

 arta
propertymark
PROTECTED

 naea
propertymark
PROTECTED

 The Property
Ombudsman

 tsj
APPROVED CODE
TRADING STANDARDS UK

John German

63a Market Street, Ashby-De-La-Zouch, Leicestershire,
LE65 1AH

01530 412824

ashbysales@johngerman.co.uk

Agents' Notes

These particulars do not constitute an offer or a contract neither do they form part of an offer or contract. The vendor does not make or give and Messrs. John German nor any person employed has any authority to make or give any representation or warranty, written or oral, in relation to this property. Whilst we endeavour to make our sales details accurate and reliable, if there is any point which is of particular importance to you, please contact the office and we will be pleased to check the information for you, particularly if contemplating travelling some distance to view the property. None of the services or appliances to the property have been tested and any prospective purchasers should satisfy themselves as to their adequacy prior to committing themselves to purchase.

Referral Fees

Mortgage Services - We routinely refer all clients to APR Money Limited. It is your decision whether you choose to deal with APR Money Limited. In making that decision, you should know that we receive on average £60 per referral from APR Money Limited.

Conveyancing Services - If we refer clients to recommended conveyancers, it is your decision whether you choose to deal with this conveyancer. In making that decision, you should know that we receive on average £150 per referral.

Survey Services - If we refer clients to recommended surveyors, it is your decision whether you choose to deal with this surveyor. In making that decision, you should know that we receive up to £90 per referral.

Ashbourne | Ashby de la Zouch | Barton under Needwood
Burton upon Trent | Derby | East Leake | Lichfield
Loughborough | Stafford | Uttoxeter

JohnGerman.co.uk Sales and Lettings Agent