



Rose Avenue, Costessey, Norwich, NR8 5EX

welcome to

Rose Avenue, Costessey, Norwich

This beautifully presented home is new to the market, ideally situated in the highly sought-after location of NR8. A fantastic opportunity for first-time buyers, the property provides a blend of comfort, modern living and practicality.



Description

This beautifully presented home is an ideal first-time purchase. The ground floor welcomes you into a spacious, well-proportioned lounge, an inviting living space ideal for both relaxing and entertaining friends and family. The kitchen is fitted with a range of wall and base units, offering ample of storage and preparation space, a well laid out kitchen to suit everyday living. A ford from the kitchen leads directly into the rear garden, creating a flow between indoor and outdoor spaces. The ground floor further benefits from the convenience of a downstairs WC

Upstairs, the first floor compromises a main bedroom completed with a range of fitted storage, providing practicality. A second bedroom, which is versatile in use, ideal for a guest room, dressing room, nursery or home office, depending on your needs. Completing the accommodation is partially tiled bathroom with a fitted suite.

Externally the garden, which is mainly laid to lawn, offers a pleasant outdoor space. Which is completed with a shed.

The home is located in the popular area of NR8, Costessey. benefitting from local supermarkets, schools, doctors. Also benefitting from regular transport links.

A perfect opportunity for a first time buyer!

Auctioneer's Comments

This property is offered through Modern Method of Auction. Should you view, offer or bid your data will be shared with the Auctioneer, iamsold Limited. This method requires both parties to complete the transaction within 56 days, allowing buyers to proceed with mortgage finance (subject to lending criteria, affordability and survey). The buyer is required to sign a reservation agreement and make payment of a non-refundable Reservation Fee of 4.5% of the purchase price including VAT, subject to a minimum of £6600.00 including VAT. This fee is paid in addition to purchase price and will be considered as part of the chargeable consideration for the property in the calculation for stamp duty liability. Buyers will be required to complete an identification process with iamsold and provide proof of how the purchase would be funded. The property has a Buyer Information Pack containing documents about the property. The documents may not tell you everything you need to know, so you must complete your own due diligence before bidding. A sample of the Reservation Agreement and terms and conditions are contained within this pack. The buyer will also make payment of no more than £349 inc. VAT towards the preparation cost of the pack. Please confirm exact costs with the auctioneer. The estate agent and auctioneer may recommend the services of other providers to you, in which they will be paid for the referral. These services are optional, and you will be advised of any payment, in writing before any services are accepted. Listing is subject to a start price and undisclosed reserve price that can change.

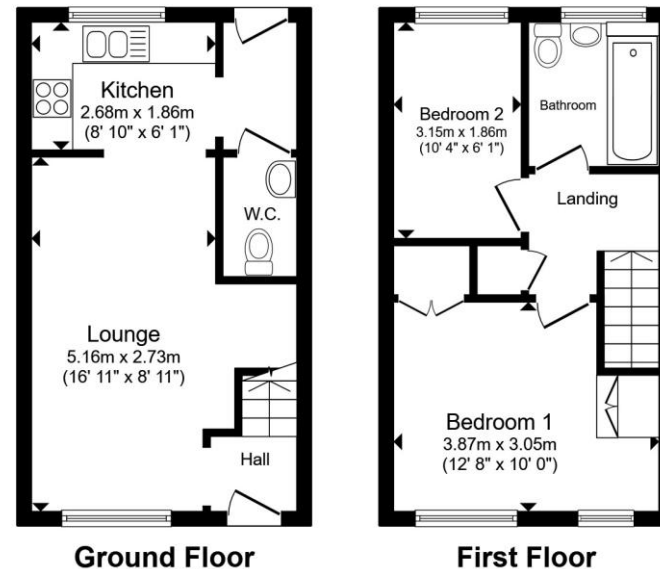

Total floor area 55.0 m² (592 sq.ft.) approx

This floor plan is for illustrative purposes only. It is not drawn to scale. Any measurements, floor areas (including any total floor area), openings and orientation are approximate. No details are guaranteed, they cannot be relied upon for any purpose and they do not form part of any agreement. No liability is taken for any error, omission or misstatement. A party must rely upon its own inspection(s). Powered by www.propertybox.io

william
brown



view this property online williambrown.co.uk/Property/NOR144549



welcome to

Rose Avenue, Costessey, Norwich

- Sale by Modern Auction (T&Cs apply)
- Subject to an undisclosed Reserve Price
- Buyers' fees apply
- Ideal first time home!
- Allocated parking space
- Private, enclosed rear garden
- End terrace

Tenure: Freehold EPC Rating: Awaited
Council Tax Band: B

guide price

£180,000



Please note the marker reflects the
postcode not the actual property

view this property online [williamhbrown.co.uk/Property/NOR144549](https://www.williamhbrown.co.uk/Property/NOR144549)



Property Ref:
NOR144549 - 0002

1. MONEY LAUNDERING REGULATIONS Intending purchasers will be asked to produce identification documentation at a later stage and we would ask for your co-operation in order that there is no delay in agreeing the sale. 2. These particulars do not constitute part or all of an offer or contract. 3. The measurements indicated are supplied for guidance only and as such must be considered incorrect. Potential buyers are advised to recheck measurements before committing to any expense. 4. We have not tested any apparatus, equipment, fixtures or services and it is in the buyer's interest to check the working condition of any appliances. 5. Where an EPC, or a Home Report (Scotland only) is held for this property, it is available for inspection at the branch by appointment. If you require a printed version of a Home Report, you will need to pay a reasonable production charge reflecting printing and other costs. 6. We are not able to offer an opinion either written or verbal on the content of these reports and this must be obtained from your legal representative. 7. Whilst we take care in preparing these reports, a buyer should ensure that his/her legal representative confirms as soon as possible all matters relating to title including the extent and boundaries of the property and other important matters before exchange of contracts.

William H Brown is a trading name of Sequence (UK) Limited which is registered in England and Wales under company number 4268443, Registered Office is Cumbria House, 16-20 Hockliffe Street, Leighton Buzzard, Bedfordshire, LU7 1GN. VAT Registration Number is 500 2481 05.



william h brown



01603 760044



norwich@williamhbrown.co.uk



5 Bank Plain, NORWICH, Norfolk, NR2 4SF



[williamhbrown.co.uk](https://www.williamhbrown.co.uk)