

FREEHOLD



House - Semi-Detached

35 SANDRINGHAM DRIVE, WELLING, DA16 3QU

Asking price

£525,000

FEATURES

- Three Bedroom Semi-Detached Family Home
- Newly Fitted Carpets and Redecorated Throughout
- Two Separate Reception Rooms
- Large Extended Kitchen With Access To Rear Garden
- South-Facing Rear Garden
- Driveway To Front For Two Cars



3 Bedroom House - Semi-Detached located in Welling

Having been REDECORATED through out we are delighted to offers this stunning three bedroom semi-detached family home on the popular Sandringham Drive, Welling. Offered with NO FORWARD CHAIN the home comprises entrance porch and hall, living room measuring 14'4 x 11'7, second reception room which could be used as a dining room, modern fitted extended kitchen with access to the rear garden, ground floor four piece bathroom suite, three good sized first floor bedrooms and the family bathroom suite. Externally there is a SOUTH-FACING rear garden with a patio area and laid to lawn and to the front there is a driveway with parking for two cars. Additional points to note include double glazing and gas central heating.

Call us on

020 8301 5511

sales@westwoodpropertyservices.co.uk

Council Tax Band

D

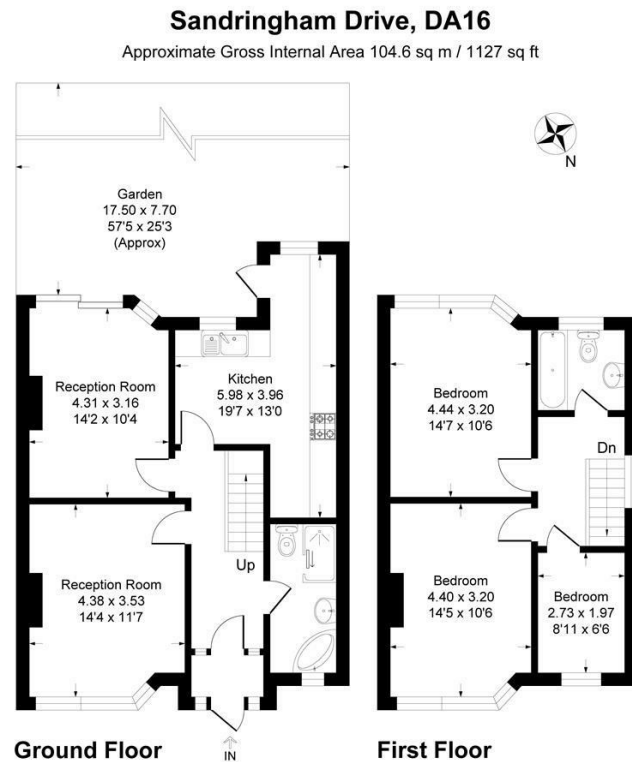

This plan is for layout guidance only. Not drawn to scale unless stated. Windows and door openings are approximate. Whilst every care is taken in the preparation of this plan, please check all dimensions, shapes and compass bearings before making any decisions reliant upon them.
Produced By Planpix

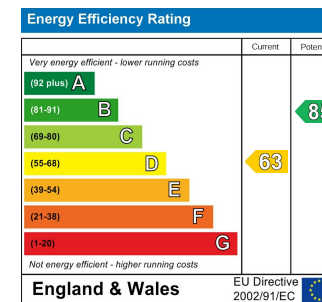

Agents Note: Whilst every care has been taken to prepare these particulars, they are for guidance purposes only. All measurements are approximate and are for general guidance purposes only and whilst every care has been taken to ensure their accuracy, they should not be relied upon and potential buyers are advised to recheck the measurements.

