

The Waterside Apartments
Pavilion Road
West Bridgford
Nottingham
NG2 5PL

Guide Price £725,000



- No upward chain!
- Open plan kitchen/ living/ diner
- Sought-after West Bridgford location
- Concierge and allocated parking
- Service Charge - £5463.20 PA & Ground Rent - £250 PA
- Exceptional duplex three-bedroom penthouse apartment
- Stunning views over the River Trent
- Close to local amenities and transport links
- Viewing essential!
- Tenure - Leasehold - 243 Years Remaining

 0115 841 1155

Pavilion Road, West Bridgford, Nottingham, NG2 5PL

Key Features

Occupying a prestigious position in one of West Bridgford's most desirable riverside developments, this exceptional penthouse apartment offers luxurious accommodation arranged over two floors, with stunning views across the River Trent and Nottingham's iconic sporting landmarks.

Perfectly situated within walking distance of the world-renowned Forest Ground, Trent Bridge Cricket Ground and Meadow Lane, home of Notts County FC, the property also enjoys easy access to the vibrant centre of West Bridgford, Nottingham City Centre and excellent transport links, making it ideal for professionals, families and those seeking a premium lifestyle location.

Accessed via a secure communal entrance with intercom entry system and benefiting from a concierge service, the apartment immediately impresses with its generous proportions and high-quality finish throughout.

The lower level is centred around a spectacular open-plan kitchen, living and dining area, designed for modern living and entertaining. Floor-to-ceiling glazing and doors open onto a private balcony overlooking the River Trent, providing a breathtaking backdrop and an abundance of natural light. The contemporary kitchen is fitted with a comprehensive range of units and integrated appliances, while a separate utility room and convenient downstairs WC complete this floor.

To the upper level, the accommodation continues to impress with three generously sized bedrooms. Two of the bedrooms benefit from their own en-suite facilities, while the luxurious principal suite offers a truly outstanding retreat. The impressive en-suite bathroom features a separate free-standing bath perfectly positioned to enjoy stunning river views, creating a spa-like atmosphere within the home.

In addition, there is a versatile fourth room which could be utilised as a guest bedroom, dressing room, walk-in wardrobe, home office or nursery, offering flexibility to suit a variety of lifestyles.

Externally, the property benefits from allocated parking and well-maintained communal areas, whilst residents enjoy the added convenience and security of concierge and intercom services.

Combining exceptional riverside views, spacious accommodation, luxury finishes and an unrivalled location in the heart of West Bridgford, this remarkable penthouse apartment represents a rare opportunity to acquire one of the area's most impressive homes.



Pavilion Road, West Bridgford, Nottingham, NG2 5PL

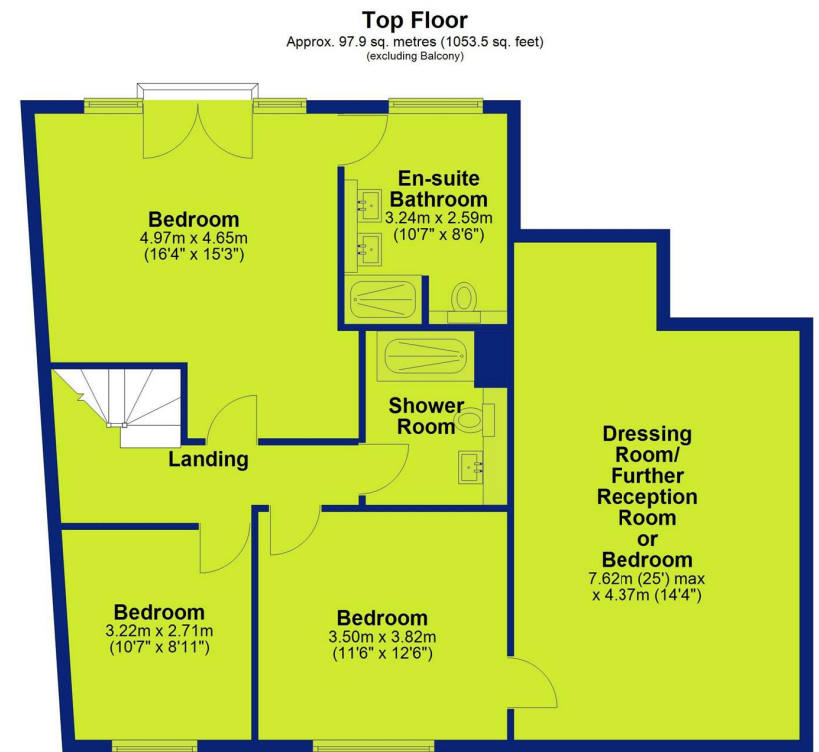

Total area: approx. 153.5 sq. metres (1652.6 sq. feet)



0115 841 1155

Pavilion Road, West Bridgford, Nottingham, NG2 5PL



Interested in this home?

Contact the FHP Living Team on 0115 841 1155

23 Bridgford Road
West Bridgford
Nottingham
NG2 6AU

1 Weekday Cross
The Lace Market
Nottingham
NG1 2GB

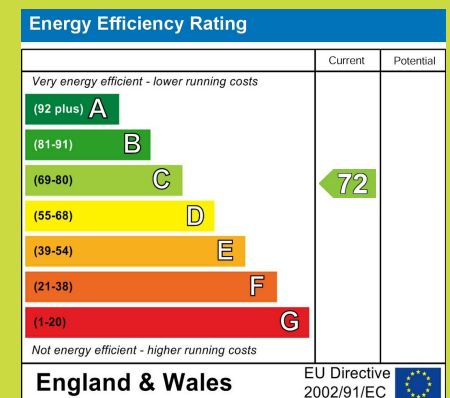

These sales particulars have been prepared by FHP Living on the instruction of the vendor. Services, equipment and fittings mentioned in these particulars have NOT been tested, and as such, no warranties can be given. Prospective purchasers are advised to make their own enquiries regarding such matters. These sales particulars are produced in good faith and are not intended to form part of a contract. Whilst FHP Living have taken care in obtaining internal measurements, they should only be regarded as approximate.

Purchaser information - Under the Protecting Against Money Laundering and the Proceeds of Crime Act 2002, FHP Living require any successful purchasers proceeding with a purchase to provide two forms of identification i.e. passport or photocard driving license and a recent utility bill. This evidence will be required prior to FHP Living instructing solicitors in the purchase or the sale of a property.