



10 Chailey Place, Pump Lane, Hayes, UB3 3FG  
£300,000

1 1 1 B





10 Chailey Place, Pump Lane, Hayes, UB3 3FG

**£300,000**

- Over 600 Sq Ft
- Very Close Proximity To Elizabeth Line
- Over 900 Year Lease
- Secure CCTV Entry System
- Private Outdoor Space
- Modern Build With Contemporary Appeal
- Strong EPC Rating
- Excellent Condition Throughout
- Versatile One Bedroom Layout
- Ready To View

## Description

This property offers an excellent opportunity for first-time buyers seeking a delightful home.

This well-presented house features a spacious double bedroom, providing a comfortable retreat for relaxation, a modern bathroom, the heart of the home is the bright and airy reception/dining room, which creates a welcoming atmosphere. This space seamlessly integrates with a fitted kitchen, and grants access to the balcony.

## Situation

Carpenter House situated on Pump Lane is a prime location in the heart of Hayes being close to a number of local amenities including the town centre with a number of local shops, cafes, takeaways and coffee shops. Hayes and Harlington station with the Elizabeth line is just moments away making the journey into central London a breeze. Along with the bus station providing several routes to the local surrounding area. A number of highly regarded schools within the local area including Harlington school and Botwell House Catholic primary school.





## Floor Plans

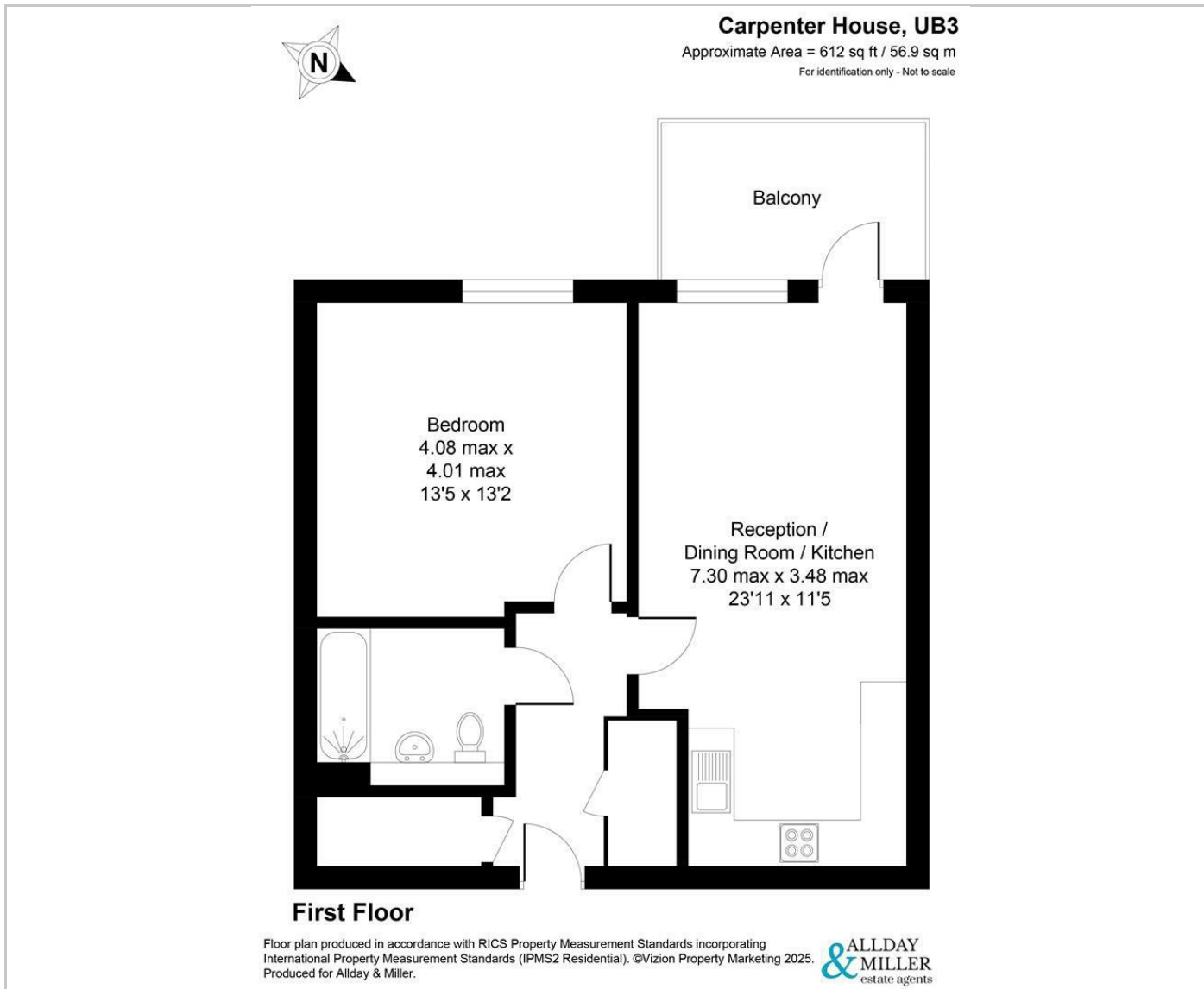

## Area Map

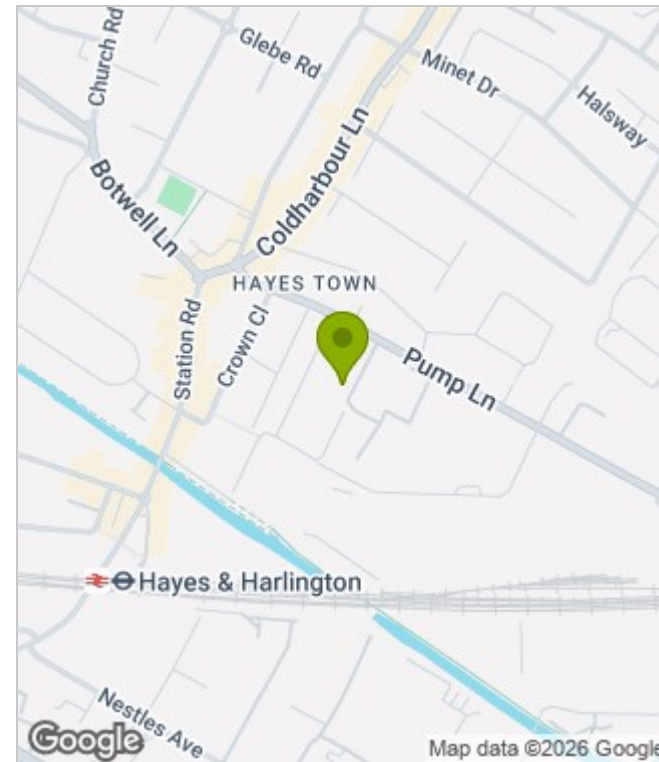

## Energy Performance Graph

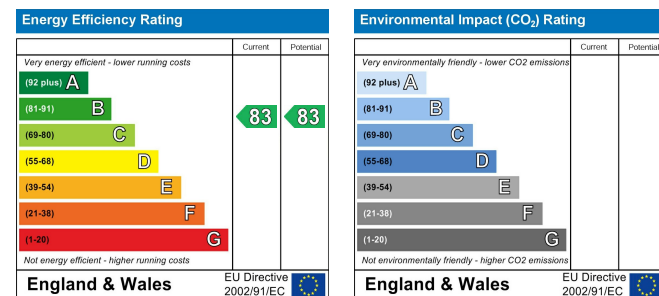

These particulars, whilst believed to be accurate are set out as a general outline only for guidance and do not constitute any part of an offer or contract. Intending purchasers should not rely on them as statements of representation of fact, but must satisfy themselves by inspection or otherwise as to their accuracy. No person in this firm's employment has the authority to make or give any representation or warranty in respect of the property.