



31 Oaklands Manor

Le Mont De La Rosiere



31 Oaklands Manor, Le Mont De La Rosiere, St Saviour, JE2 7XL

Set in the most beautiful grounds, Oaklands Manor would make a fantastic home. Ideal location, situated in Victoria Village with a bus stop at the entrance offering easy access into town.

Providing a blissful setting, the immaculate gardens have a delightful orangery, walking paths and plenty of seating areas. The manor is not short of activities with a bowling green, communal lounge/dining room with kitchen facilities, games room, craft room and library; and organised entertainment functions.

Modernised throughout the second floor (lift access), south facing apartment briefly comprises a sitting/dining room over looking the superb gardens, separate kitchen, 2 double bedrooms and bathroom (with walk in shower). The property also benefits from one parking space and plenty of visitors parking.

Opportunity not to be missed, to acquire an apartment in this exclusive over 50's manor.



Parish: St Saviour

Qualification: Qualified

Tenure: Share Transfer

Price £510,000



- Over 50`s development
- 2 Bedrooms, immaculate throughout
- Set within beautiful grounds
- On-site leisure facilities
- Views overlooking manicured gardens
- Parking and ample visitor space









SECOND FLOOR
684 sq.ft. (63.5 sq.m.) approx.

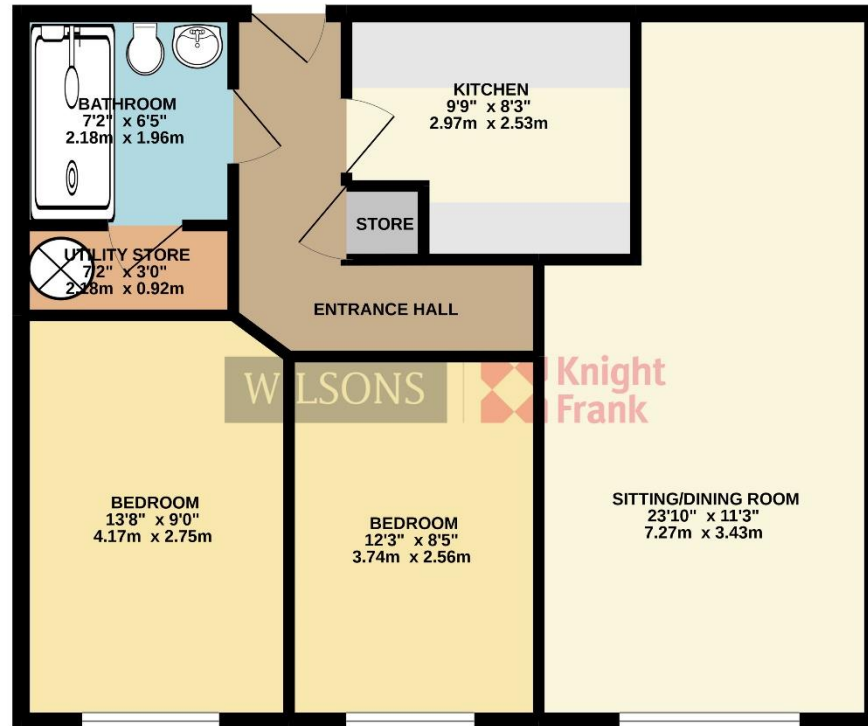

TOTAL FLOOR AREA: 684 sq.ft. (63.5 sq.m.) approx.

Whilst every attempt has been made to ensure the accuracy of the floorplan contained here, measurements of doors, windows, rooms and any other items are approximate and no responsibility is taken for any error, omission or mis-statement. This plan is for illustrative purposes only and should be used as such by any prospective purchaser. The services, systems and appliances shown have not been tested and no guarantee as to their operability or efficiency can be given.
Made with Metrepro ©2022

This plan is for layout guidance only. Not drawn to scale unless stated. Windows and door openings are approximate. Whilst every care is taken in the preparation of this plan, please check all dimensions, shapes and compass bearings before making any decisions reliant upon them.

Service Charges

£948.66 per quarter to include building insurance, parish rates, cleaning of communal areas, services of an on site caretaker, lift maintenance, window cleaning, garden maintenance and use of facilities.

+441534 877977

Knight Frank Jersey

37-39 Halkett Place, St. Helier, Jersey JE2 4WG

knightfrank.je

Your partners in property

1. Particulars: These particulars are not an offer or contract, nor part of one. You should not rely on statements given by Knight Frank Jersey in the particulars, by word of mouth or in writing (“information”) as being factually accurate about the property, its condition or its value. Neither Knight Frank Jersey nor any joint agent has any authority to make any representations about the property, and accordingly any information given is entirely without responsibility on the part of Knight Frank Jersey. 2. Material Information: Please note that the material information is provided to Knight Frank Jersey by third parties and is provided here as a guide only. While Knight Frank Jersey has taken steps to verify this information, we advise you to confirm the details of any such material information prior to any offer being submitted. If we are informed of changes to this information by the seller or another third party, we will use reasonable endeavours to update this as soon as practical. 3. Photos, Videos etc: The photographs, property videos and virtual viewings etc. show only certain parts of the property as they appeared at the time they were taken. Areas, measurements and distances given are approximate only. 4. Regulations etc: Any reference to alterations to, or use of, any part of the property does not mean that any necessary planning, building regulations or other consent has been obtained. A buyer must find out by inspection or in other ways that these matters have been properly dealt with and that all information is correct. 5. Fixtures and fittings: A list of the fitted carpets, curtains, light fittings and other items fixed to the property which are included in the sale (or may be available by separate negotiation) will be provided by the Seller’s Lawyer. Particulars dated 08/09/2025. All information is correct at the time of going to print.

