



EAST STREET, SE17

£350,000

Three bedrooms
Top floor
Chain free
C. 750 sq. ft
Communal gardens
Lots of light

@marshandparsons
marshandparsons.co.uk

MARSH &
PARSONS



ABOUT THE PROPERTY

A bright and spacious three bedroom apartment set on the top floor of a well-maintained 1930s brick built block, ideally located close to Burgess Park and Elephant & Castle station. The property offers excellent proportions throughout, comprising three double bedrooms, a generous reception room, and a separate kitchen, all flooded with natural light and enjoying leafy views over the communal grounds.

Innis House is perfectly positioned near the Elephant & Castle regeneration area, with excellent transport links including numerous bus routes and night services nearby. East Street Market, Elephant Park, and a wide range of local amenities are all within easy reach.



STEP INSIDE EAST STREET

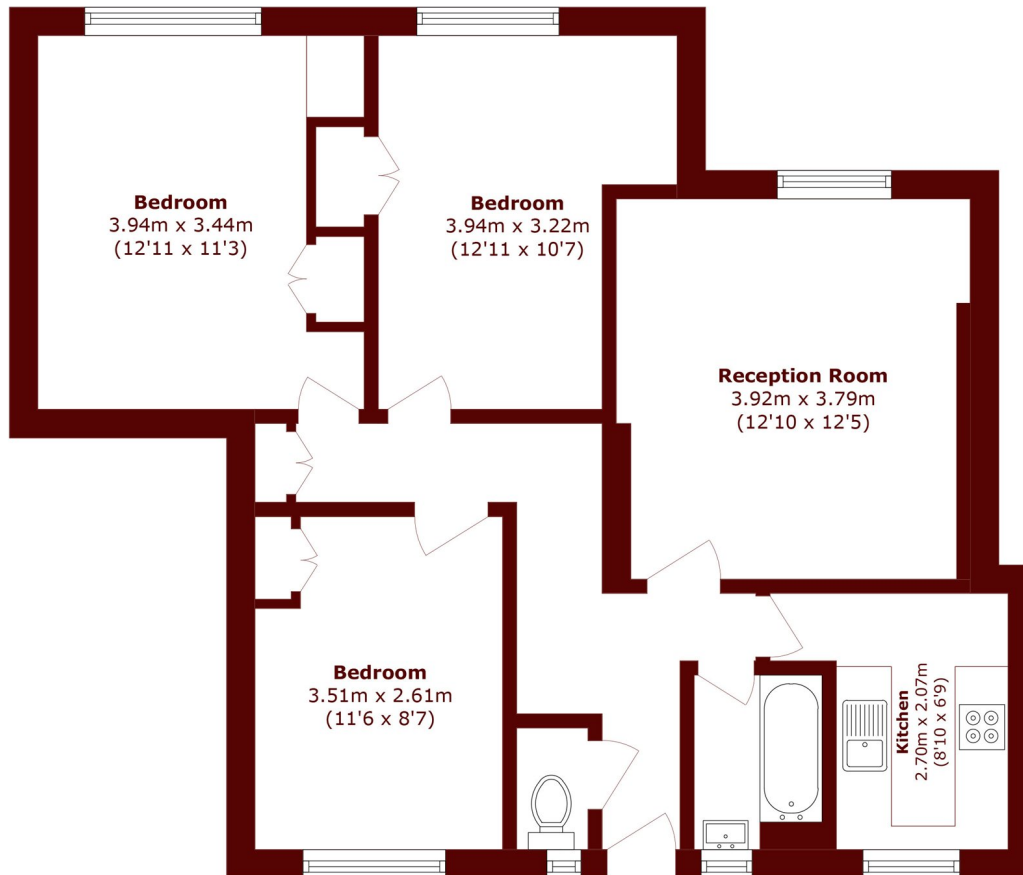

Total area (approx.): 69.4 sq. m (747.0 sq. ft)

Kennington
020 7587 1533

Energy Rating: D We aim to make our particulars both accurate and reliable. However, they are not guaranteed; nor do they form part of an offer or contract. If you require clarification on any points then please contact us, especially if you're traveling some distance to view. Please note that appliances and heating systems have not been tested and therefore no warranties can be given as to their good working order

**MARSH &
PARSONS**