

# JOHN DALE

## Estate Agency

kw POWERED BY  
KELLERWILLIAMS



### **Cowley Drive, Woodingdean, BN2 6TG**

End-of-Terrace house in popular Woodingdean location  
Bright lounge overlooking the rear garden - Delightful West-facing rear garden  
Log cabin with power – ideal office or studio  
Off-road parking - Close to well-regarded primary schools  
Local shops and amenities nearby  
EPC Rating: C

Situated in the ever-popular village of Woodingdean, this wonderful end-of-terrace home offers generous space, excellent local amenities and a beautiful west-facing garden to enjoy the afternoon and evening sun.

The property features two large bedrooms and a well-appointed family bathroom, making it ideal for first-time buyers, young families or those looking to move into this sought-after coastal village. The extended kitchen provides fantastic space for cooking, while the lovely lounge overlooks the rear garden – creating a calm and welcoming living area.

Outside, the delightful west-facing rear garden is a real highlight, perfect for relaxing or entertaining. There is also a superb log cabin with power supply, offering flexibility as a home office, studio, gym or hobby room. To the front, you'll find a lawned garden and the convenience of off-road parking.



Additional benefits include double glazed windows and gas central heating for comfort throughout the year.

Woodingdean is particularly popular with families thanks to its well-regarded primary schools, local shops, cafes and everyday amenities. Excellent public transport links provide easy access into Brighton city centre and towards the coast, while nearby green spaces and the South Downs offer wonderful countryside walks right on your doorstep.

A fantastic opportunity to secure a spacious home in a friendly and well-connected community.



## Ground Floor

Approx. 35.2 sq. metres (378.6 sq. feet)

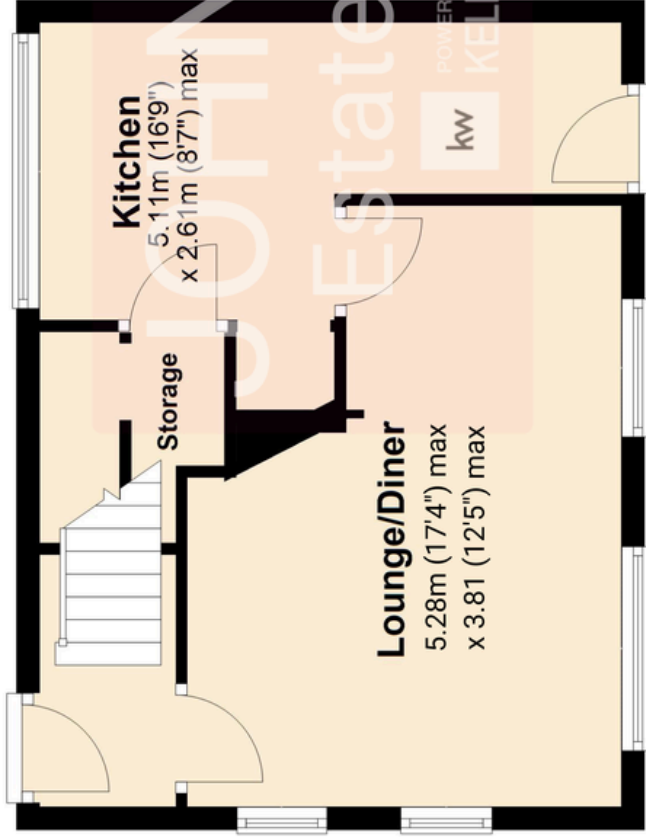

## First Floor

Approx. 35.2 sq. metres (378.6 sq. feet)

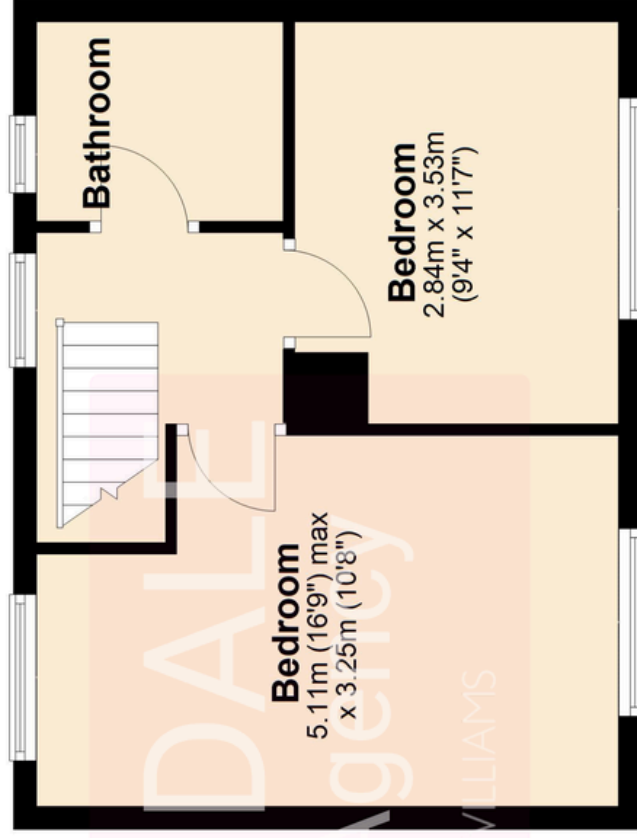

Total area: approx. 70.4 sq. metres (757.3 sq. feet)

**JOHN DALE**  
Estate Agency

