



WAYNE DIGGINS

exp[®] UK

@ wayne.diggins@exp.uk.com

waynediggins.exp.uk.com

07715 925 332

Water Lane, Purfleet-On-Thames, RM19 1GS

Guide Price £250,000

🛏 1 🚿 1 🚗 1



- Beautifully presented one-bedroom mid-terrace home (Quote Ref: WD1273)
- Stylish polished marble-effect tiled flooring
- Contemporary three-piece bathroom suite
- Low-maintenance rear garden with patio and lawn
- Close to Lakeside Shopping Centre
- Guide price £250,000 - £275,000
- Modern fitted kitchen
- Recently fitted front and rear doors (within the last 2 years)
- Allocated parking
- Good transport links to London via Purfleet station



HOME SWEET HOME!!! Quote Ref: WD1273 A beautifully presented one-bedroom mid-terrace starter home, ideally situated on the ever-popular Water Lane in Purfleet-on-Thames. This charming property offers a perfect blend of modern living and convenience, making it an excellent choice for first-time buyers, downsizers, or investors alike. Internally, the home has been thoughtfully updated and well maintained. The ground floor boasts stylish polished marble-effect tiled flooring, creating a bright and contemporary feel throughout the living space. The modern fitted kitchen is both sleek and functional, offering ample storage and workspace for everyday living. Upstairs, you'll find a generously sized bedroom along with a modern three-piece bathroom suite, finished to a high standard. Additional benefits include a recently fitted front and rear door (both within the last two years). Guide price £250,000 - £275,000

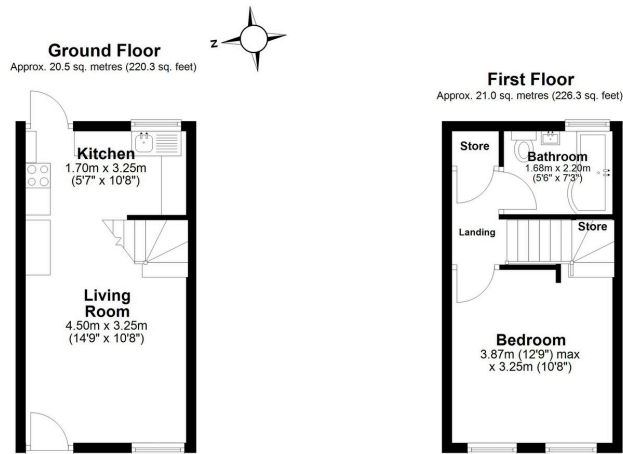

Total area: approx. 41.5 sq. metres (446.6 sq. feet)

This floor plan has been created by a third party and should be used as a general outline for guidance only. Any areas, measurements or distances quoted are approximate and any intending purchaser or lessee should satisfy themselves by inspection, searches, enquiries and/or full survey as to the correctness of each statement. We accept no responsibility or liability for any loss whatsoever that may arise as a result of this plan and the information contained within.

© @moderphoto.uk | www.moderphoto.co.uk
Plan produced using PlanUp...

Water Lane

