



## Central Avenue, SW6

### £800,000

This spacious two bedroom apartment in the sought after Fulham Riverside development offers access to beautiful communal gardens and gym. This is a bright and spacious modern apartment with a private terrace.

Located in a peaceful riverside setting just moments from Chelsea, Central Avenue offers the perfect blend of tranquil living and vibrant city convenience with excellent transport links and on-site amenities.

### Features

- Two Double Bedrooms
- Open Plan
- 24/7 Concierge
- Private Terrace
- Communal Gardens
- Residential Gym

# Central Avenue, London, SW6

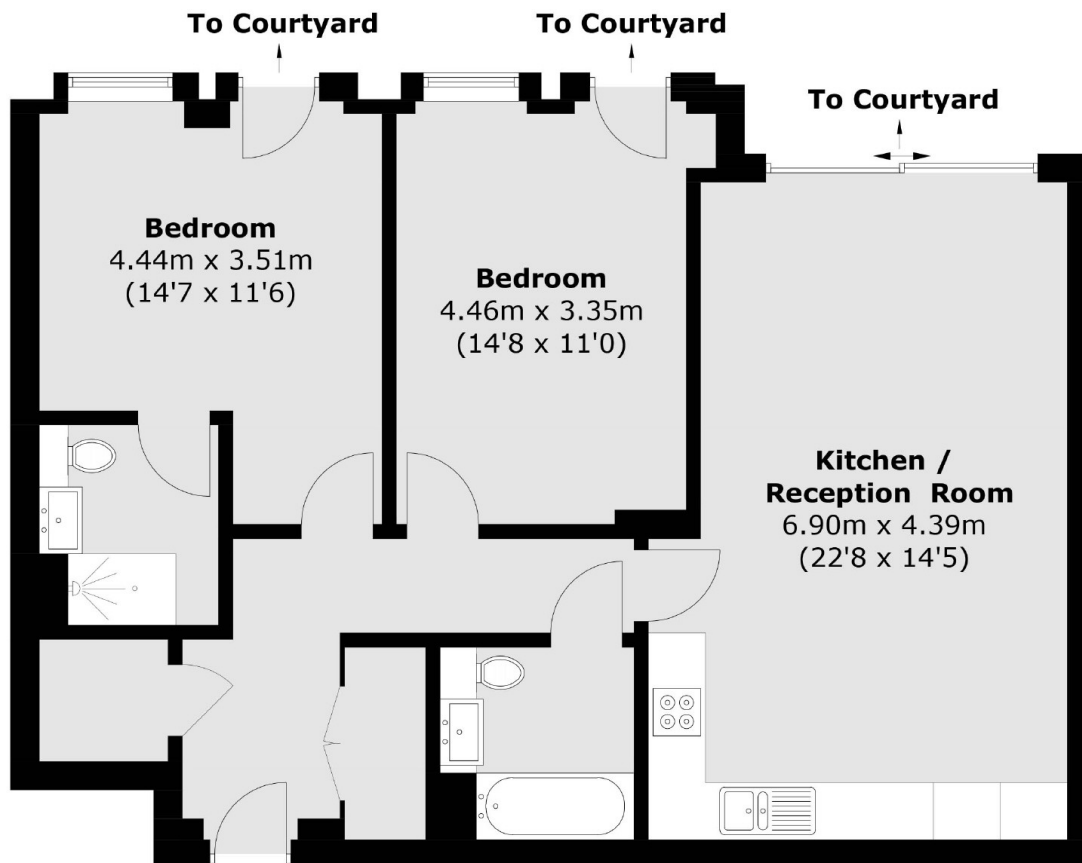

## Fourth Floor

Total area (approx.): 79.4 sq. m (854.6 sq. ft)