



Markhouse Avenue, Walthamstow, London

Situated on the first floor, this well-presented two-bedroom flat offers bright, versatile accommodation in a sought-after location close to St James Street

To the front of the property is an attractive bay-fronted living room, flooded with natural light through elegant double-glazed sash windows, creating a welcoming space to relax or entertain. The property features two bedrooms, including a generous principal bedroom with ample space for a large wardrobe, alongside a second single bedroom that would make an ideal home office or nursery.

The stylish bathroom has been finished to a high standard, featuring contemporary grey tiled flooring, classic white metro wall tiles, and a modern shower-over-bath suite.

To the rear, the well-presented L-shaped kitchen offers an excellent range of storage cupboards and generous worktop space, making it both practical and functional for everyday living.

A real added benefit is the additional loft room, providing flexible extra space that could be used as a home office, games room or simply for additional storage complete with velux windows.

- Well-Presented Two-Bedroom First-Floor Apartment
- Leasehold - 50% Share Of Freehold
- 0.4 Miles To St James Street Station
- Nearby Walthamstow Wetlands
- Exceptional Amount Of Storage
- Council Tax - B
- EPC - C
- 877 Sq Ft - 81.5 Sq M

£475,000



Markhouse Avenue

Approximate Gross Internal Area

Ground Floor = 4.5 sq m / 49 sq ft

First Floor = 54.0 sq m / 582 sq ft

Second Floor = 12.2 sq m / 132 sq ft

Total = 70.7 sq m / 763 sq ft

(Excluding Eaves Storage)

Total = 81.5 sq m / 877 sq ft

(Including Eaves Storage)

This plan is for layout guidance only. Not drawn to scale unless stated. Windows and door openings are approximate. Whilst every care is taken in the preparation of this plan, please check all dimensions, shapes and compass bearings before making any decisions reliant upon them.

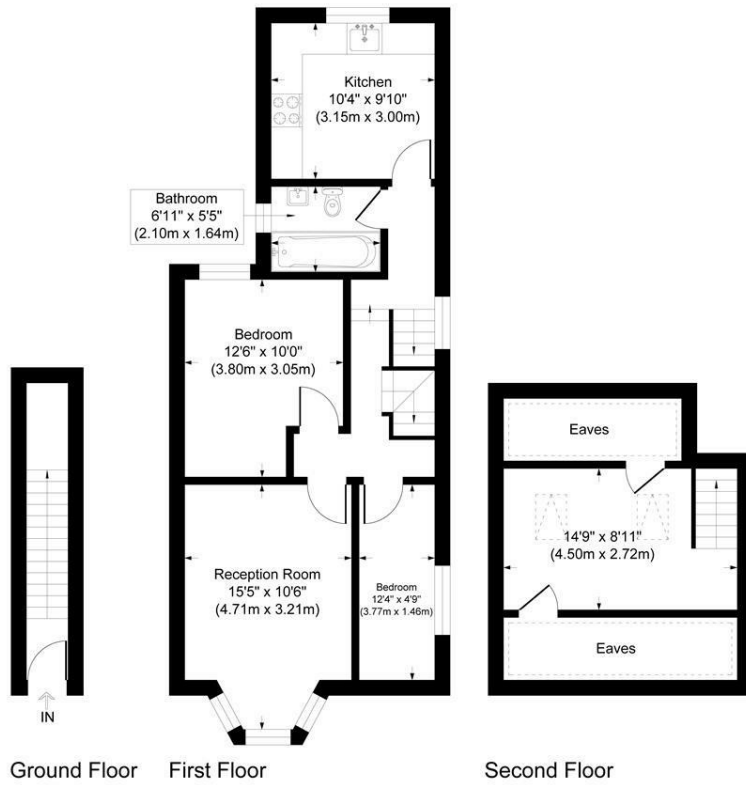

powered by:

THE360IMAGE
www.the360image.co.uk

