

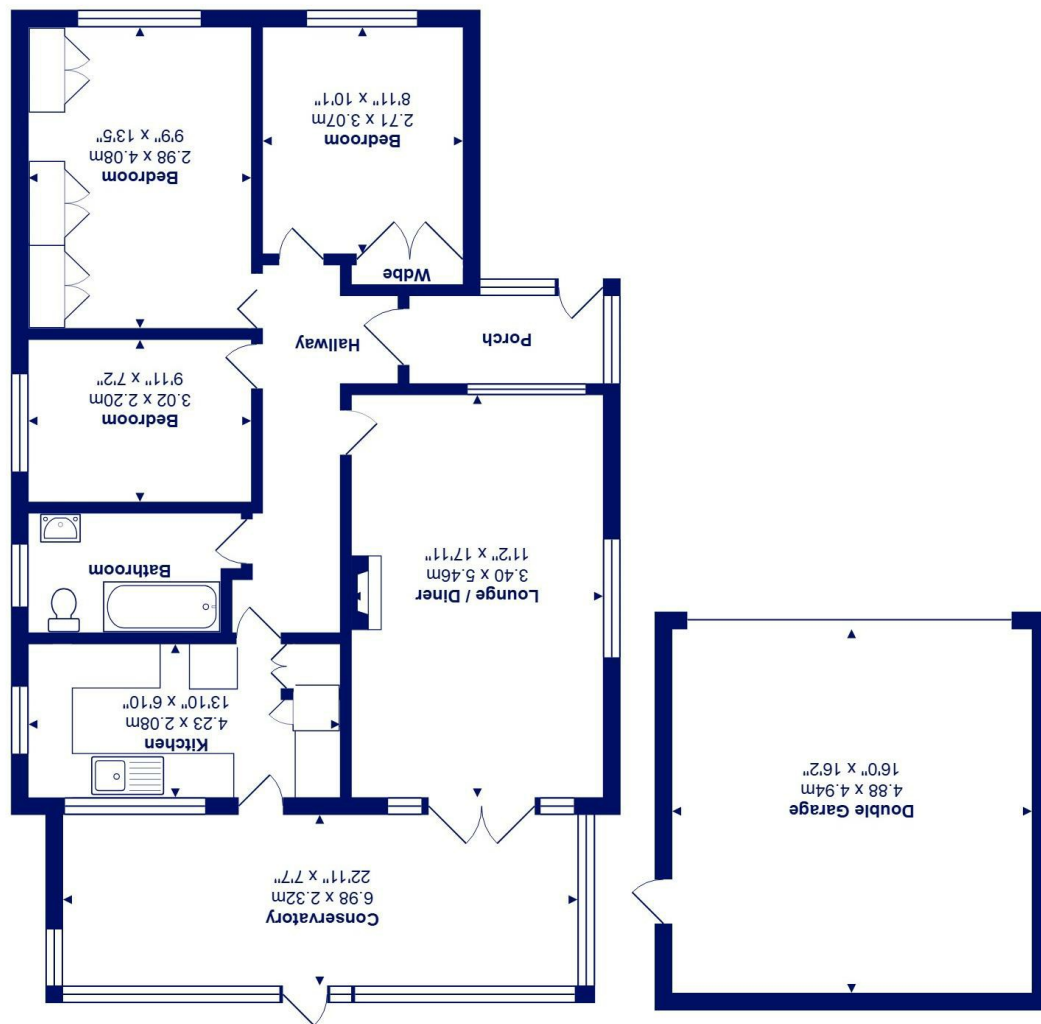

Total Area: 92.4 m² ... 994 ft² (excluding double garage)
All measurements are approximate and for display purposes only



12 Sheldrake Road, Mudeford, BH23 4BW £550,000

Mitchells
1963 — TODAY

A detached bungalow in a fantastic location close to Mundeford Quay and Avon Beach, offering about 955 sq ft of living space and now in need of complete modernisation and refurbishment. Offered for sale with no forward chain, the property could be extended/converted (stpp) like many properties in the road and has a level garden with detached double garage.

This pocket of Mundeford is incredibly popular with many of the original bungalows now extended/converted into very smart homes. The local shops, bus connections, safe bathing beaches at Avon and Friars Cliff and the four star Christchurch Harbour Hotel and Spa are all within walking distance

- Great refurbishment opportunity with lots of scope to improve
- Three bedrooms and family bathroom
- Bright and airy sitting room that leads to the conservatory extension
- Kitchen that also leads to the conservatory extension
- Carport with electric door, plus detached double garage in the rear left corner of the garden
- Plenty of off road parking
- Full updating required
- No forward chain

EPC Rating Band: E
Council Tax Band: D
Freehold

