

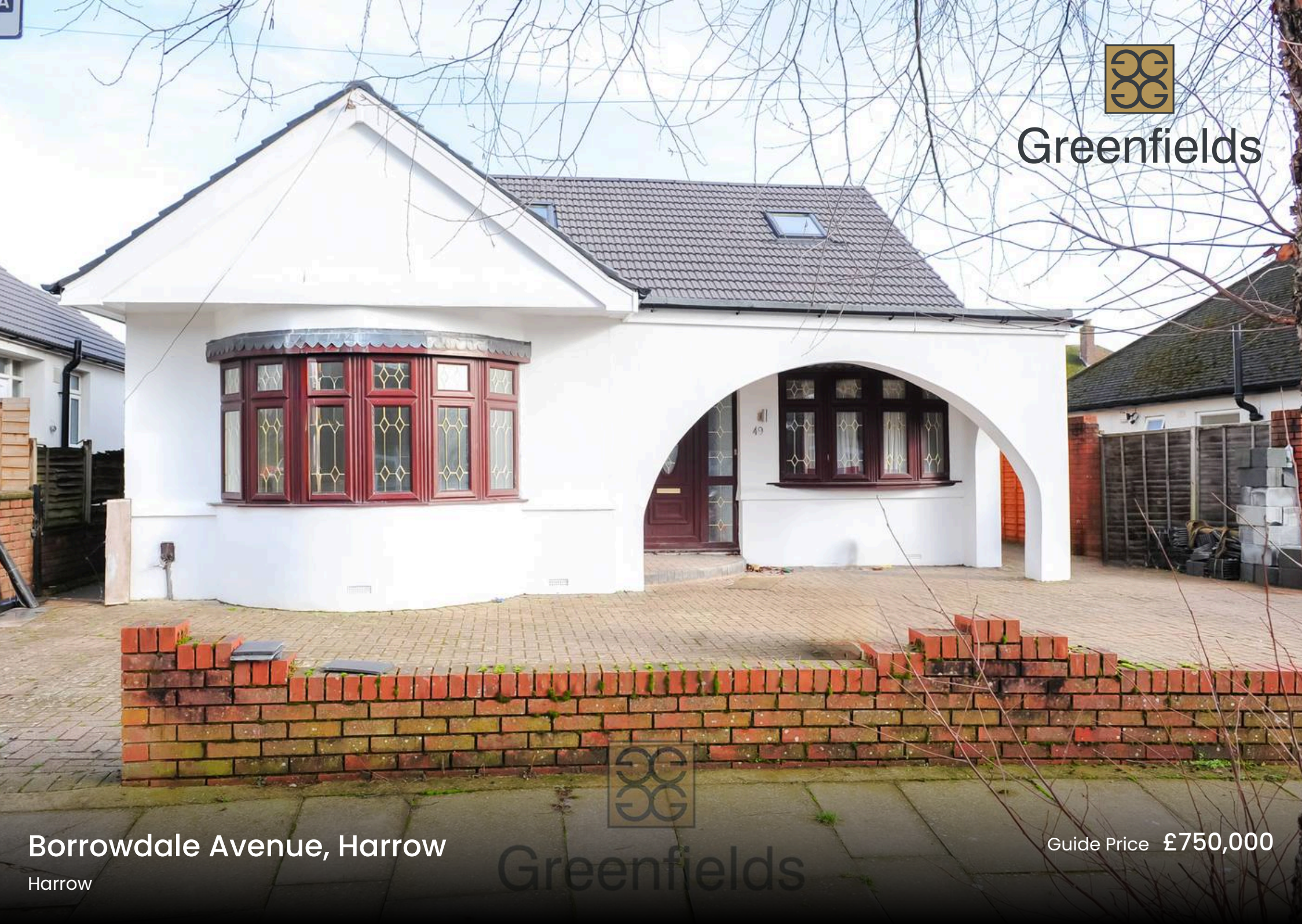

Greenfields



Borrowdale Avenue, Harrow

Harrow



Greenfields

Guide Price £750,000

Borrowdale Avenue

Harrow

Unique detached 4-bed home with open plan living, skylights, large garden, driveway, and choice of Howdens kitchen. Includes study, stylish bathrooms, and spacious indoor-outdoor layout.

Council Tax band: E

Tenure: Freehold

EPC Energy Efficiency Rating: D

EPC Environmental Impact Rating: E

- Detached chalet bungalow
- 4 / 5 bedrooms (5th bedroom can be used as a surdy)
- Spacious open plan living area
- Multiple skylights for enhanced natural light
- Modern bathrooms (including walk-in shower and bath-tub)
- Private and spacious garden
- Bay windows for character and light
- Off-road parking (large driveway)
- Large brick built outhouse (gym / den / home office)



Greenfields

GROUND FLOOR
MAIN AREA: APPROX. 109.5 SQ. METRES (1178.3 SQ. FEET)
Plus outbuildings, approx. 26.6 sq. metres (285.8 sq. feet)

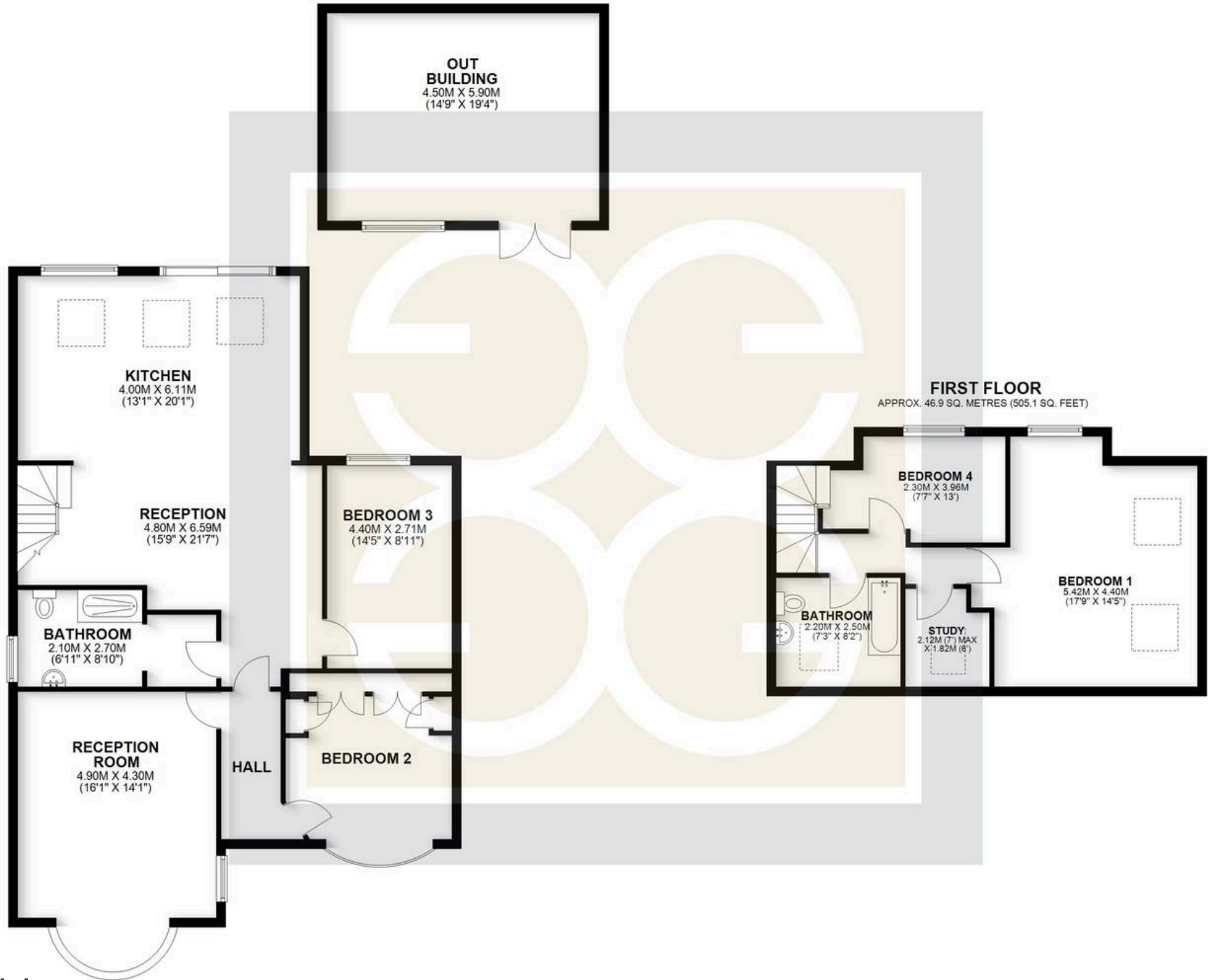

Greenfields

MAIN AREA: APPROX. 156.4 SQ. METRES (1683.3 SQ. FEET)
PLUS OUTBUILDINGS, APPROX. 26.6 SQ. METRES (285.8 SQ. FEET)



Greenfields

115 Victoria Road, Ruislip - HA4 9BN

01895 628560 • info@greenfieldsproperty.co.uk • www.greenfieldsproperty.co.uk

These particulars, whilst believed to be accurate are set out as a general outline only for guidance and do not constitute any part of an offer or contract. Intending purchasers should not rely on them as statements of representation of fact, but must satisfy themselves by inspection or otherwise as to their accuracy.